

SCALE 1:50

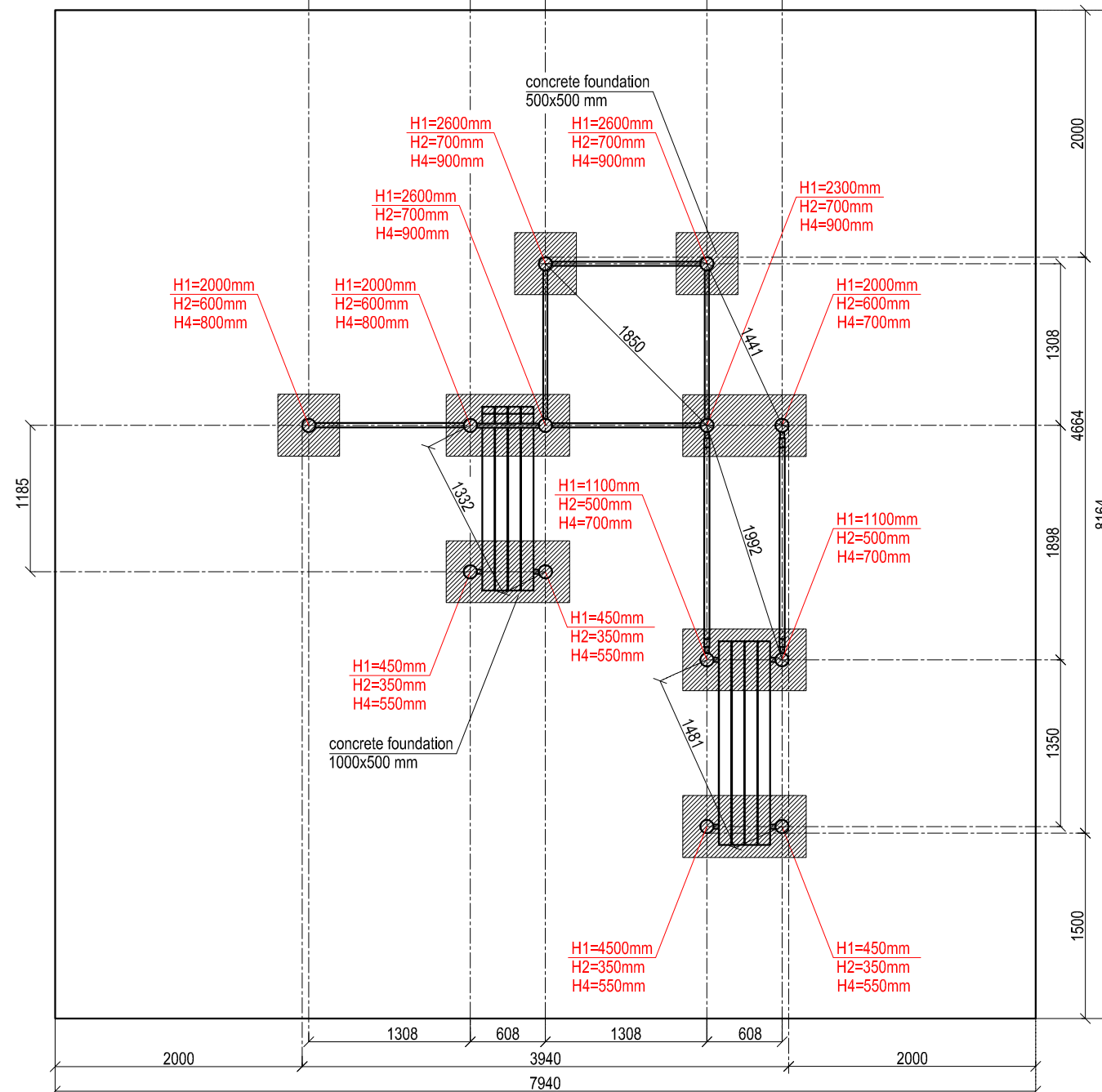
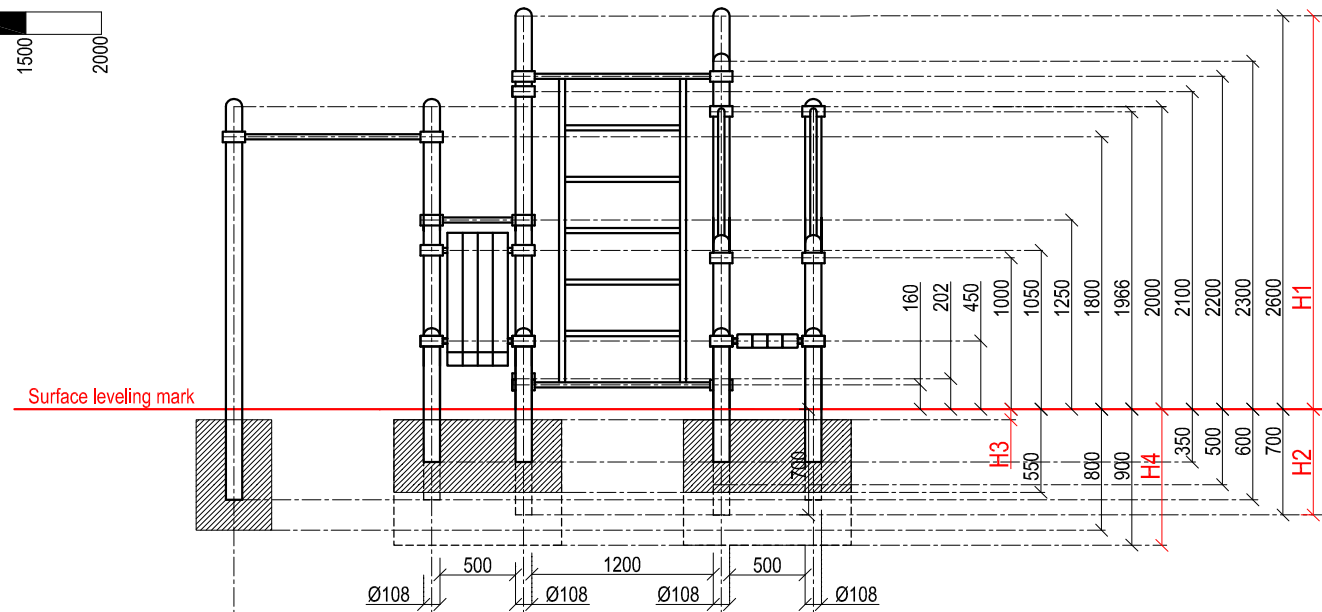
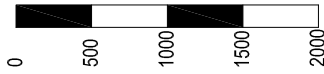

LTD "KENGURU PRO"  
 Address: Ezera street 21-28, Riga, Latvia, LV-1034  
 VAT Reg. No. 40103750152  
 Bank: A/S DNB bank, SWIFT: RIKOLV2X ,  
 Bank Account: LV65RIKO0002930161161  
 e-mail: info@kengurupro.eu  
 www.kengurupro.eu

P-018

Complex PARAKENGURU MAX



The complex consists of thirteen backup columns at the height of: 2600 mm -3 pieces, 2300 mm-1 piece, 2000 mm- 3 pieces, 1100 mm- 2 piece, 450 mm -4 pieces. The complex includes swedish wall, four pull-up bars, inclined parallel bars with bench, climb-down bars and a bench into angle. Inclined parallel bar height difference- 966mm, length 1790mm, diameter 42mm. Swedish wall section length 2067mm, width 1200mm, bar diameter- 34mm. Climb-down bar length 1932mm, diameter 34mm. Crossbar length: 5 pieces- 500mm, 4 pieces- 1200mm, diameter 34mm. All bars and sections are fixed to backup columns by means of collars. Weight - 459.90 kg.

**Installation instructions:**

- Choose a suitable underground for the unit (see page 2, table 2)!
- Prepare the construction pit with a drilling machine or other devices.
- Before pouring the concrete all structures elements must be leveled and fixed.
- Complex elements must be fixed and bolted together with metal clamps.
- Ready-made C25 concrete should be used.
- Crossbars installation height can be changed according to customer's wishes.
- Approximately 0,15m<sup>3</sup> concrete is needed for each spot foundation.
- Under the structures we recommend to install absorbing rubber cover.

The size of the hole for the foundation is depending on the consistency of the ground. The dimensions mentioned above are applicable for normal conditions with firm ground. If the ground is extremely soft, a much bigger foundation is needed. Use only appropriate material and follow the installation instructions closely!!

Foundation plan and area of movement of the P-018 Complex PARAKENGURU MAX				Technical information	
Foundation when using Shock absorbing underground (synthetic – rubber granulates)		Beveling of foundation when using loose filling material		width: 3940 mm	
<b>H3</b>		<b>H3</b>		height: 2650 mm	
40 mm	> 1.2.....1.4 m	20 cm	< 1.0 m	length: 4664 mm	
50 mm	> 1.5.....1.7 m	30 cm	< 2.0 m	largest part: 3350 mm	
60 mm	> 1.8.....2.0 m	40 cm	< 3.0 m	weight: 459,90 kg	
70 mm	> 2.1.....2.5 m			floor space required: 7940 x 8164 mm	
				pipe measurements: diameter: wall thickness:	
				108 mm 3.2 mm	
				42.4 mm 3.2 mm	
				33.7 mm 3.2 mm	
				metal parts: steel, galvanized, powder coated RAL 7016 (anthracite grey)	
				metal clamps: aluminium, powder coated RAL 2004 (pure orange)	
				bolts for metal clamps: stainless steel, Pin Hex Button Head Security Screws M10	
				wooden beam measurements: Height, width Length	
				92 x 100 1650	
				wooden parts: Sikkens Cetol painted, RAL 1006 (maize yellow)	
				max. free fall height: < 2600 mm possible underground see DIN 79000:2012-05 Tab.2 or installation instructions	
				user age: children under 14 years only under surveillance of parents	
				maximum user weight: 130 kg	
				certificates:	

