

SCALE 1:40

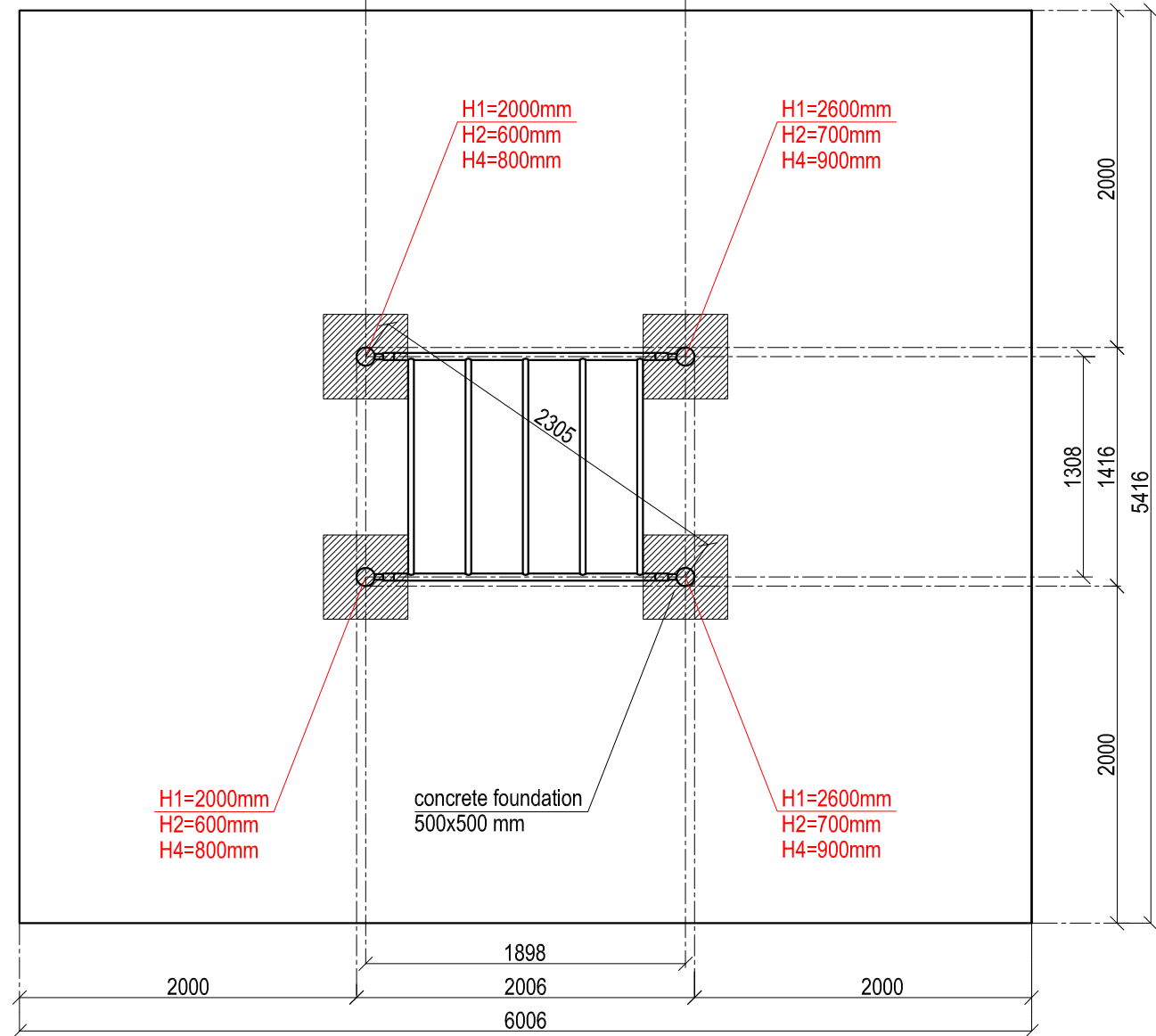
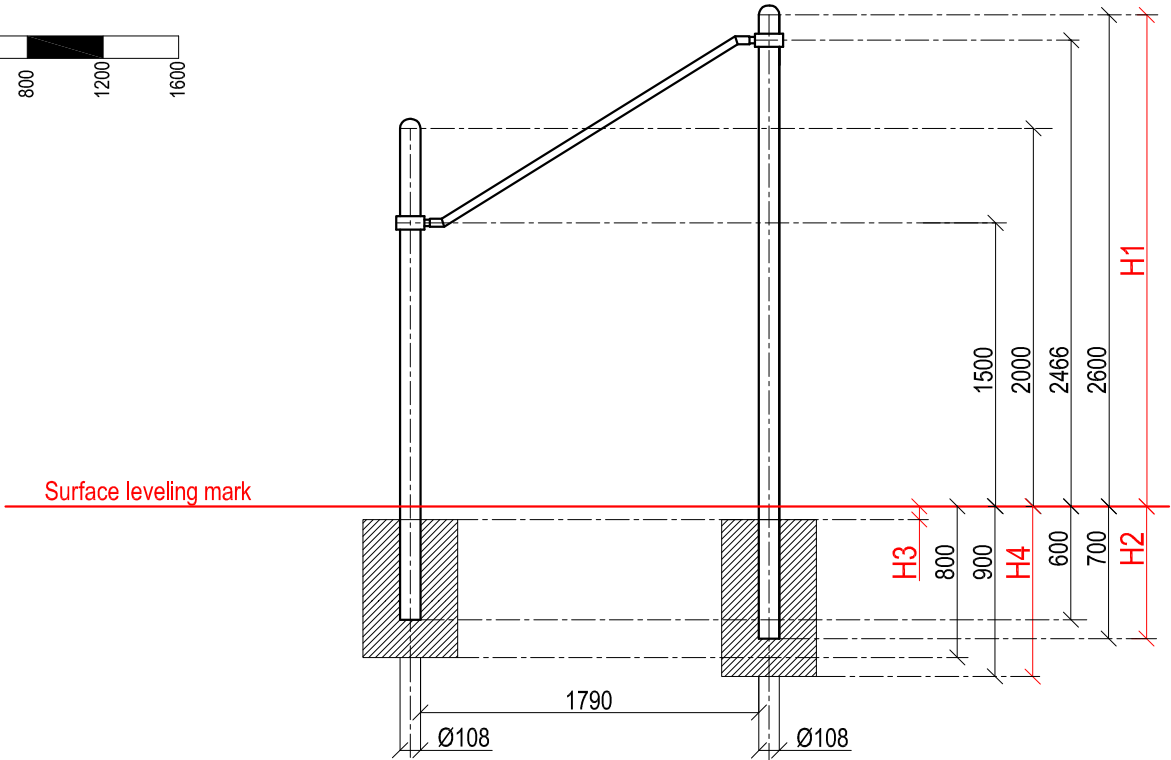

LTD "KENGURU PRO"
Address: Ezera street 21-28, Riga, Latvia, LV-1034
VAT Reg. No. 40103750152
Bank: A/S DNB bank, SWIFT: RIKOLV2X ,
Bank Account: LV65RIKO0002930161161
e-mail: info@kengurupro.eu
www.kengurupro.eu

P-007

PARAKENGURU Inclined Monkey bar



The complex consists of four backup columns at the height of: 2600 mm -2 pieces, 2000 mm- 2 pieces. Monkey bar is fixed to backup columns at the height 1500mm and 2466mm by means of collars. The distance between bars is 400 mm, width 1308 mm, height difference 966,3mm. Total lenght of inclined monkey bar- 1790mm. Weight - 153.60 kg.

Installation instructions:

- Choose a suitable underground for the unit **(see page 2, table 2)!**
- Prepare the construction pit with a drilling machine or other devices.
- Before pouring the concrete all structures elements must be leveled and fixed.
- Complex elements must be fixed and bolted together with metal clamps.
- Ready-made C25 concrete should be used.
- Crossbars installation height can be changed according to customer's wishes.
- Approximately 0,15m³ concrete is needed for each spot foundation.
- Under the structures we recommend to install absorbing rubber cover.

The size of the hole for the foundation is depending on the consistency of the ground. The dimensions mentioned above are applicable for normal conditions with firm ground. If the ground is extremely soft, a much bigger foundation is needed. Use only appropriate material and follow the installation instructions closely!!!

Foundation plan and area of movement of the P-007 PARAKENGURU Inclined Monkey bar				Technical information	
Foundation when using Shock absorbing underground (syntethic – rubber granulates)		Beveling of foundation when using loose filling material		width:	1416 mm
				height:	2650 mm
				length:	2006 mm
				largest part:	3350 mm
				weight:	153,60 kg
				floor space required	5416 x 6006 mm
				pipe measurements:	diameter: wall thickness:
					108 mm 3.2 mm
					42.4 mm 3.2 mm
					33.7 mm 3.2 mm
				metal parts:	steel, galvanized, powder coated RAL 7016 (anthracite grey)
				metal clamps:	aluminium, powder coated, RAL 2004 (pure orange)
				bolts for metal clamps	stainless steel, Pin Hex Button Head Security Screws M10
				max. free fall height:	< 2500 mm possible underground see DIN 79000:2012-05 Tab.2 or installation instructions
				user age:	children under 14 years only under surveillance of parents
				maximum user weight:	130 kg
				certificates:	