



14+



5



2,05m



1 = 2,1m 2 = 1,4m 3 = 3m

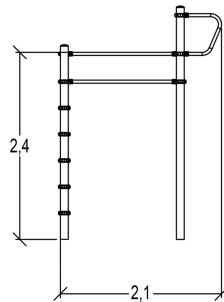
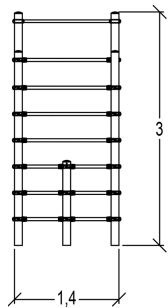
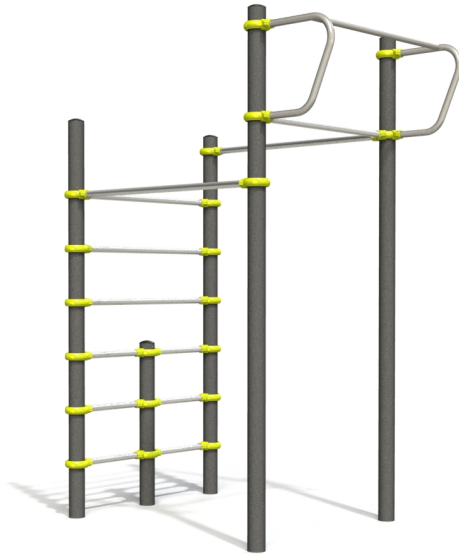

Play value : 4

hanging



x3

climbing



x1

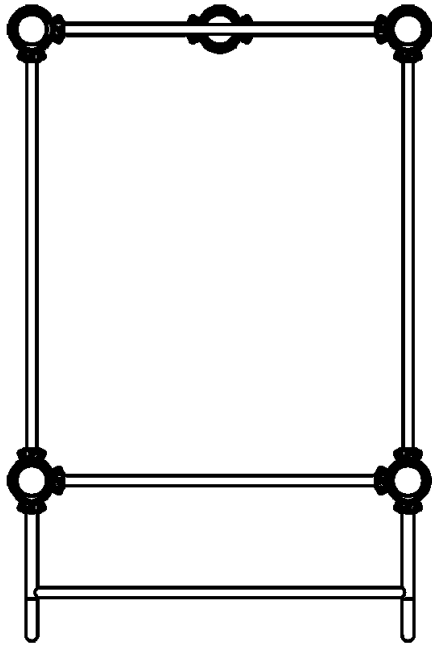

- ① Barre fixe 1250
- ② Barre fixe 1500
- ③ Espalier
- ④ Barre de suspension

Installation of equipment

Impact area =

- Impact area
- Free space

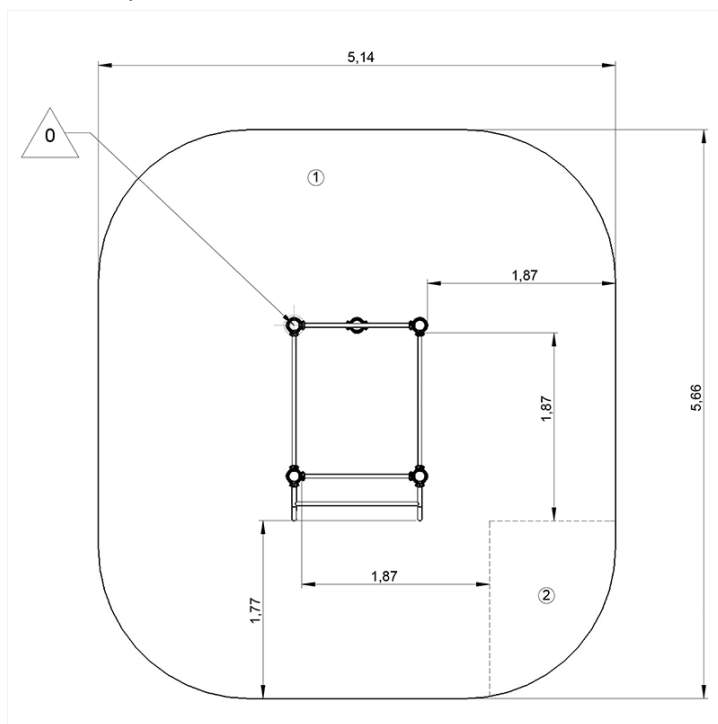

1	1,9m	2m ²
2	2,05m	25,5m ²



2



02h30



0.5m³



27.5m²



173kg



28kg

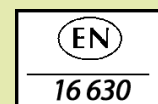

Proludic

0000-00-00