



J2594M

Proludic





N°		
1	0.7 m	26 m²

— Zone d'impact
Impact area
Area de impacto
Fallraum
Valzone



Point de référence
Setting out point
Punto de referencia
Bezugspunkt
Referentiepunt

--- Espace libre
Free space
Espacio libre
Freiraum
Vrije ruimte

EN 1176-1 : 2017
EN 1176-5 : 2008

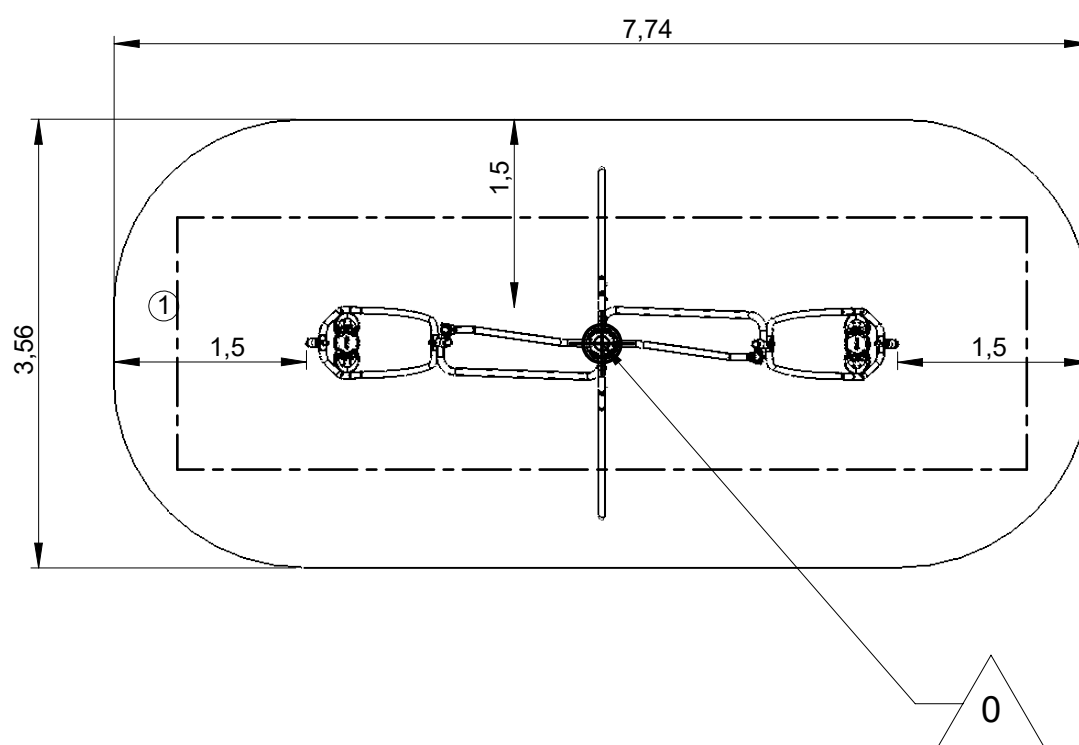

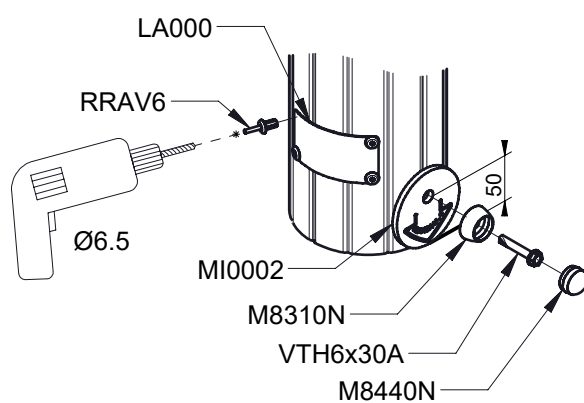
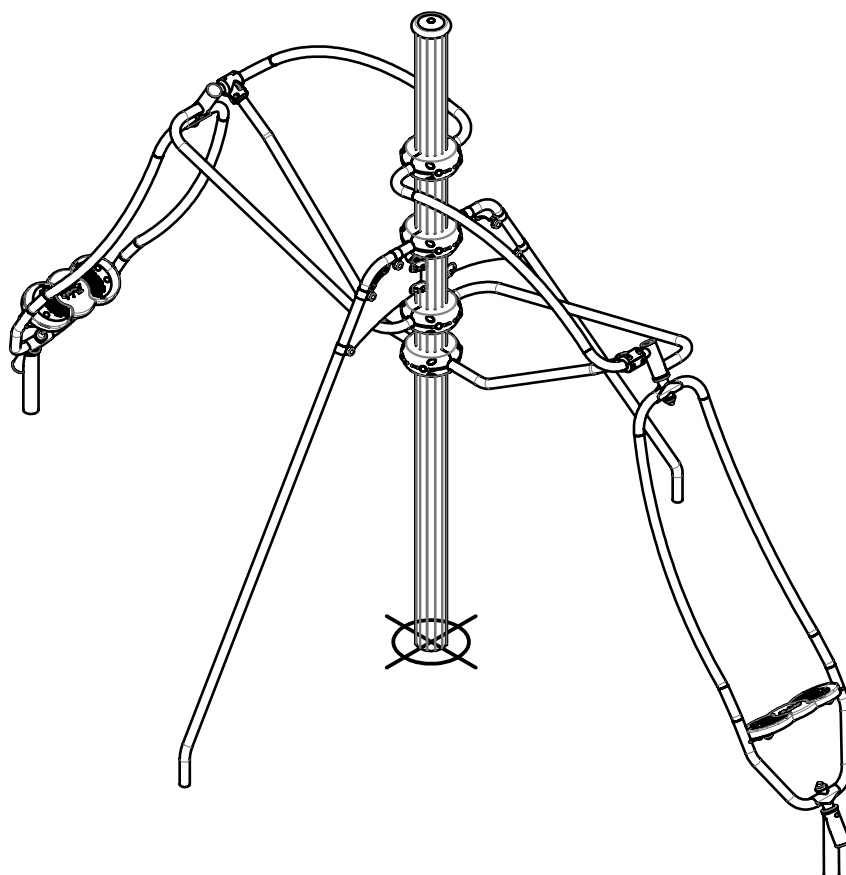

— Zone d'impact
Impact area
Area de impacto
Fallraum
Valzone

26 m²

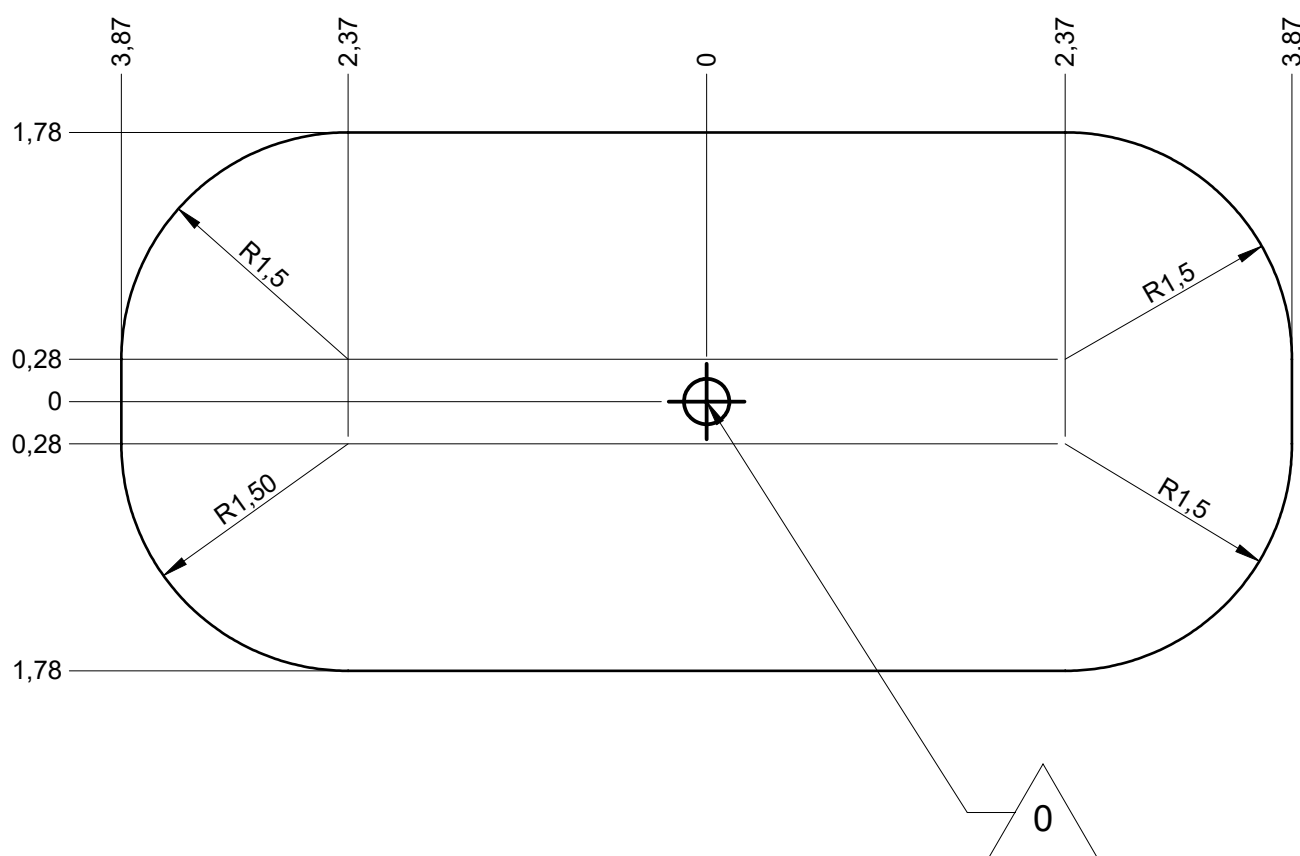

— Sol souple
Wetpour
Caucho continuo
Synthetischer Fallschutz
Gietvloer

26 m²

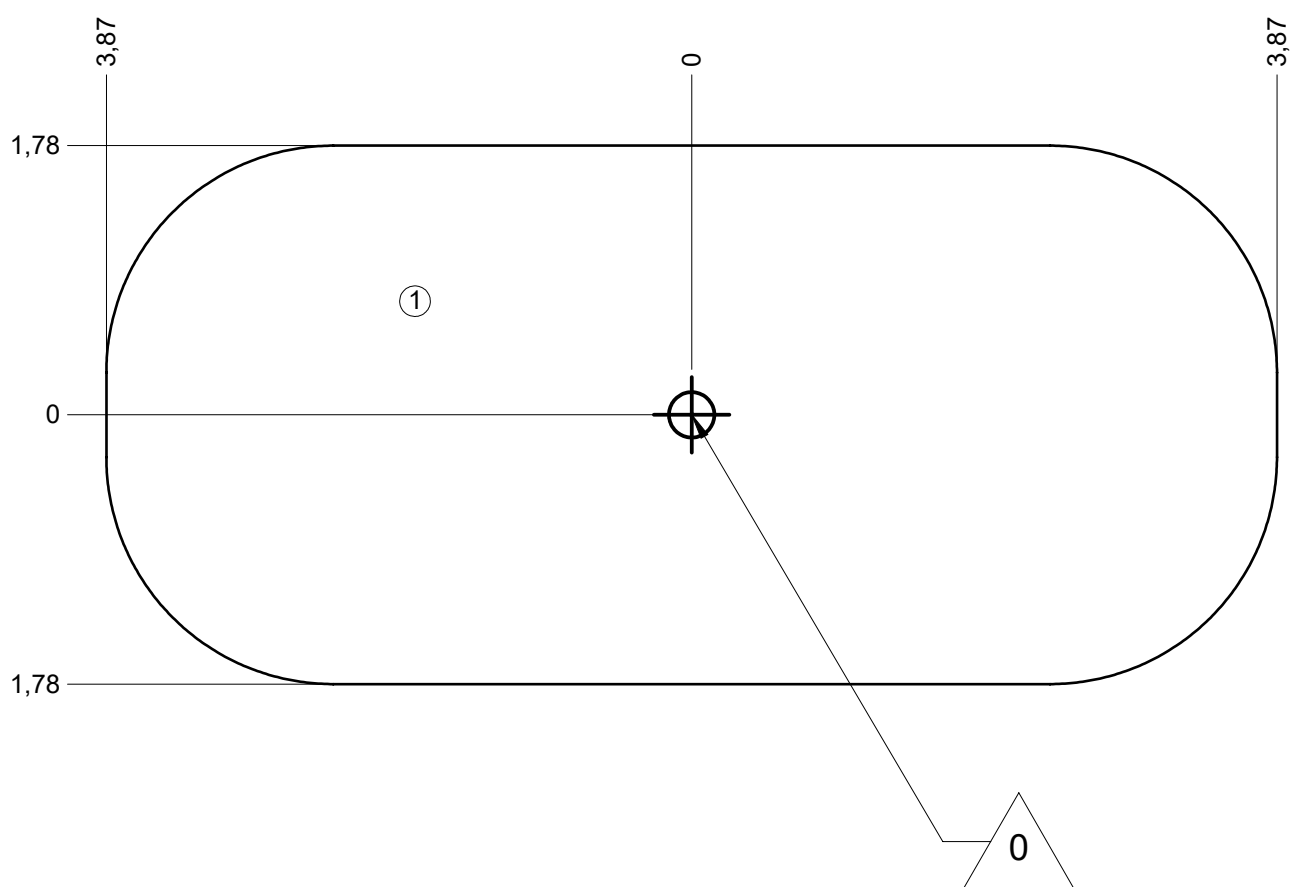

— Dalle béton
Concrete pad
Solera de hormigon
Beton Bodenplatte
Betonnen bodemplaat

23 m
28 m²

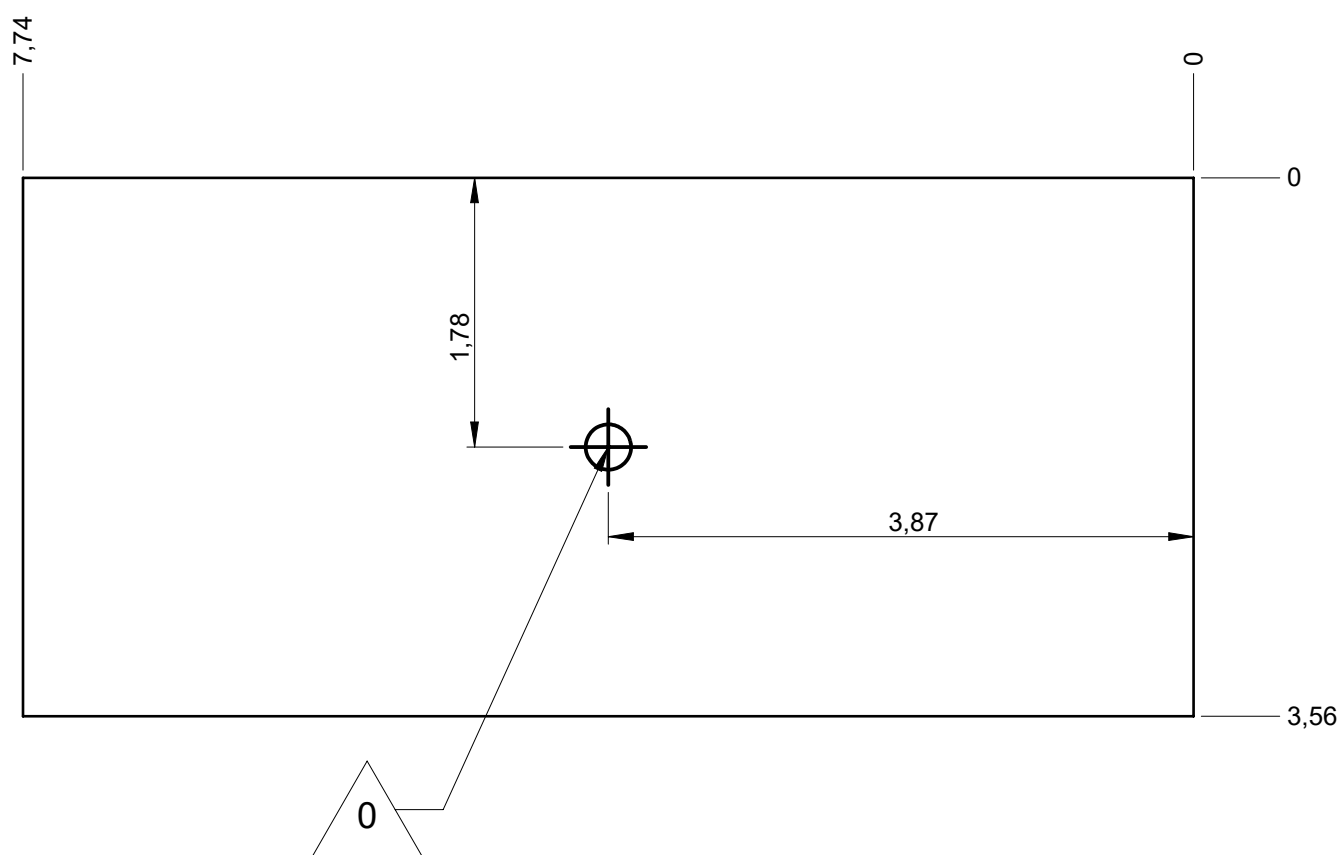

— Sol fluent
 Loos partucule material
 Arenero
 Loses Bodenmaterial
 Los bodemmateriaal

25 m
30 m²

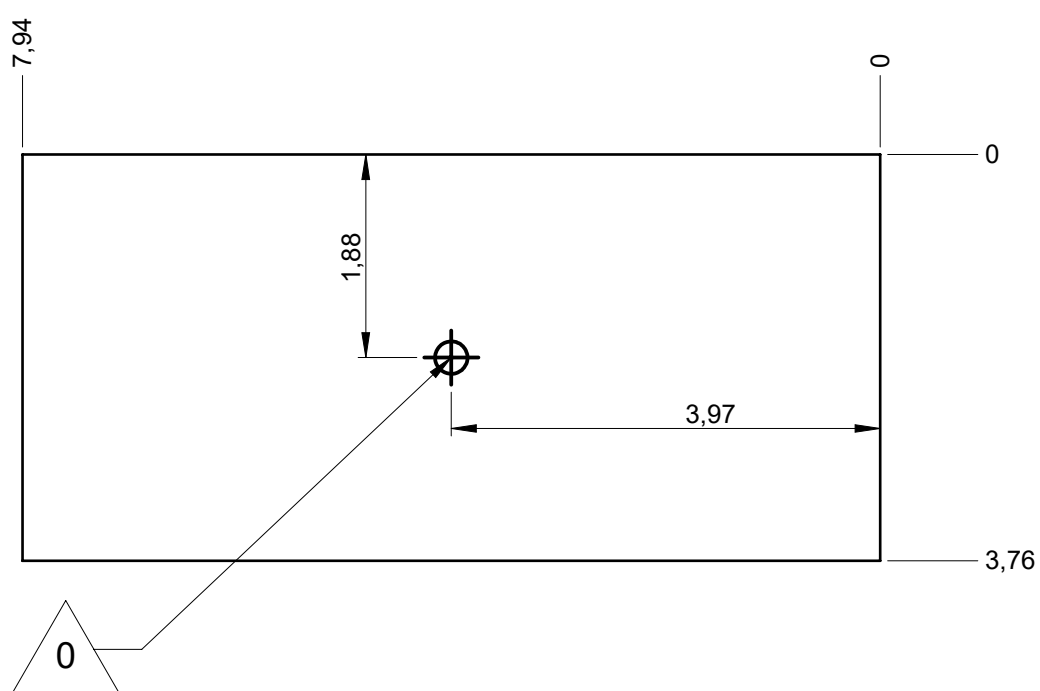

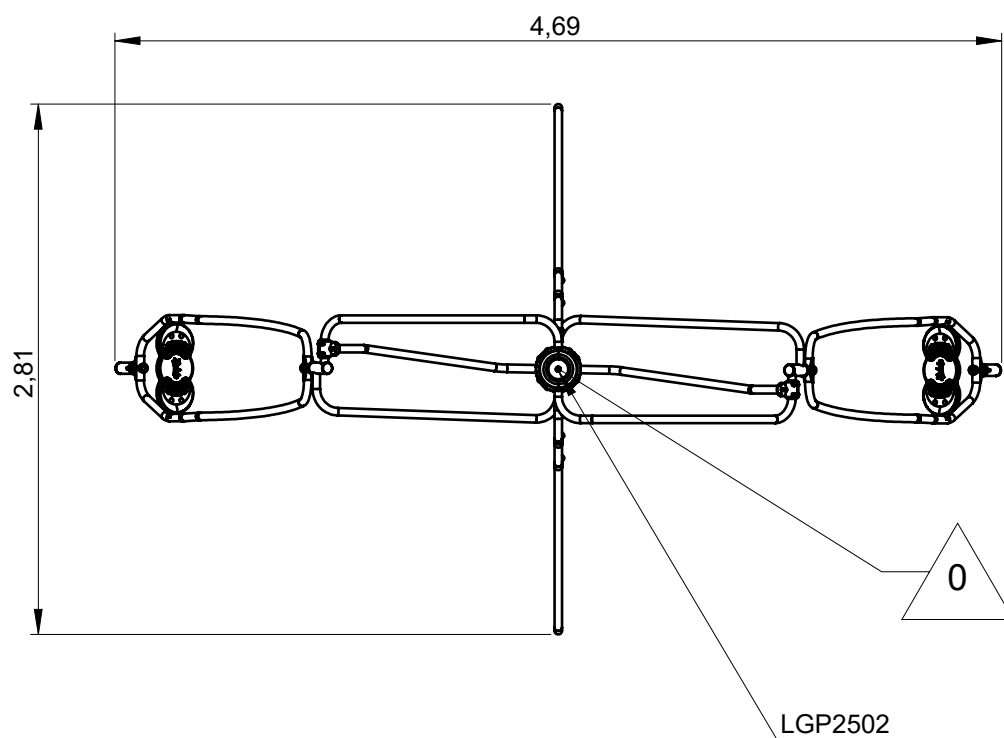
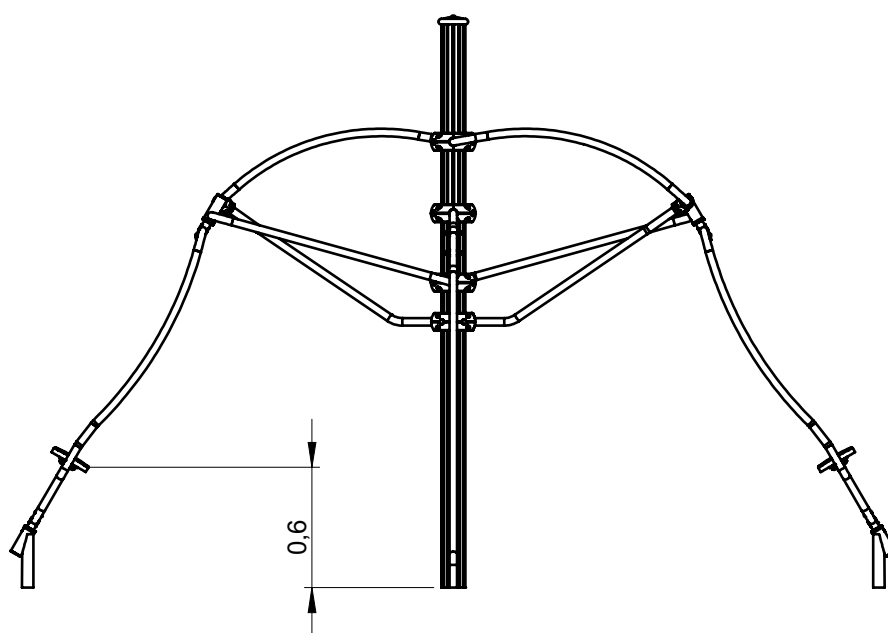

J2594A-M

Proludic

Implantation
Footing plan
Implantación
Fundamentplan
Funderingstekening

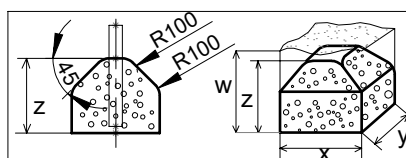
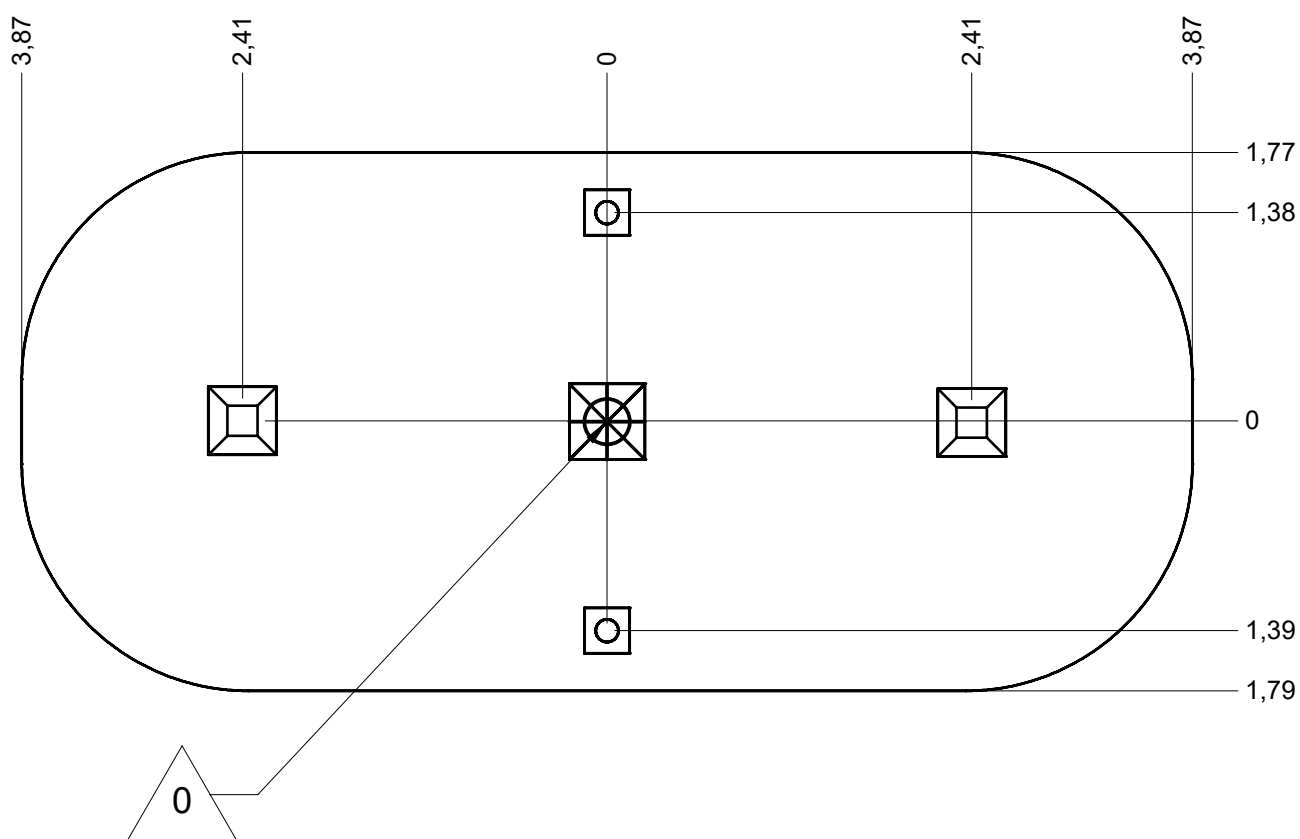

	x	y	z	w
	0.3	0.3	0.3	0.6
	0.5	0.5	0.4	0.8
	0.45	0.45	0.4	0.8

1x
LGP2502

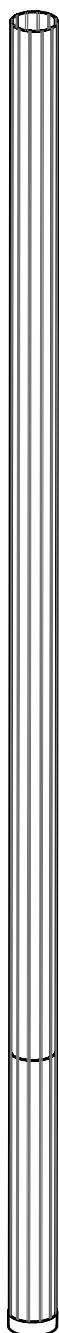

2x
LI2592

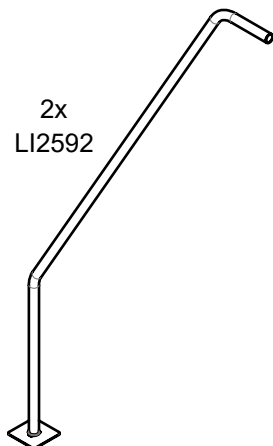

2x
U2548

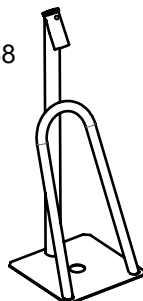

2x
LI25189

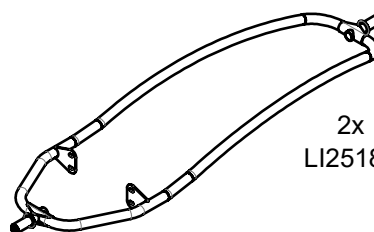

2x
U2560

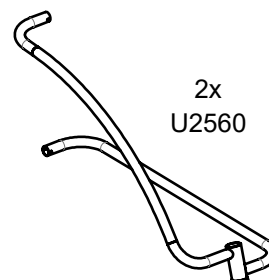

2x
ET2542VX

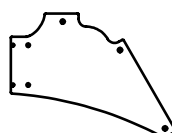

2x
LI25198

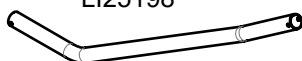

2x
M2504



8x
MI2501VX



2x
PI57039



4x
M60

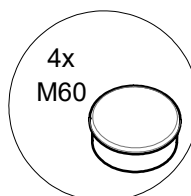

4x
LI25191

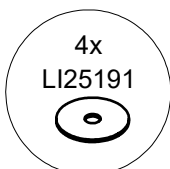

6x
LI4505

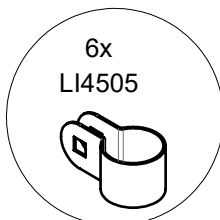

4x
MI2502VX



ET2542VX	2
LG4412	1
LGP2502	1
LI2592	2
LI4505	6
LI25189	2
LI25191	4
LI25198	2
M60	4
M2504	2
M10310N	14
M10440N	31
MI025VX	1
MI2501VX	8
MI2502VX	4
MI2508	32
MI2510N	4
MI4501N	8
MI4503	16
PI57039	2
U2548	2
U2560	2
VBTR8X25	4
VBTR10X90	16
VCBHCM6x25I	8
VCBHCM10x30I	6
VEBM6	8
VECM8	4
VECM10	16
VEFM10	18
VFHCM6x40	1
VGC8x55I	8
VTH6x30A	10
VTH6x60 AUTO	16
VTRCC10x40	8

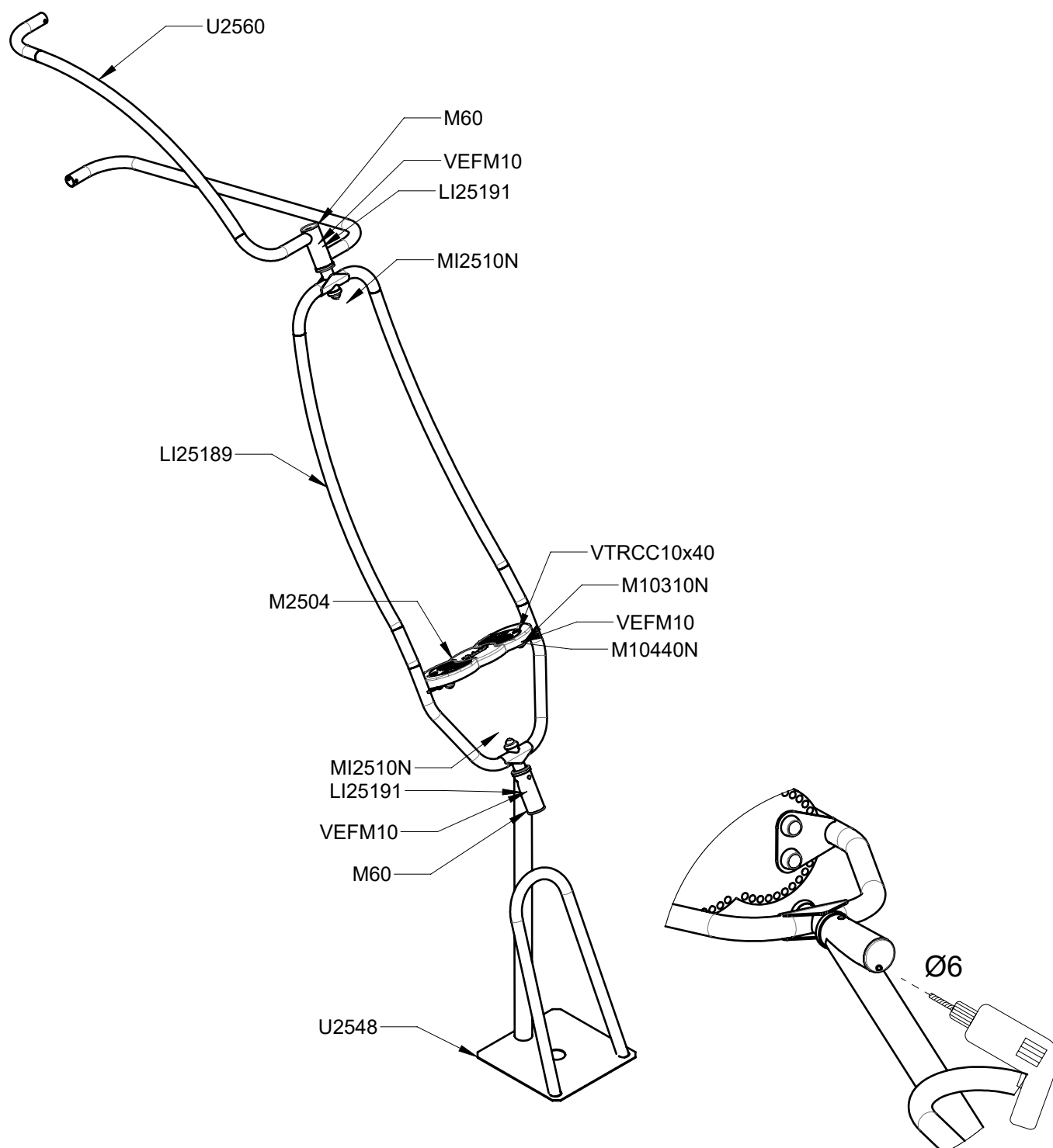

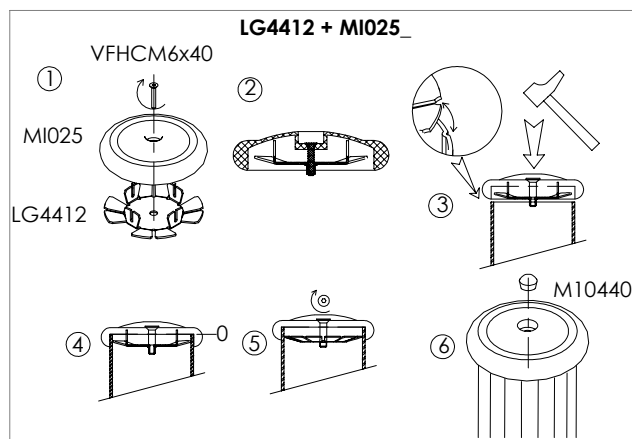

MI025VX

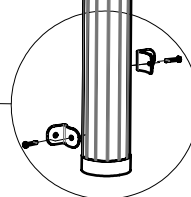
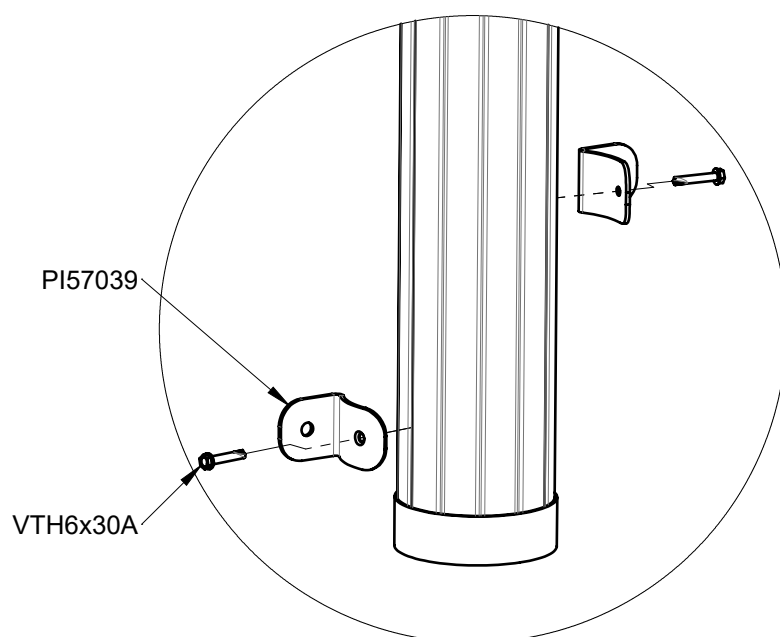
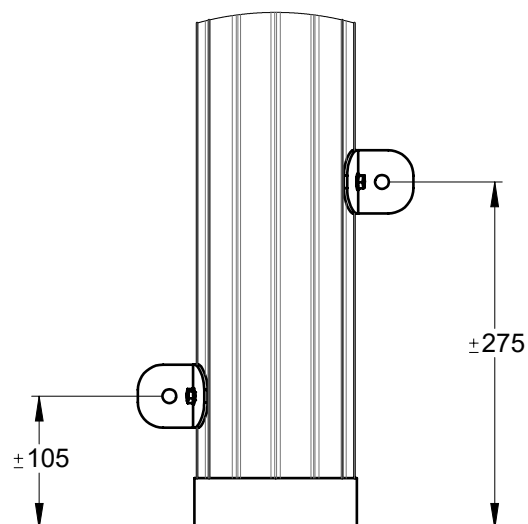

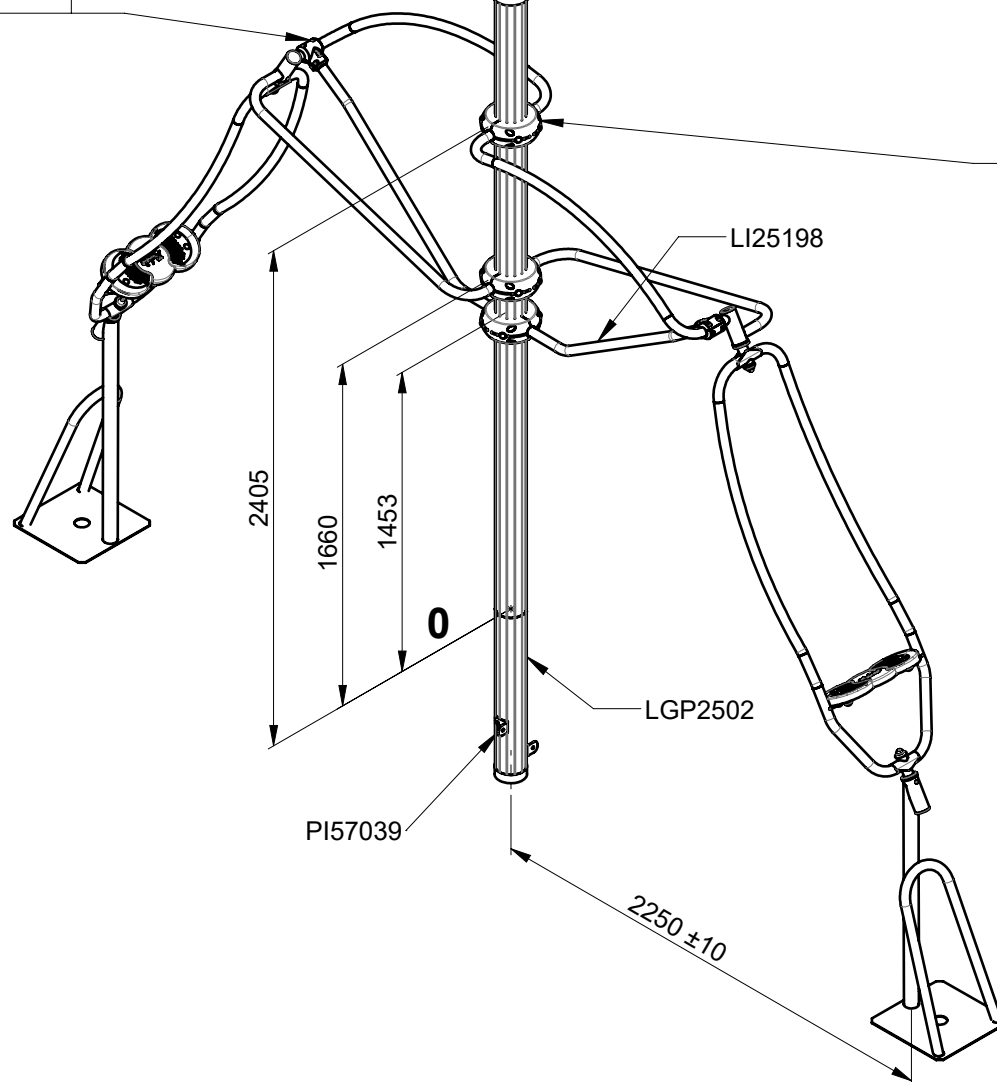
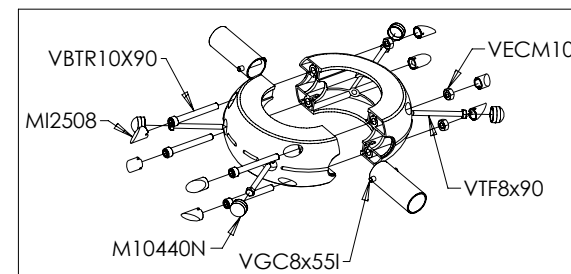
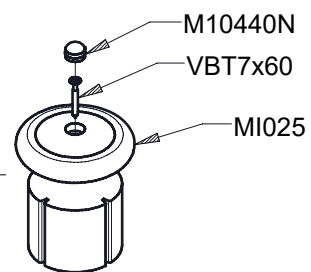
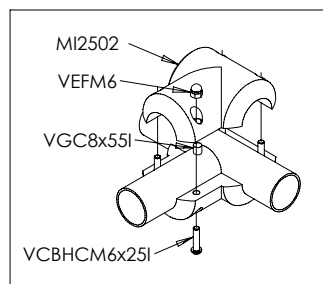

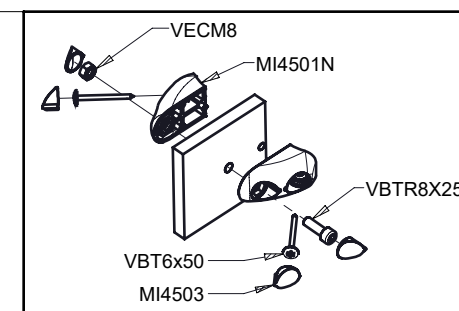
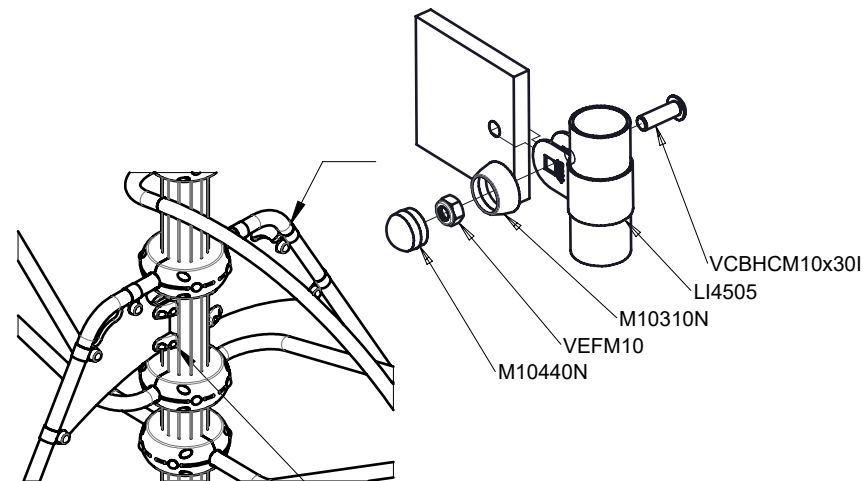
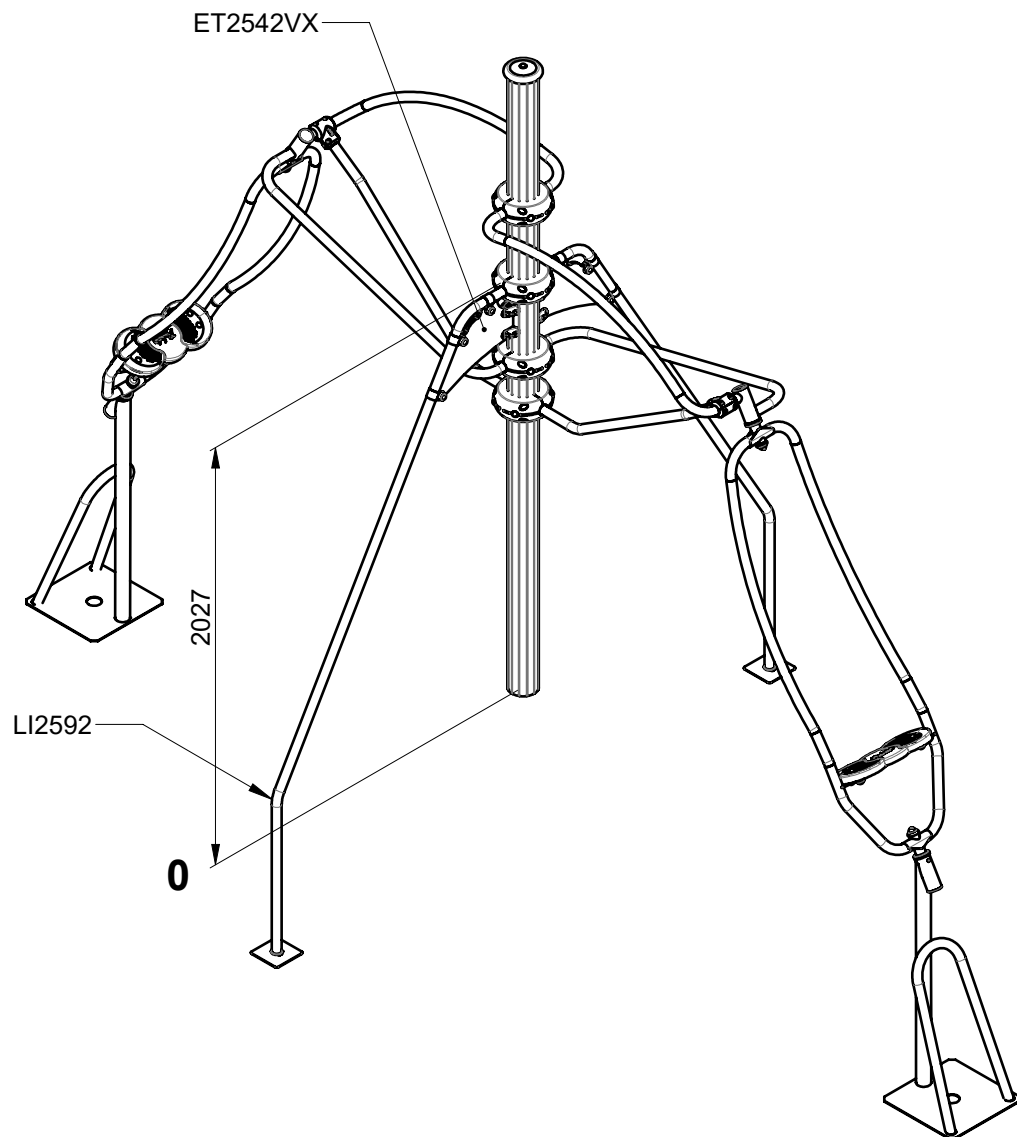

1

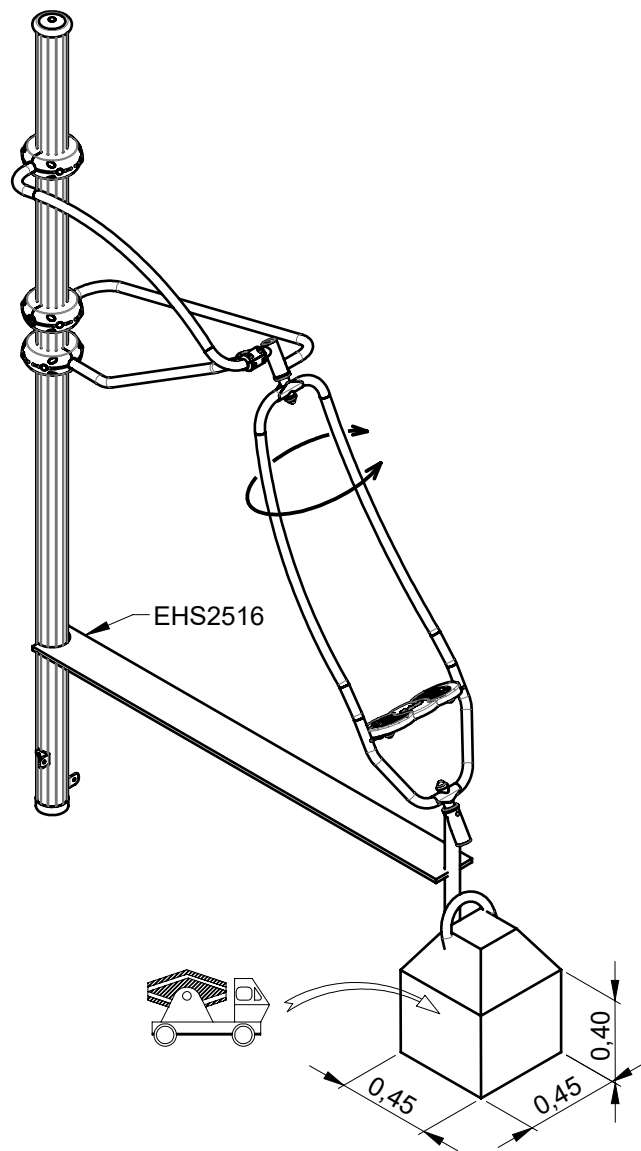

2

