

Toddler's suite

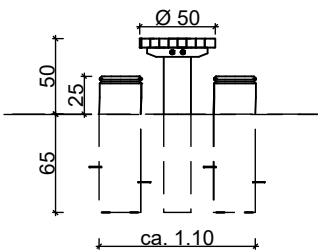

view



topview

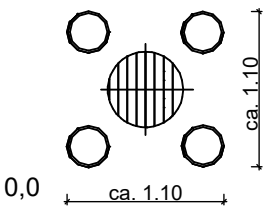

foundation plan
check measurements
on building site

because of crooked trees different
measures are possible

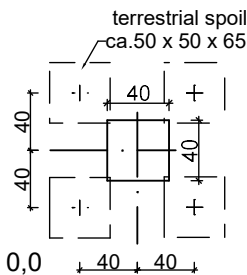

foundation detail
without scale

minimum soil class III; check compression
or make foundation bigger

stool

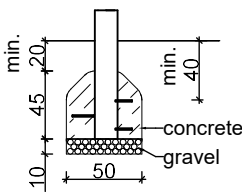

perhaps a foundation
is necessary for
unconsolidated underground

pole

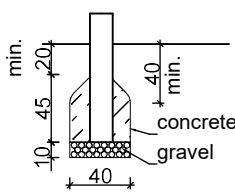

project:	Toddler's suite	scale:	A4; 1:50	page:	1/1
address:		date:	21.03.2017		
editor:	V.Liehr				
article ID:	9.1.35.1				
project ID:	assembly				



Master enterprise of woodcarving handicrafts
© SIK-Holzgestaltungs GmbH

ASSEMBLING INSTRUCTION

9.1.35.1 Toddler's Suite

Scope of delivery

Amount	Denomination	Measure
1	table	40 kg
4	sitting posts at 40 kg	160 kg
Sum	approx.	200 kg

All weights are approximate. The heaviest component is highlighted in bold.

Tools

- spade, shovel, tape measure, spirit level, hammer
- socket wrench 17 / 19 mm, screwdriver with insert Torx Bit (TX 10-30)
- 2 persons (2 installers at 4 h)
- possibly approx. concrete 0.5 m³ C 20/25 (depending on type on soil)

Assembling

- Determine the foundation positions according to plan. **Measures are to be checked by the client/customer, because of the natural growth forms of the wood.** To determine the position of the foundations, use the attaching parts.
- Digging holes depending on the section for the play unit and depending on the ground conditions a drainage layer, for example gravel layer 10 cm in order to prevent stagnant moisture.
- In the foundation area of the post is to follow the included steel reinforcement.
- **Installation depths (cut) on the stand post are to consider.**
- Lift the table and sitting posts one after another into the prepared holes, to adjust by means of spirit level and make them solid.

Attention: if not adequately secured play towers or attachment parts may **be tipping!**

- Manufacturing foundations according to drawing.
- After 3-5 days of curing time, tightening all screw joints which fill game surface again and clear the game surface for playing.
- Transportation braces and installation damage are to be removed after installation on site, grind and paint damaged areas.
- **Notice:** concrete needs about 28 days in order completely to harden.

Security guidelines

During assembly and transport on site, play towers and/or attachment parts must always be adequately secured, either through technology or through attached transportation bracing.

Required safety areas/ falling space around equipment are indicated on the installation drawings.

Playground equipment with a potential height of fall of more than 600 mm and/or a forced movement require an impact attenuating/ shock-absorbing surface in the whole impact area below them according to the **EN 1176-1:2008 4.2.8.5.2, and EN 1177**. (Non-shock-absorbing undergrounds are for example without limitation: bricks, stones, concrete, bitumen and wood.)

Preventive maintenance instructions

An operational check of the equipment must be carried out 2 weeks after installation. Here the main attention should be paid to tight screw joints and stability. In general the equipment should be checked on a regular basis. A visual routine inspection should be carried out on a weekly basis. An operative inspection should be performed every 1-3 months and the general or main inspection has to happen on an annual basis. We recommend to check stability of posts once a year and to expose foundations, let them dry and to repaint them also below ground level above the foundation with a solvent free glaze. **(Further information concerning maintenance can be found in our Checklist for Maintenance/ Inspection, in our General Maintenance Notes and also in our catalogues, as well as on our website www.sik-holz.de/en)**