

JPS16-S-M

ProLudic

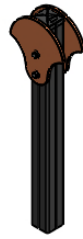

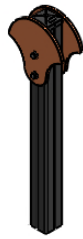
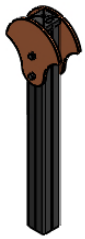
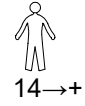

ProLudic

N°		
1	1 m	27.5 m²

— Zone d'impact
Impact area
Area de impacto
Fallraum
Valzone



Point de référence
Setting out point
Punto de referencia
Bezugspunkt
Referentiepunt

- - - Espace libre
Free space
Espacio libre
Freiraum
Vrije ruimte

EN16630 : 2015

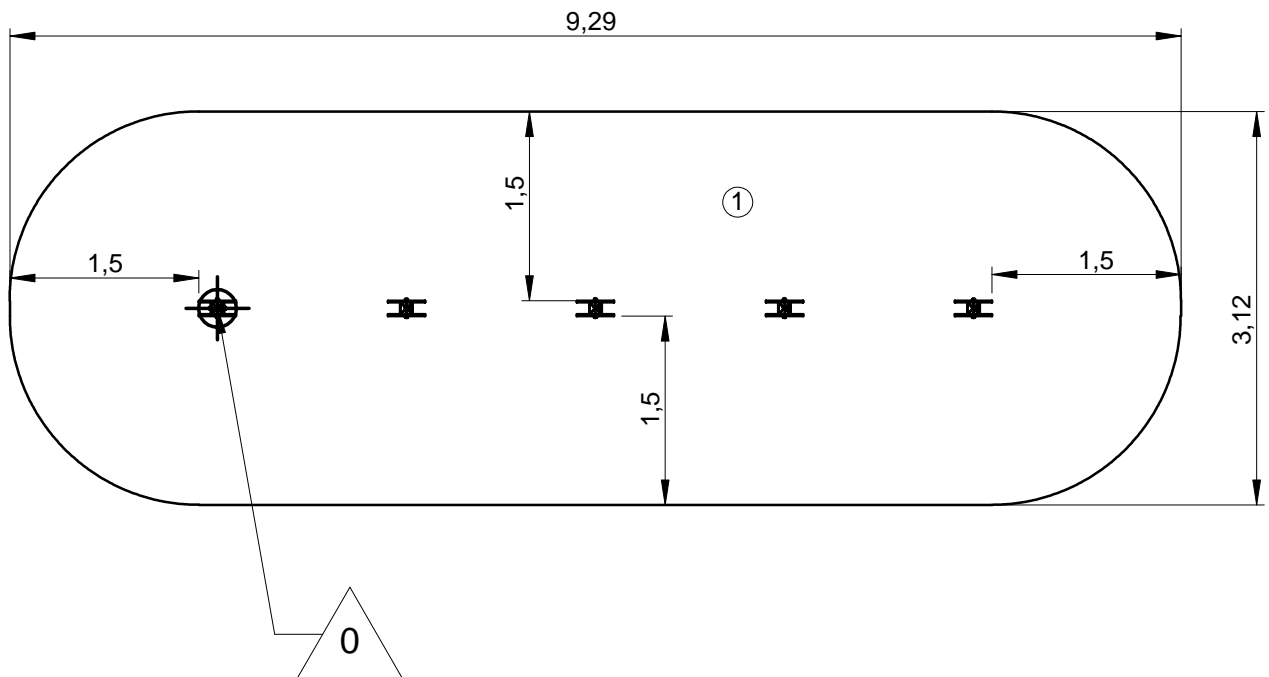

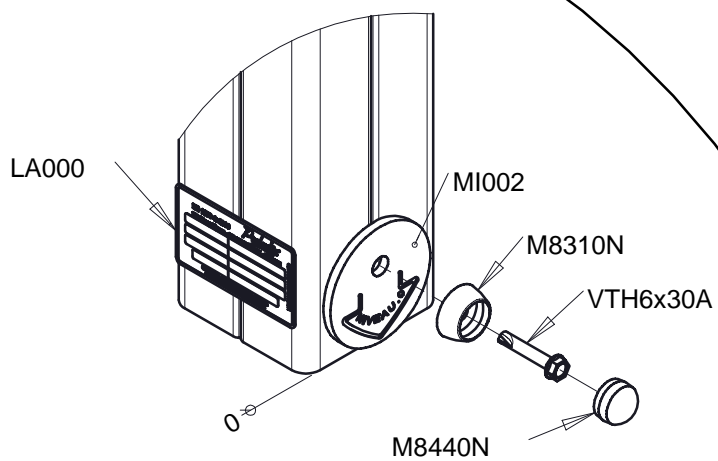
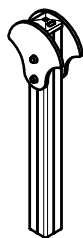

— Zone d'impact
Impact area
Area de impacto
Fallraum
Valzone

27.5 m²

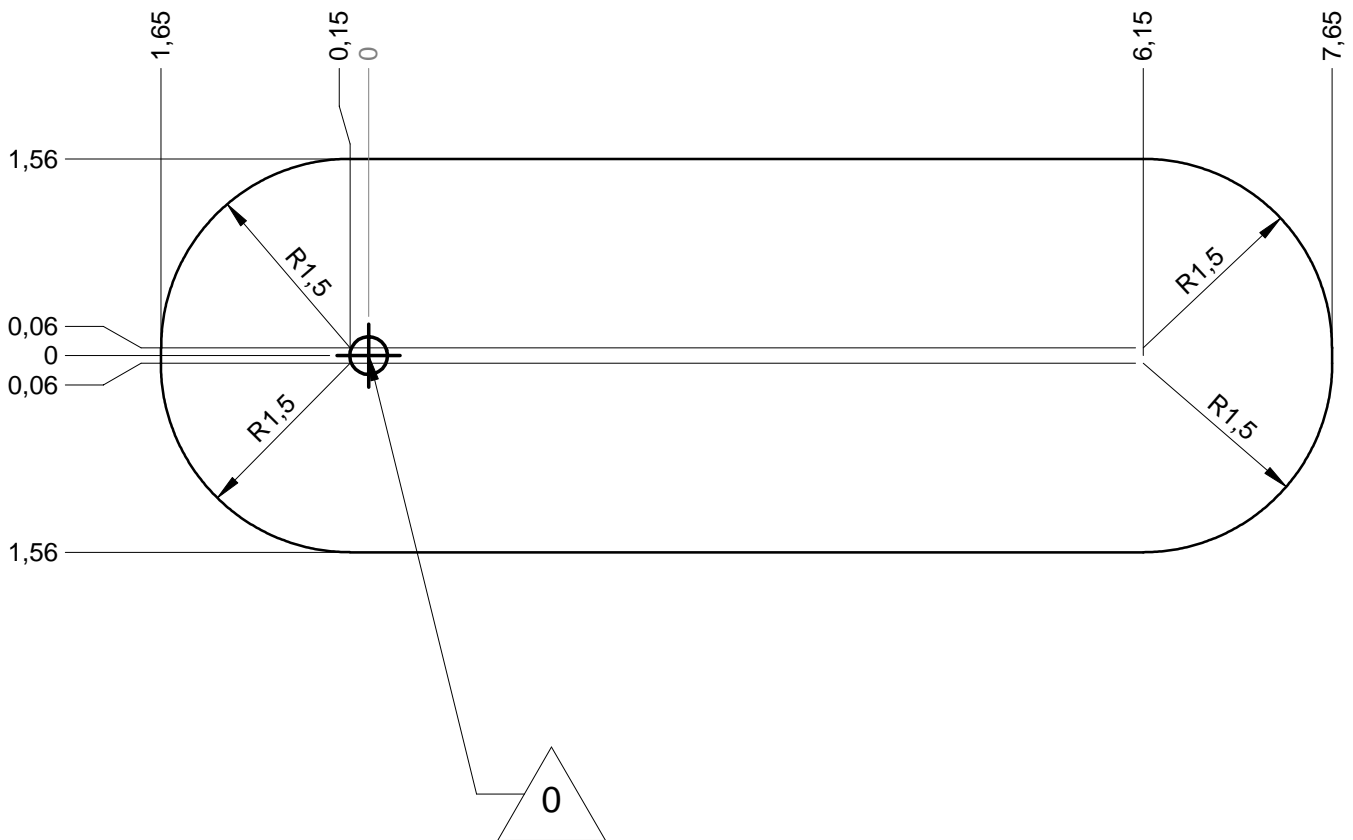

— Sol souple
Wetpour
Caucho continuo
Synthetischer fallschutz
Gietvloer

27.5 m²

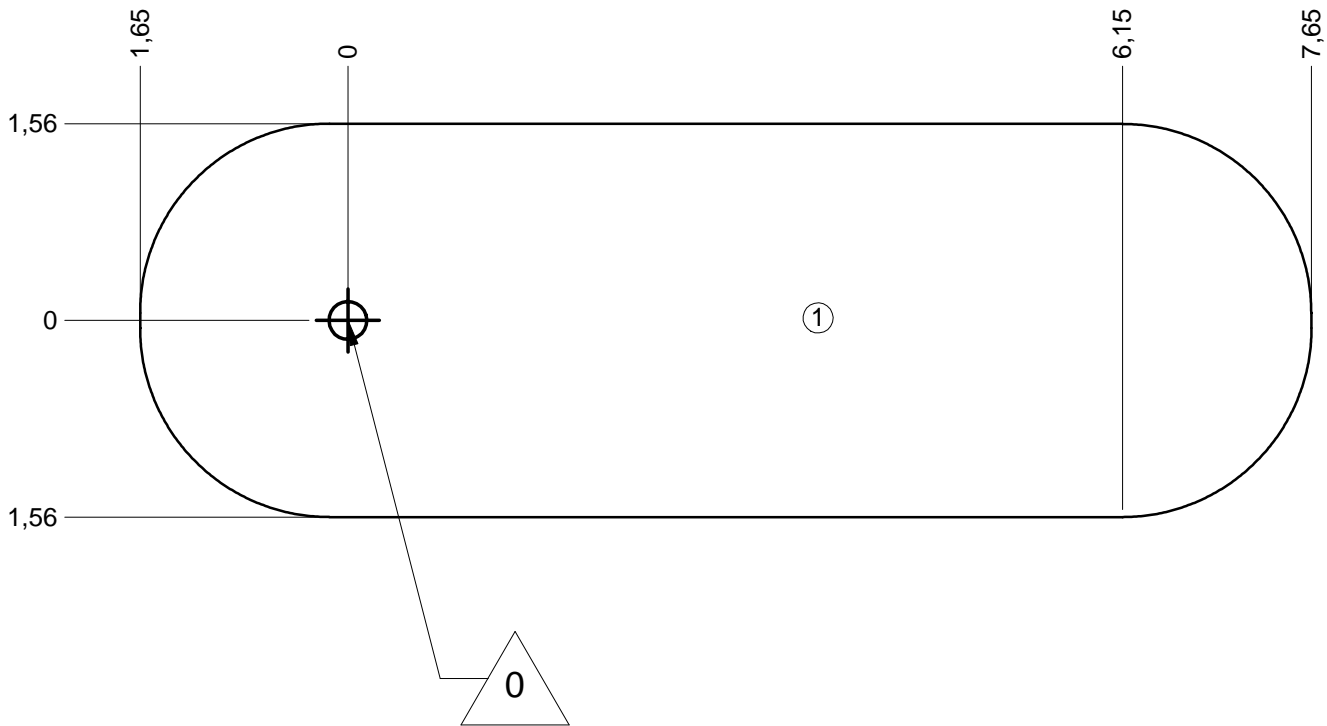

— Dalle béton
Concrete pad
Solera de hormigon
Beton bodenplatte
Betonnen bodemplaat

25 m
29 m²

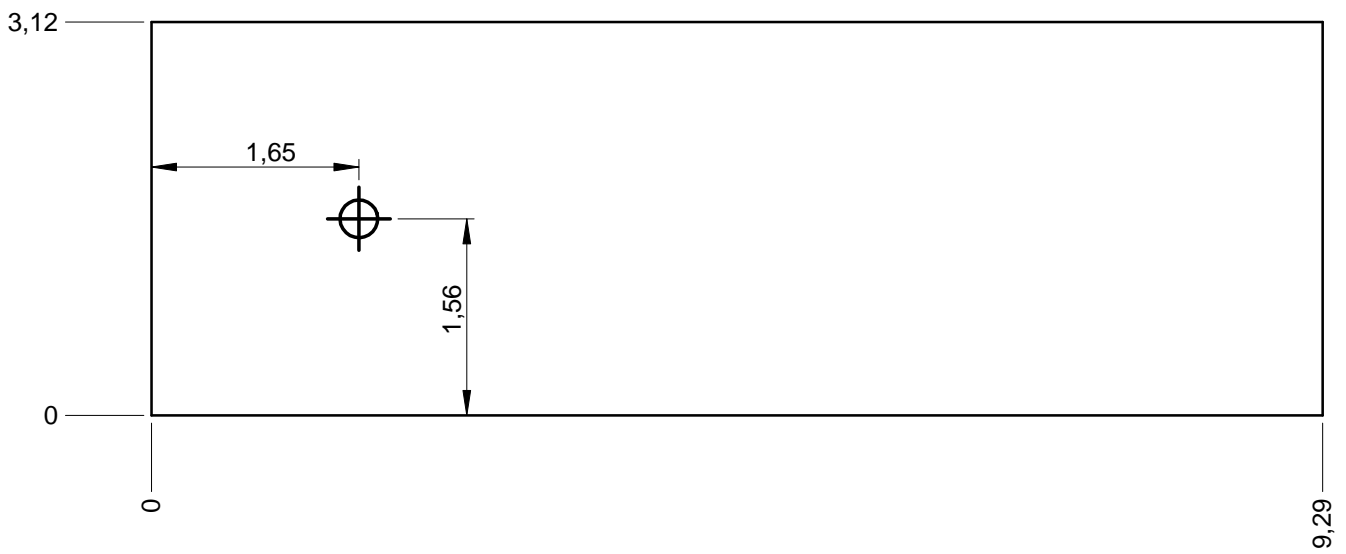



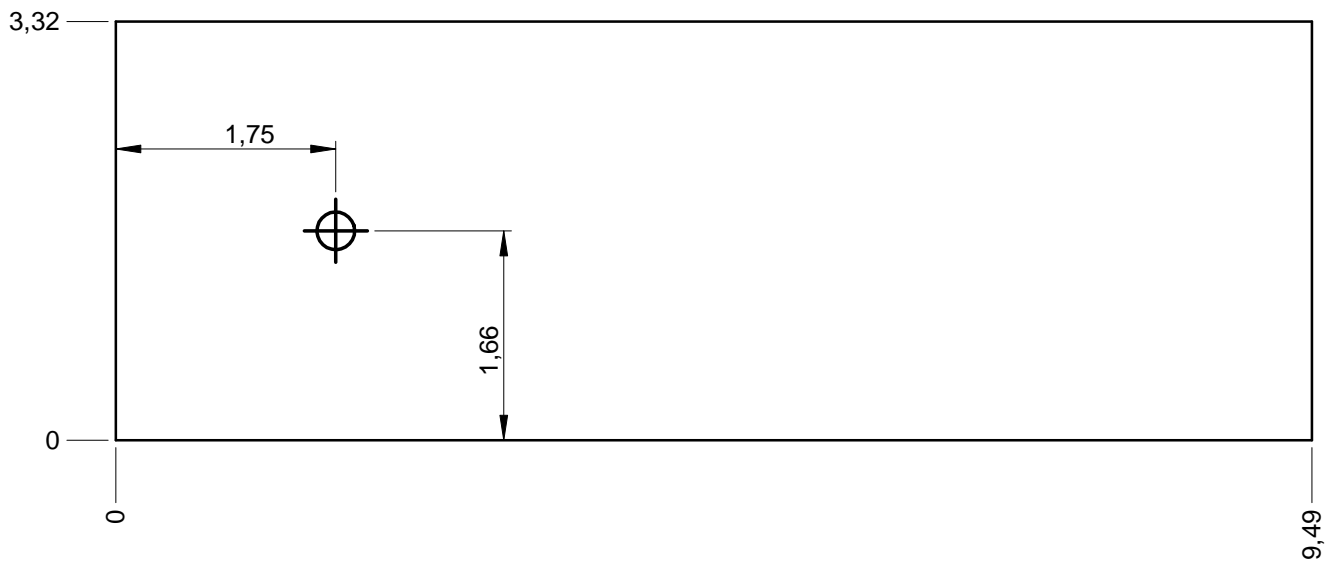

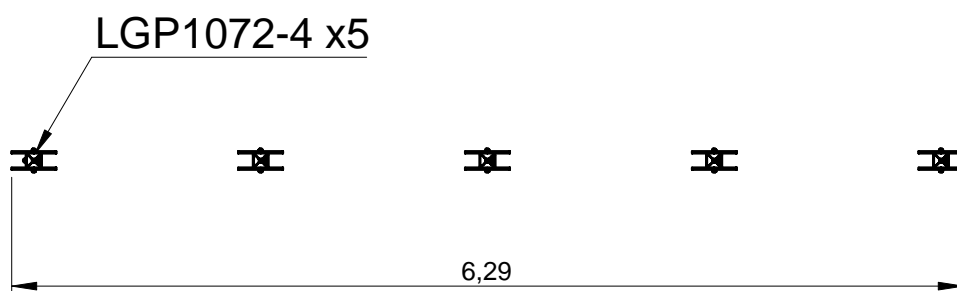
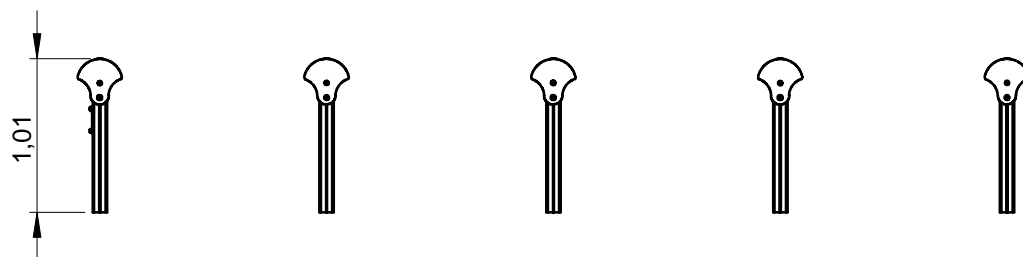
— Sol fluent
Loos partucule material **27 m**
Arenero
Loses Bodenmaterial **32 m²**
Los bodemateriaal



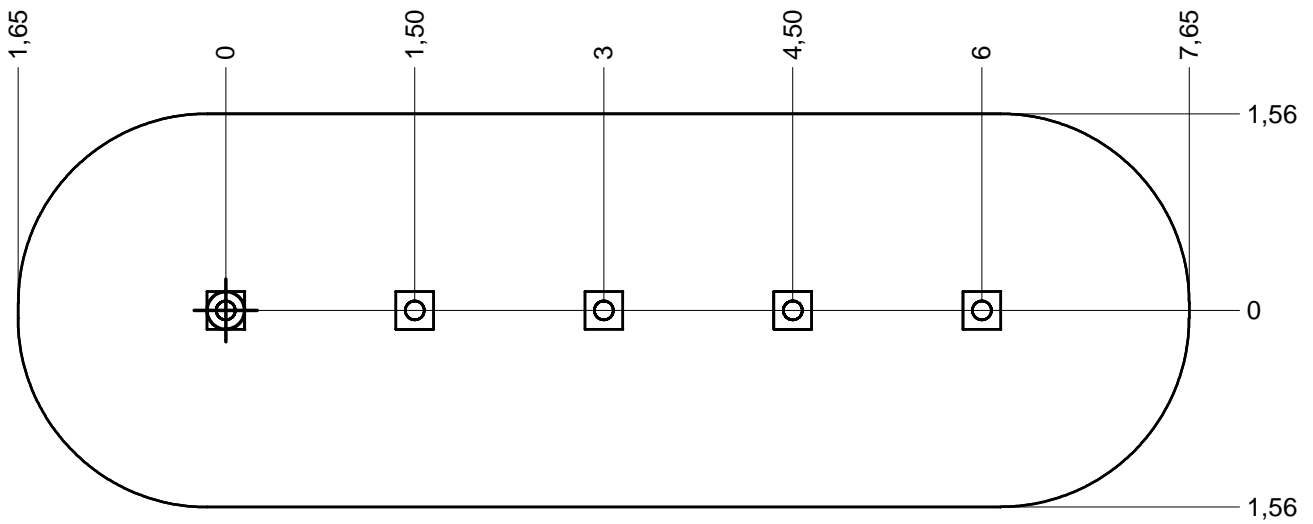



Implantation
 Footing plan
 Implantación
 Fundamentplan
 Funderingstekening

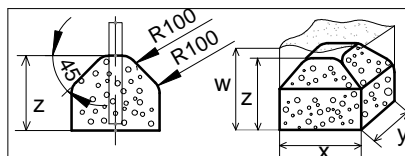

 x1
 1H
 0.15 m³

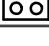

	x	y	z	w
	0.3	0.3	0.3	0.6
	0.4	0.4	0.3	0.6
	0.6	0.3	0.3	0.6

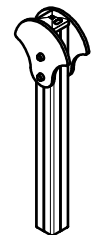
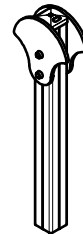
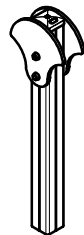
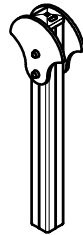
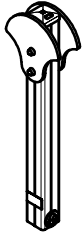

REF	QTE
FT681	10
LAJPS16	1
LGP1072-4	5
M8310N	22
M8440N	22
MI0001N	5
RRAV6	10
VTH6x30A	22

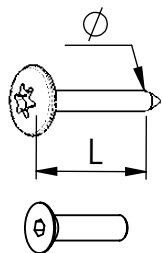

VBT 6 x 30
 \varnothing \uparrow L (mm)

VFHC



VEC M10
 \varnothing



VEF



VEB

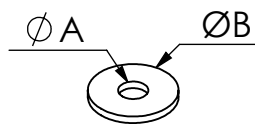

VR6x18
 $\varnothing A$ $\varnothing B$

VTHA

14 N.m
 Couple de rupture
 Torque of break

1000 - 1800 tr/min
 Vitesse de rotation
 Rotation speed

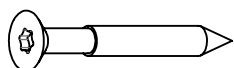

VWT

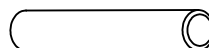

VGC

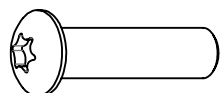

VCBHC

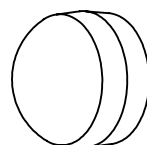

M10 440N

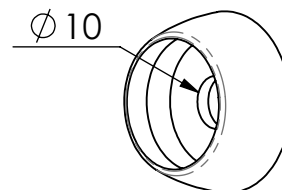

M10 310 N

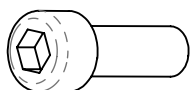

VBTR

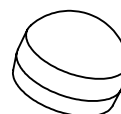

M8 440N

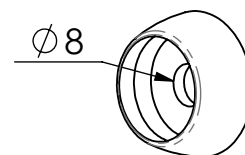

M8 310N

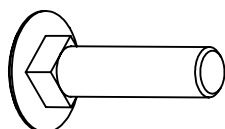

VTRCC

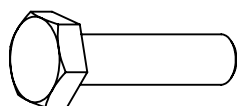

VTH

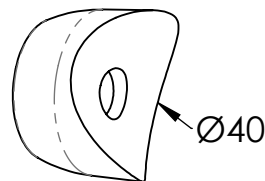

MI2503

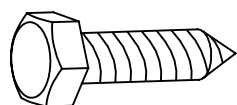

VTF

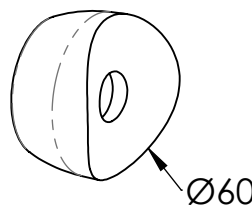

MI2701

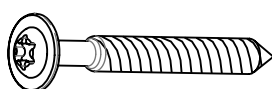

VBT

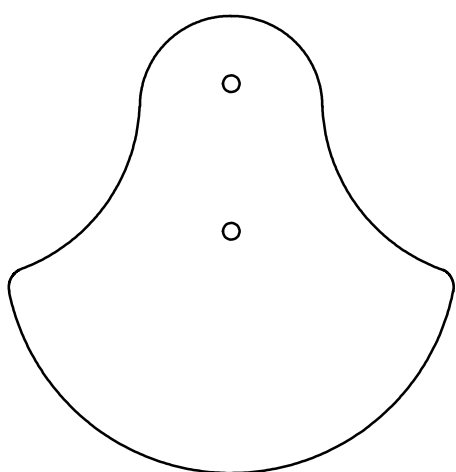

FT681

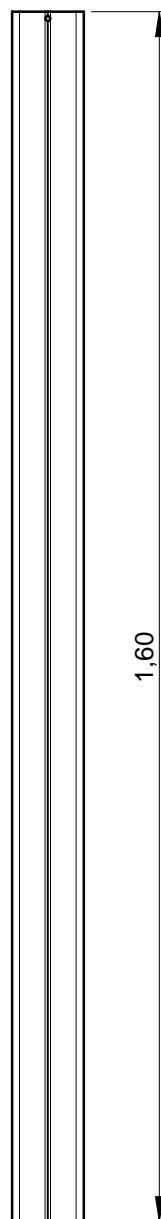

LGP1072-4

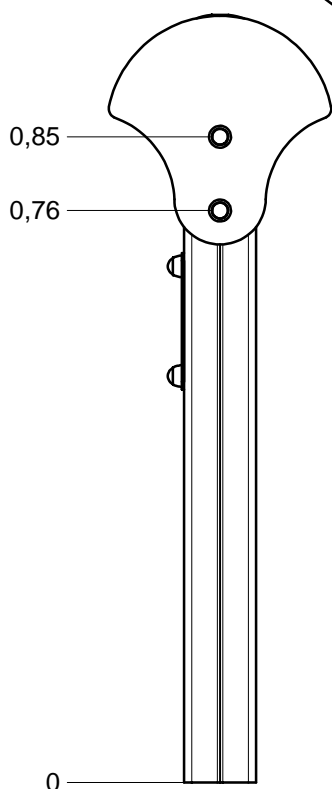
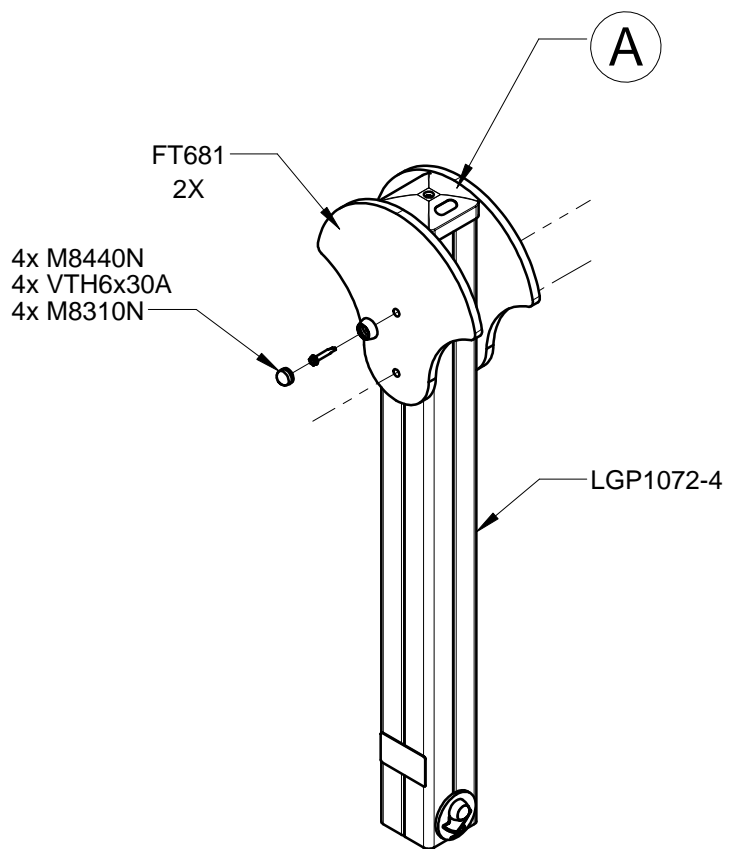
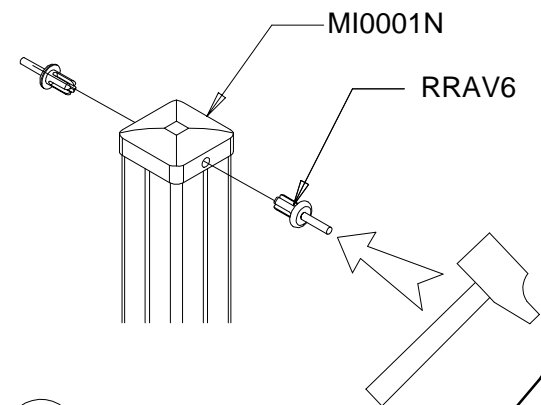

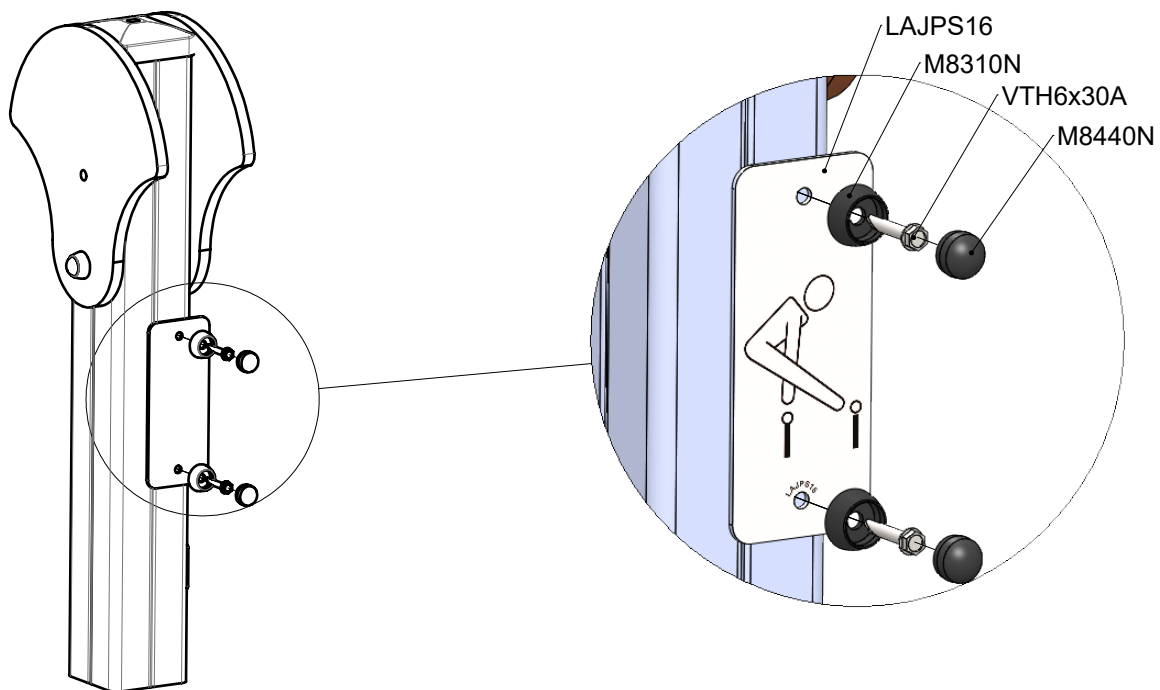

- JPS16-J-M
- JPS16-S-M

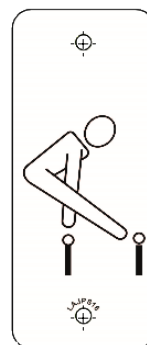

LAJPS16

Réf	Qté
LAJPS16	1
M8310N	2
M8440N	2
VTH6x30A	2