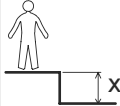
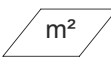

N°		
1	0.6 m	12 m ²
2	1 m	15.5 m ²

— Zone d'impact
Impact area
Area de impacto
Fallraum
Valzone

△ 0 Point de référence
Setting out point
Punto de referencia
Bezugspunkt
Referentiepunt

- - - Espace libre
Free space
Espacio libre
Freiraum
Vrije ruimte

EN1176-1:2017
EN1176-3:2017

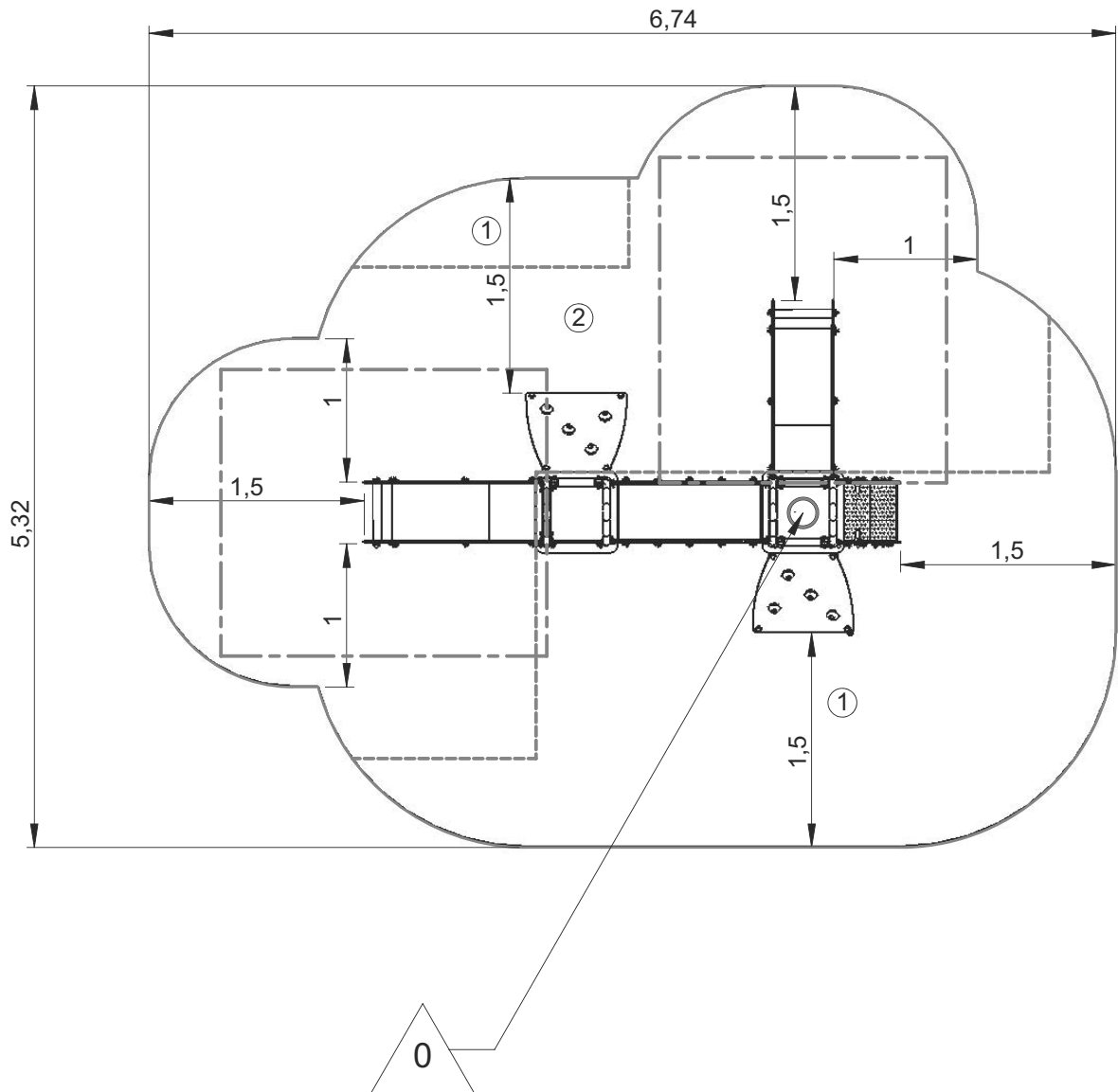

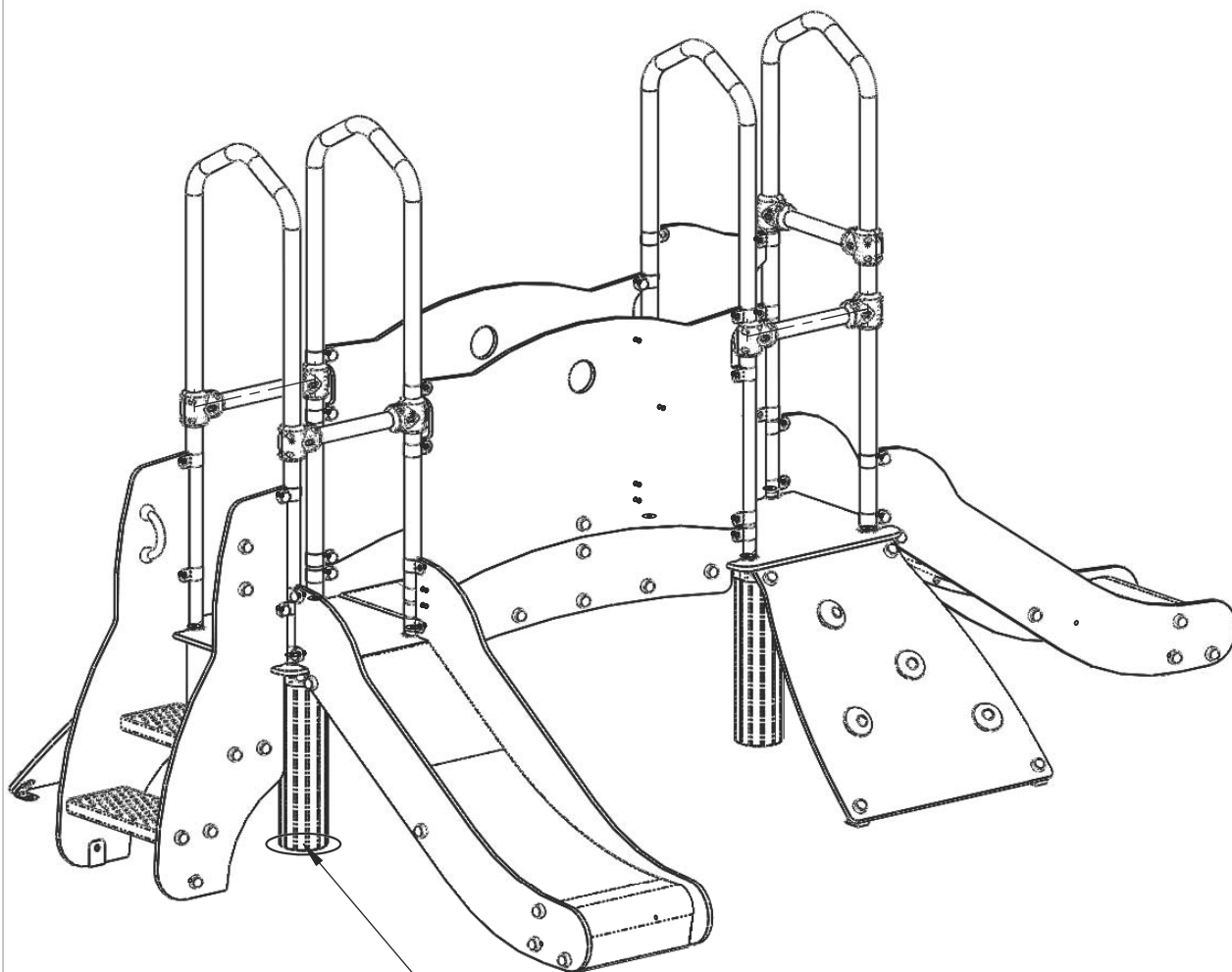

0

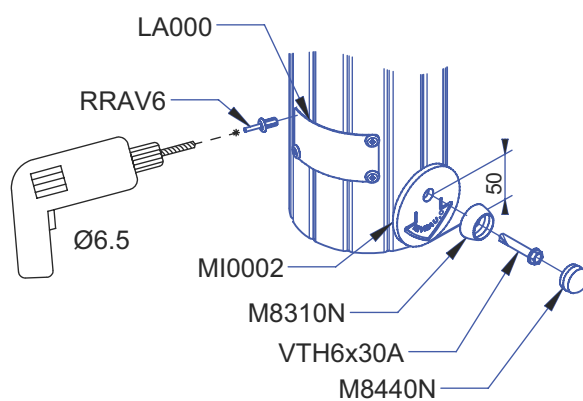

— Zone d'impact
 Impact area
 Area de impacto
 Fallraum
 Valzone

28 m²

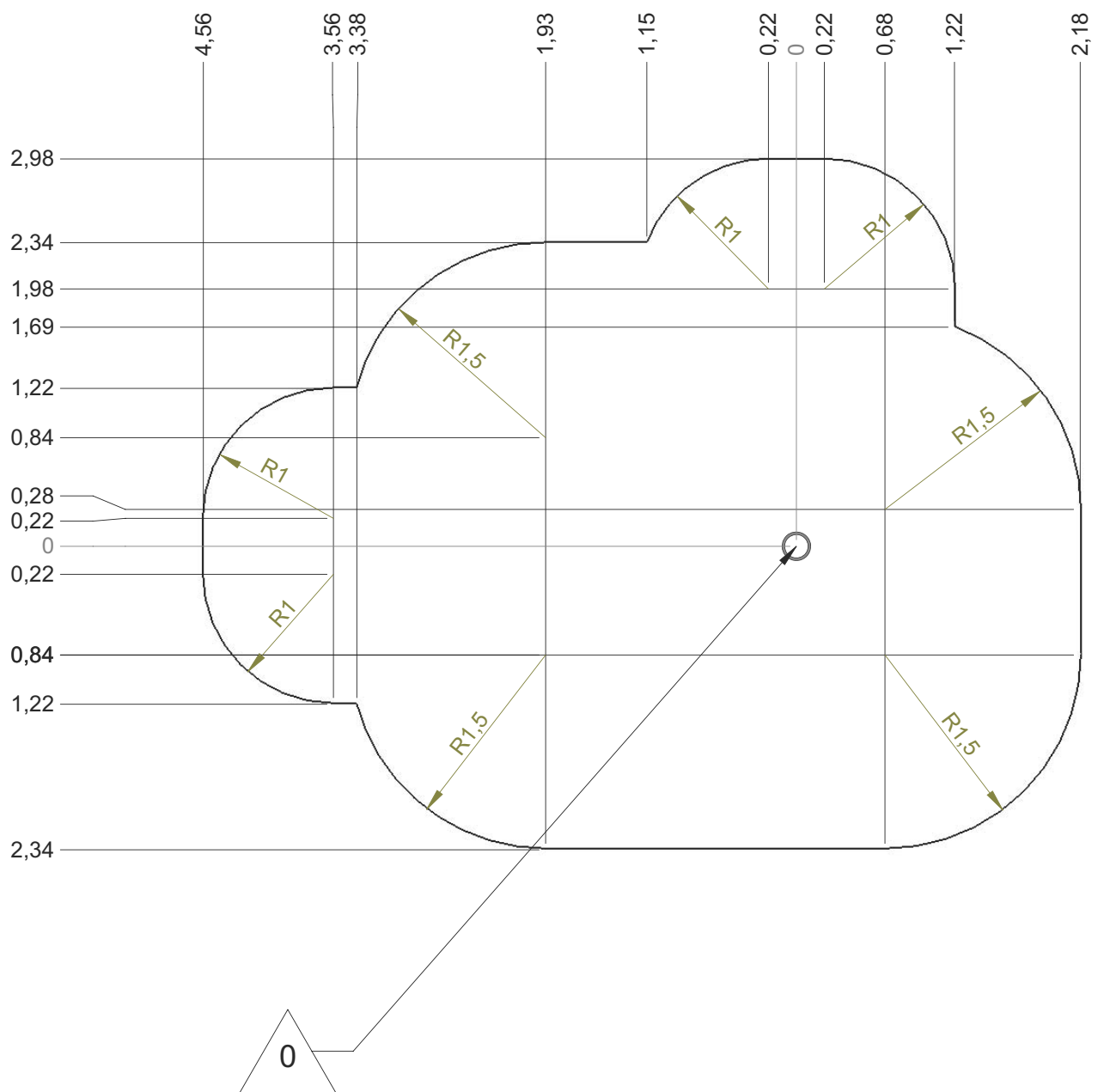

— Sol souple
 Wepour
 Caucho continuo
 Synthetischer fallschutz
 Gietvloer

28 m²

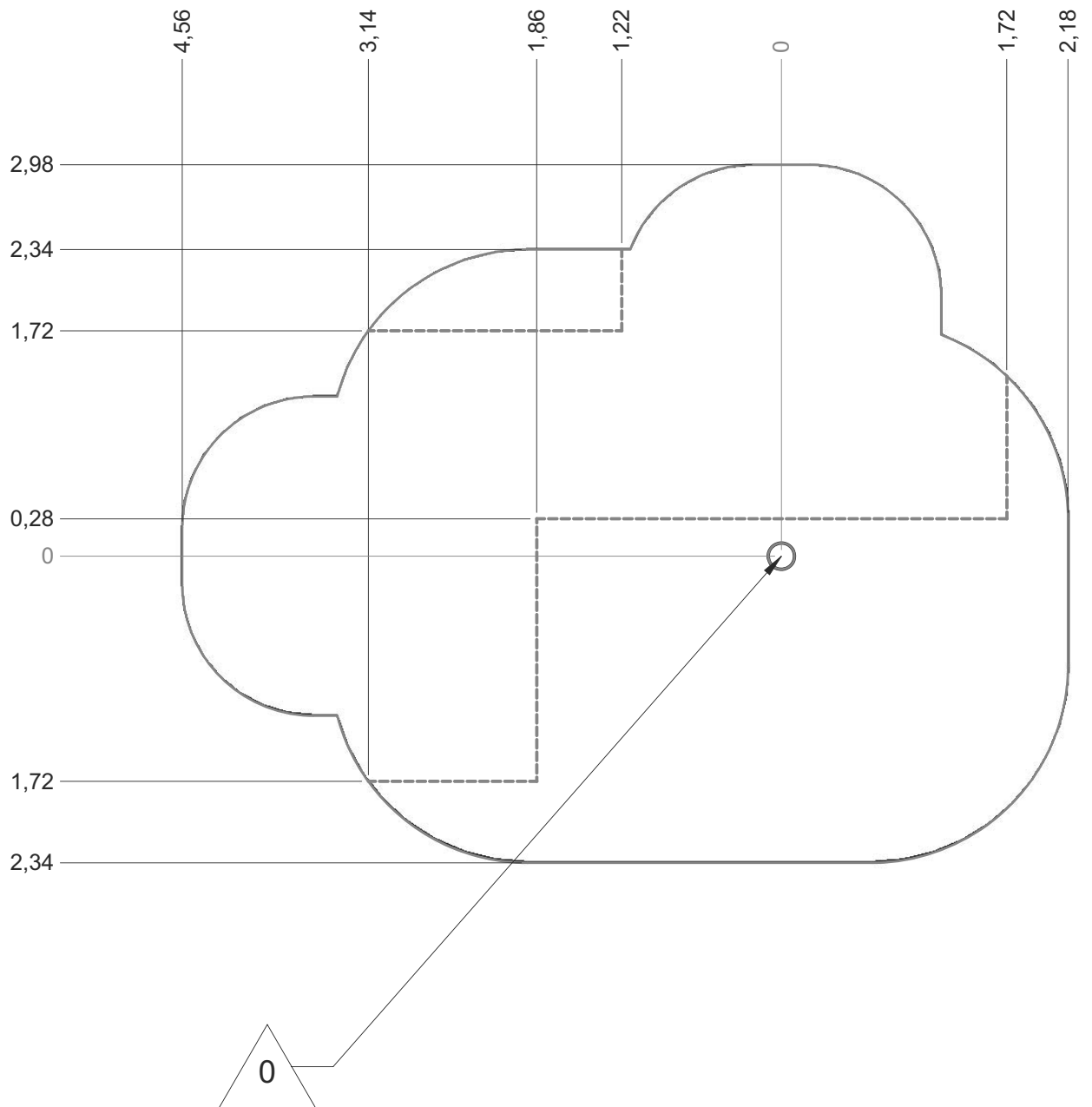

— Dalle béton
 Concrete pad
 Solera de hormigon
 Beton bodenplatte
 Betonnen bodemplaat

25 m
 30 m²

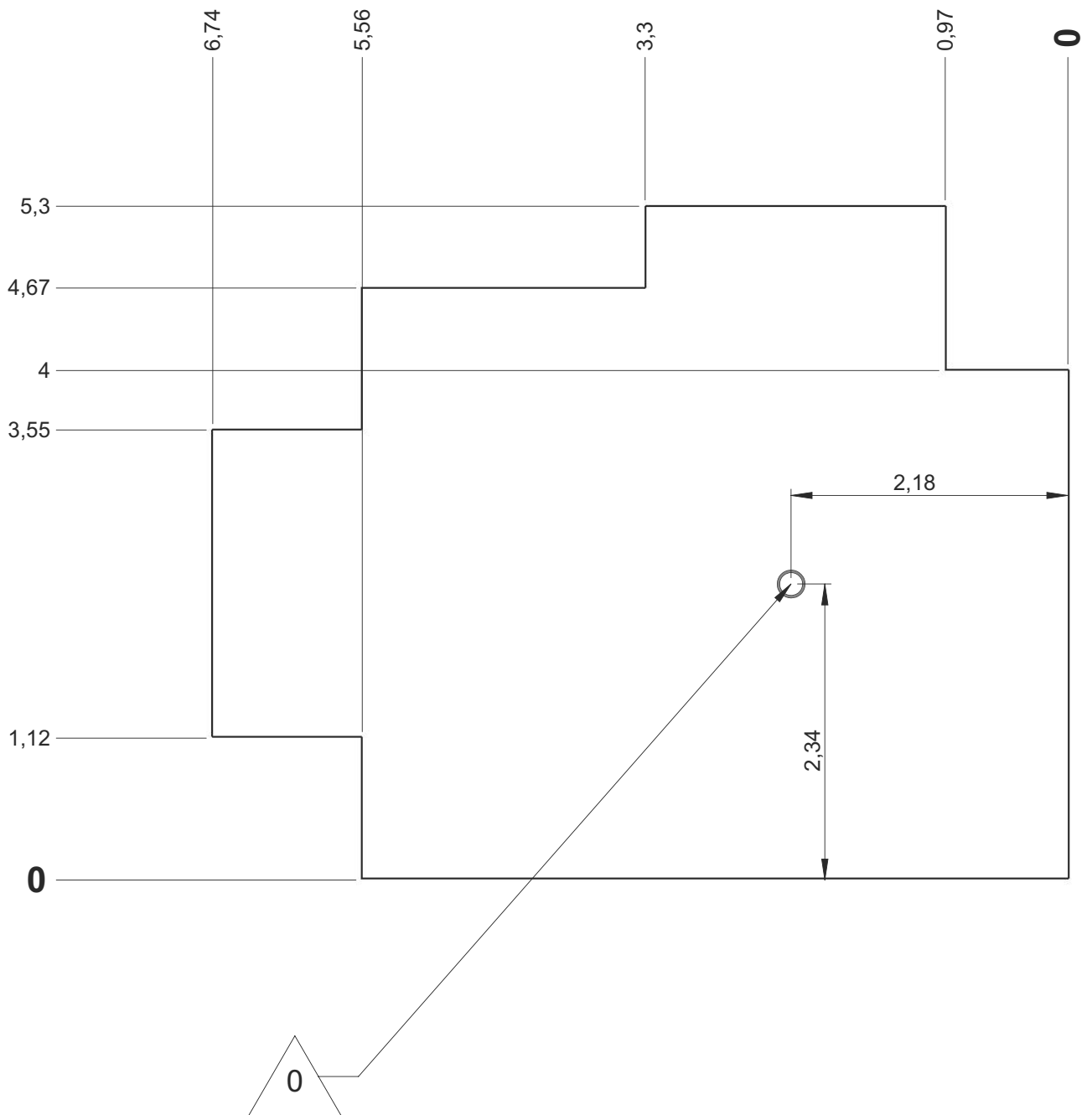

— Sol fluent
 Loos partucule material 26 m
 Arenero
 Loses Bodenmaterial 33 m²
 Los bodemateriaal

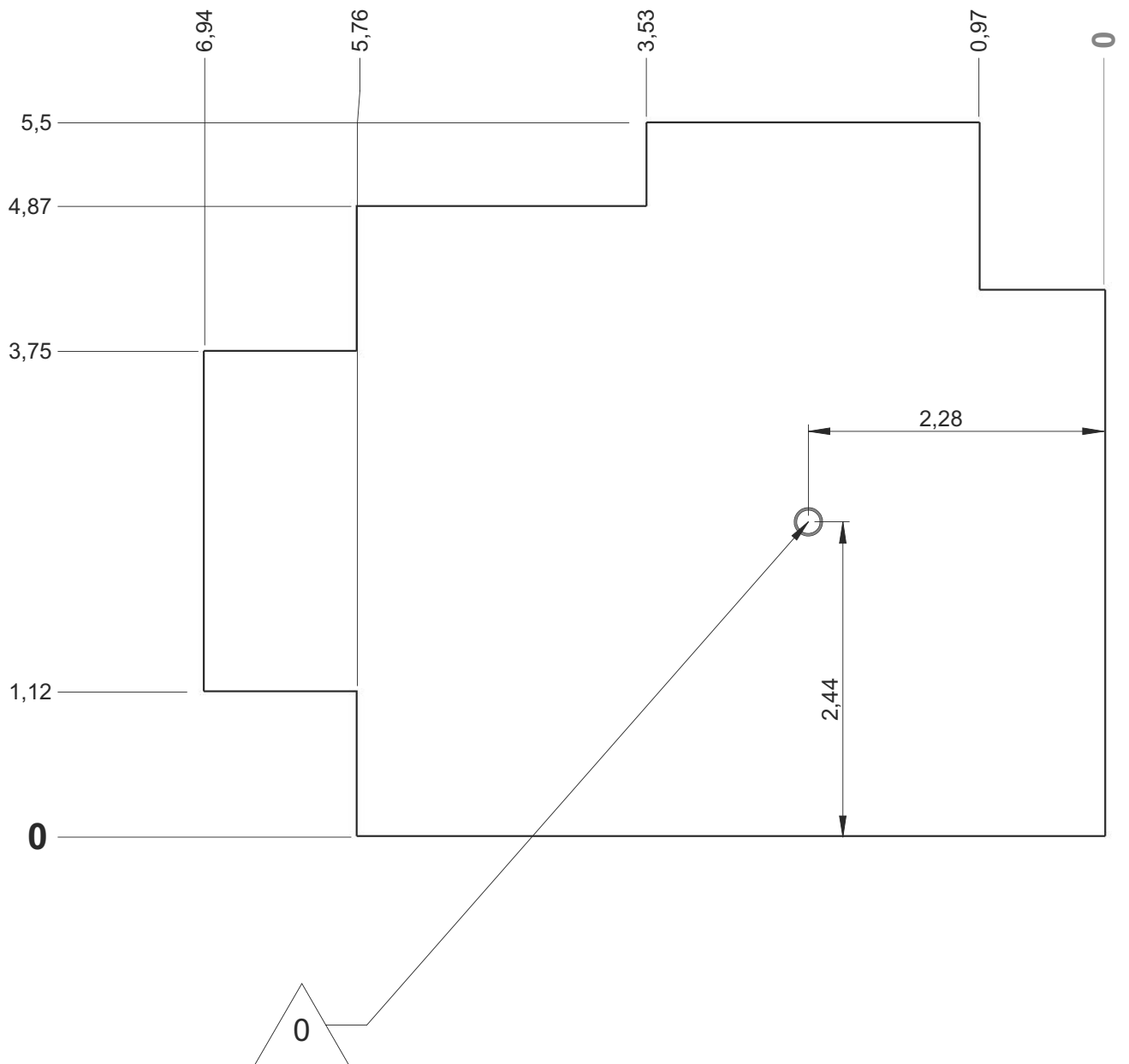

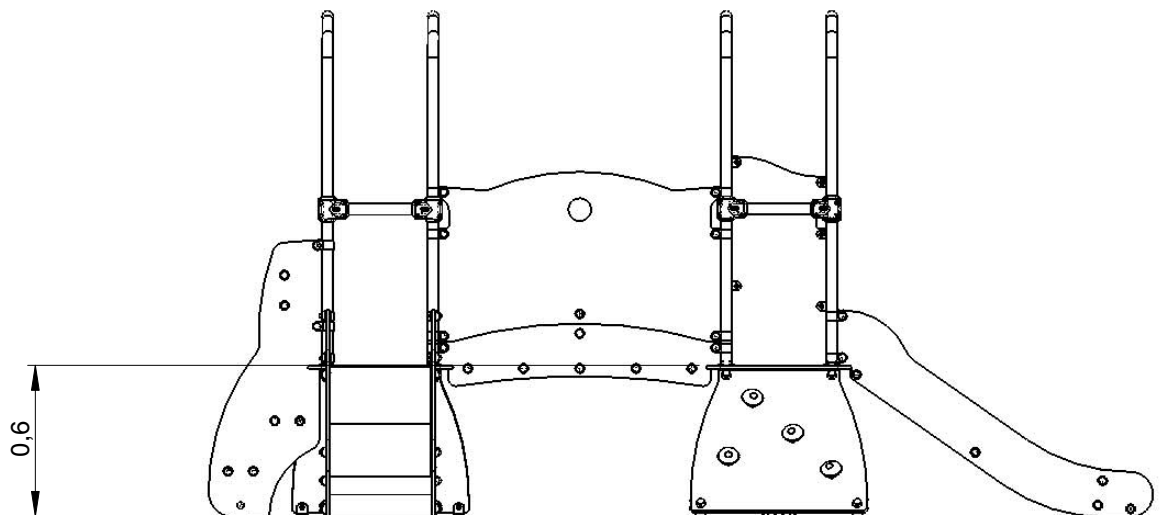
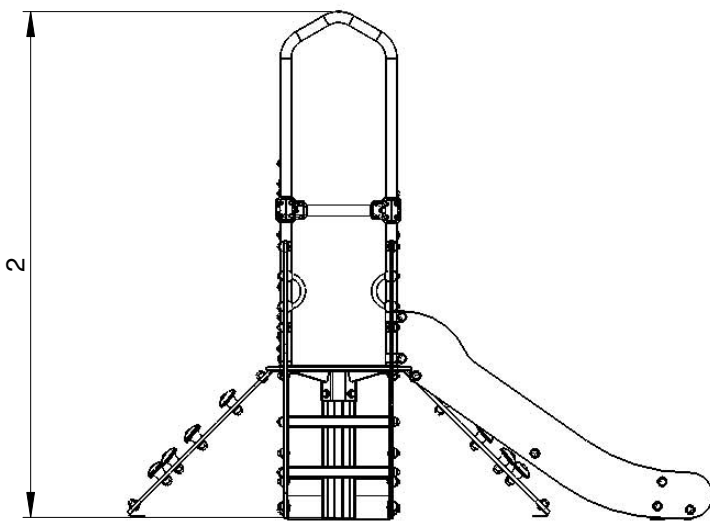
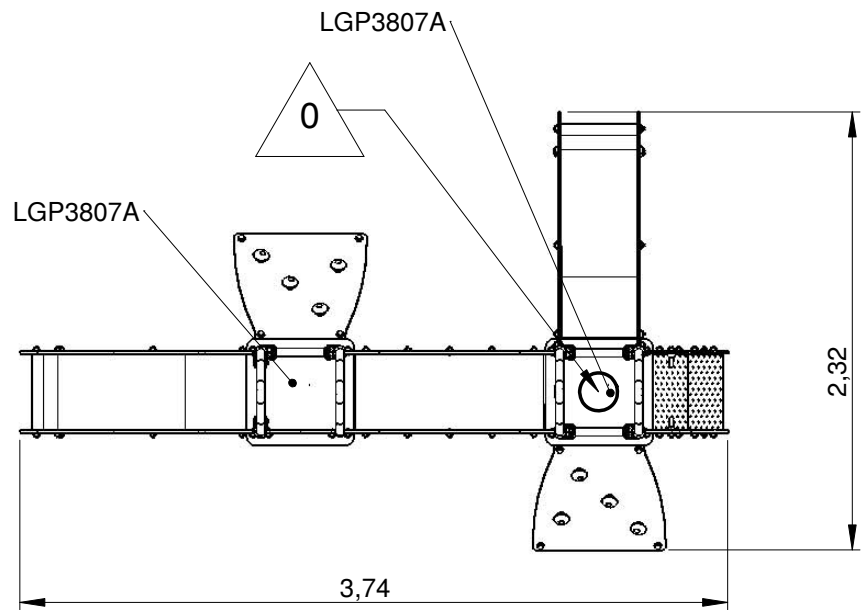

J3872 A

Implantation
 Footing plan
 Implantación
 Fundomentplan
 Funderingstekening

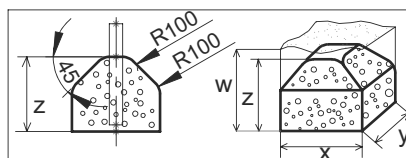
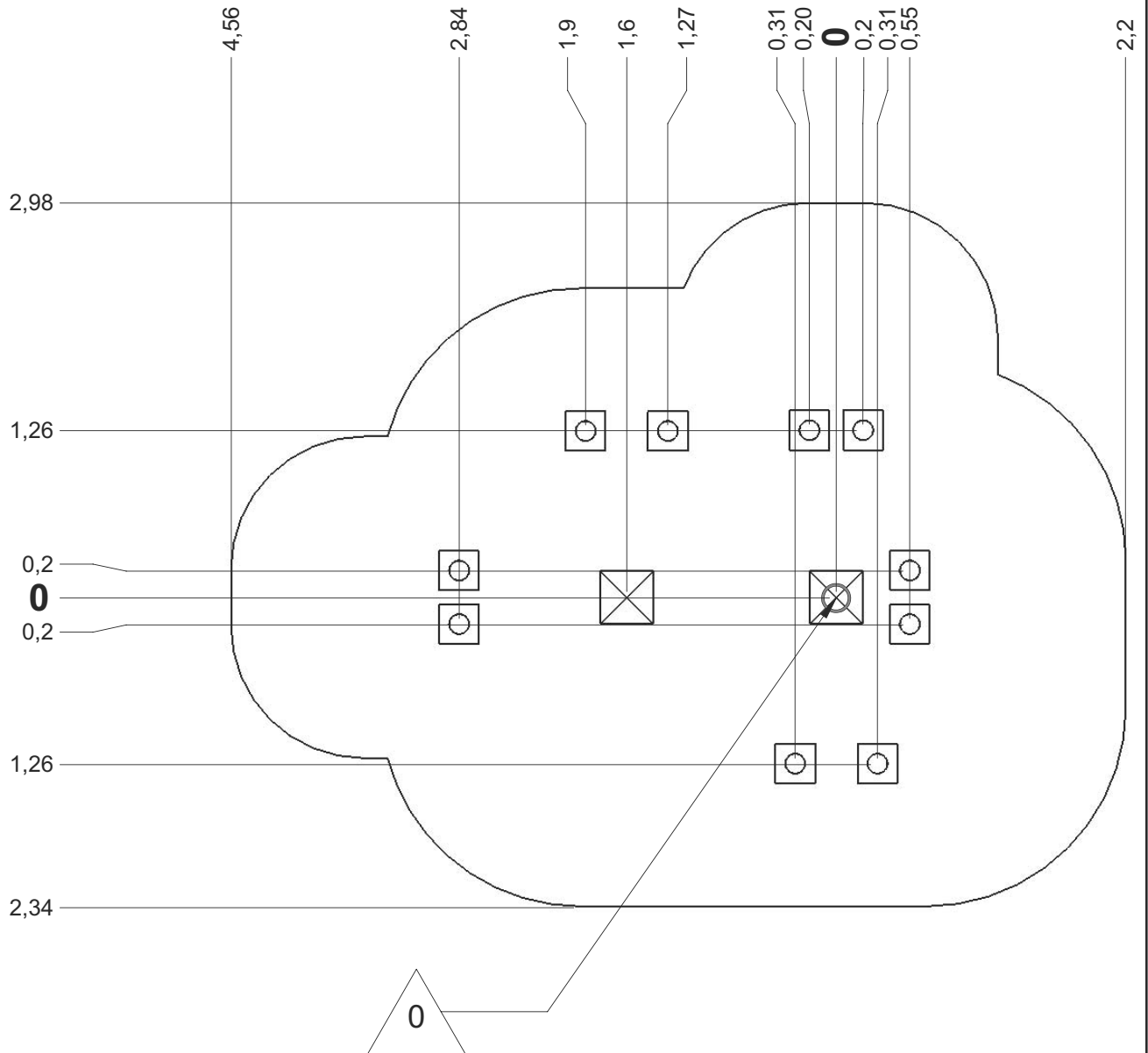

	x	y	z	w
	0.3	0.3	0.3	0.6
	0.4	0.4	0.3	0.6
	0.6	0.3	0.3	0.6

1

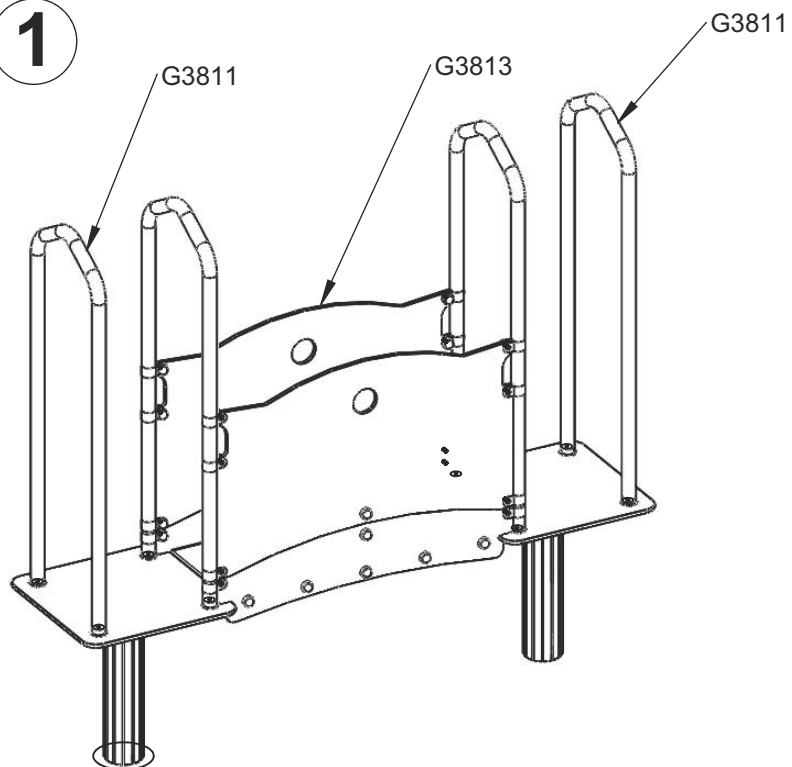

2

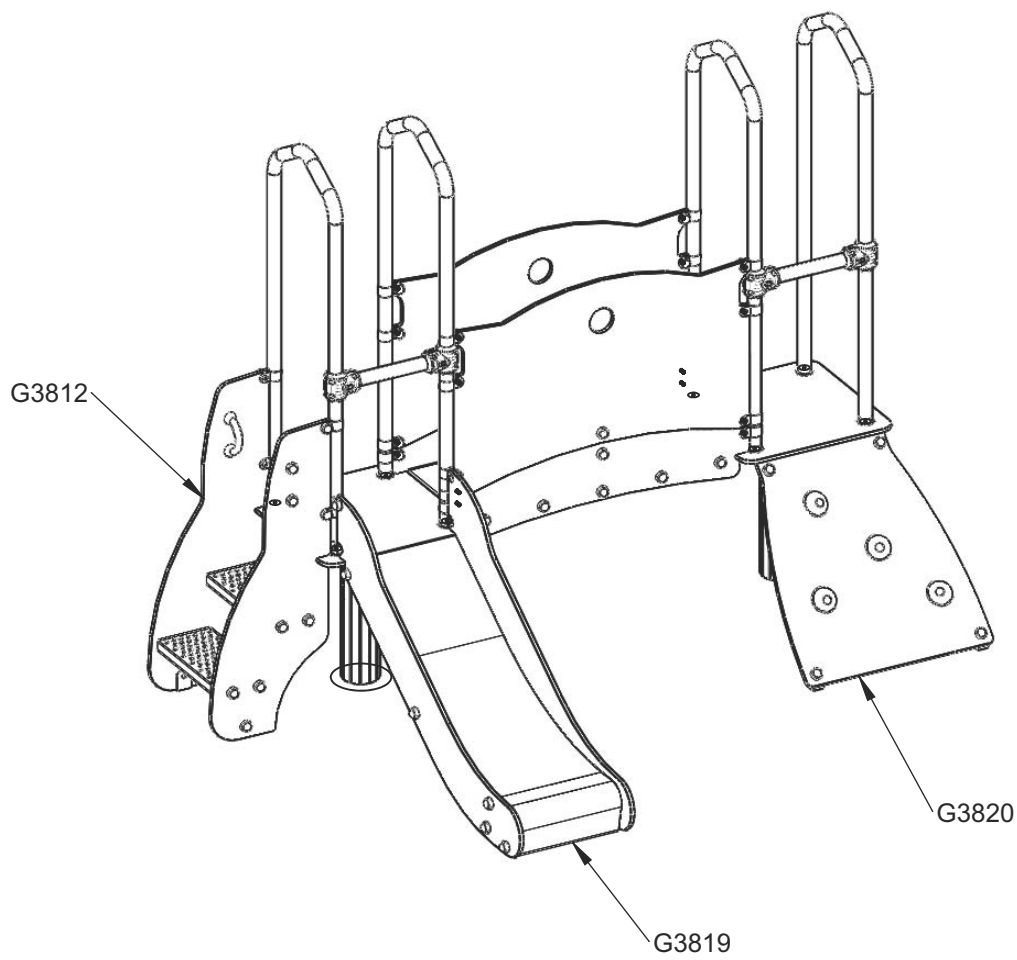

3

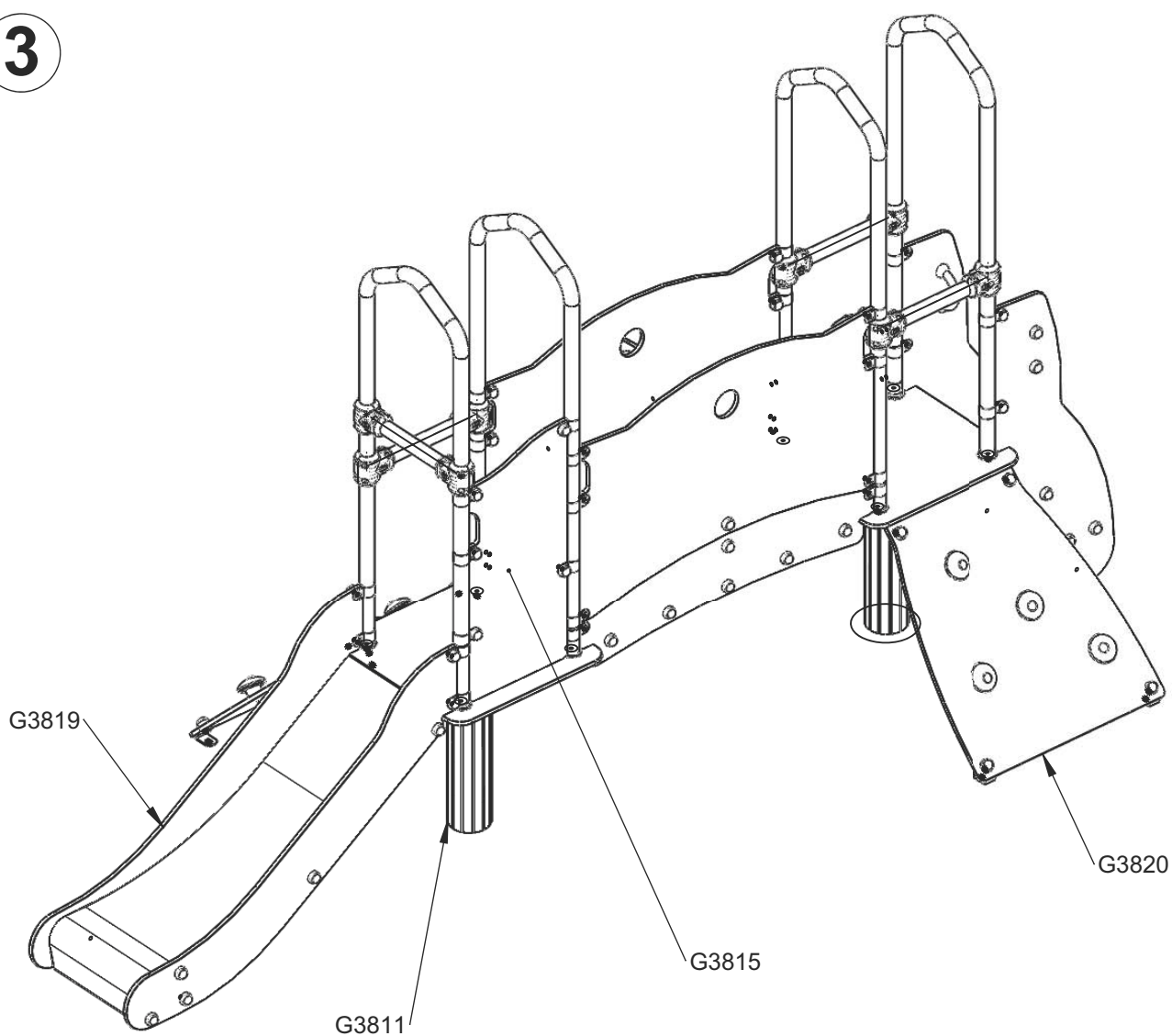

Réf	Qté
G3811	2
G3812	1
G3815	1
G3819	1
G3813	1
G3820	2
G3819	1

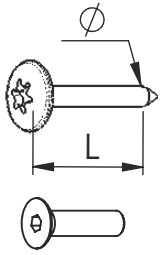

VBT 6 x 30
 \varnothing \uparrow L (mm)

VFHC

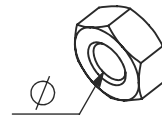

VEC M10
 \varnothing

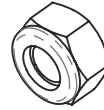

VEF

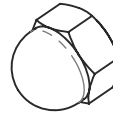

VEB

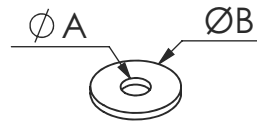

VR6x18
 $\varnothing A$ $\varnothing B$

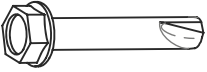

VTHA

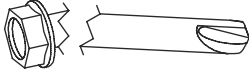
1000 - 1800 tr/min
 Vitesse de rotation
 Rotation speed

14 N.m
 Couple de rupture
 Torque of break



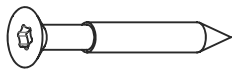

VWT



VGC

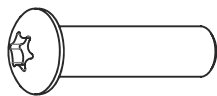

VCBHC

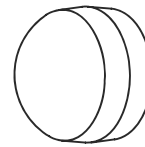

M10 440N

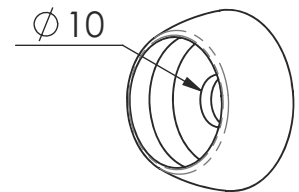

M10 310 N

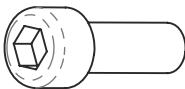

VBTR

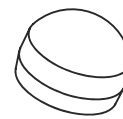

M8440N

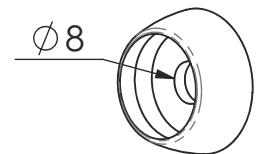

M8310N

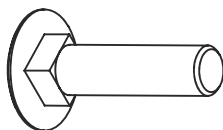

VTRCC

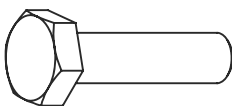

VTH

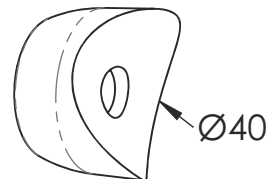

MI2503

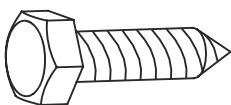

VTF

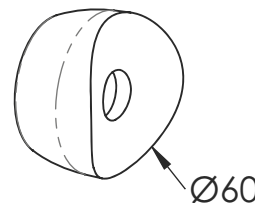

MI2701

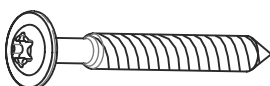

VBT

A

Proludic

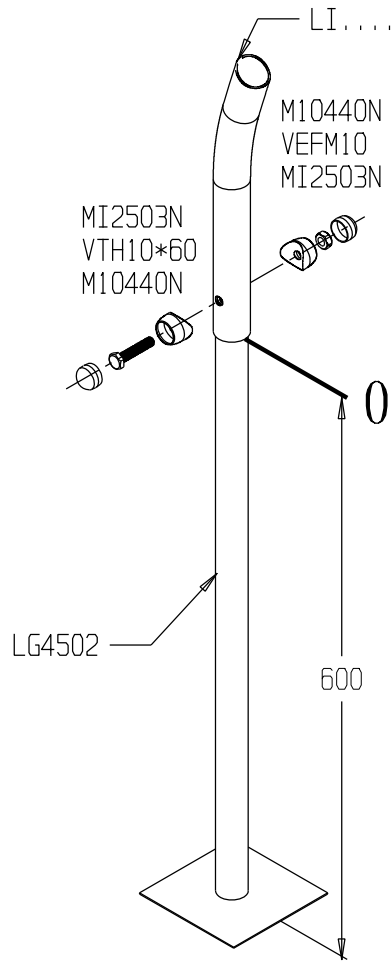

> 1500 Kgs/M³

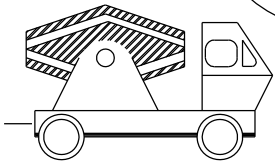
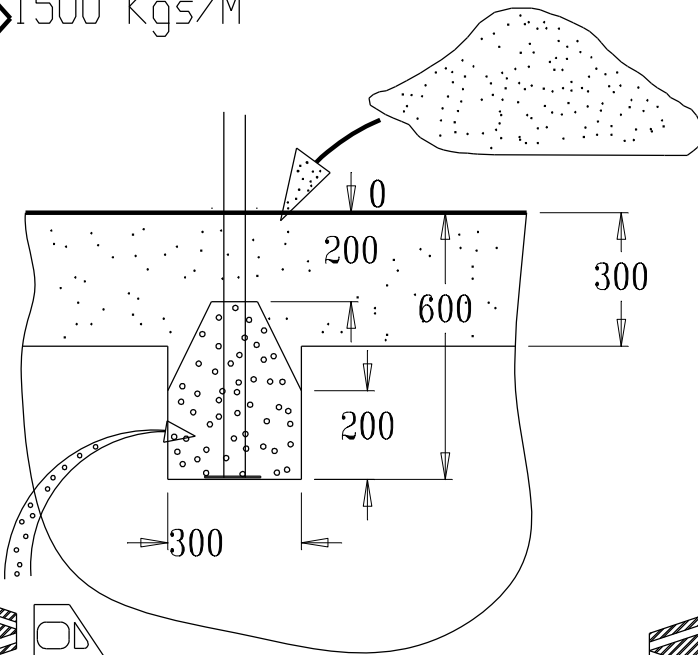

50 Kgs



< 1500 Kgs/M³

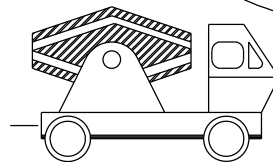
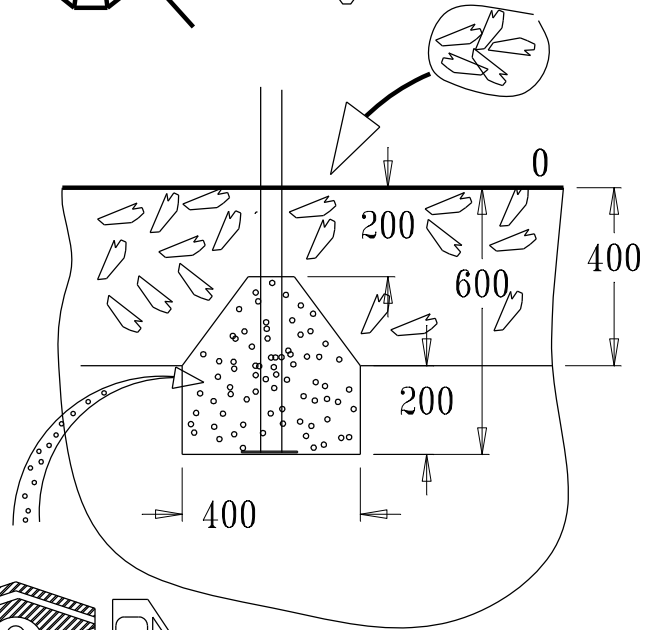

90 Kgs

A

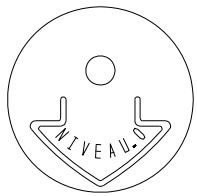

MI0002

VCBHCM10

M10310N
VEFM10
M10440N

LG08

M10440N
VEFM10
MI2503

M10440N
VTH10*80
MI2503

LG3802

LG3804



> 1500 Kgs/M³



< 1500 Kgs/M³

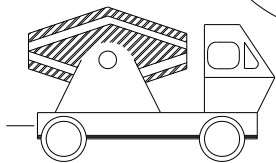
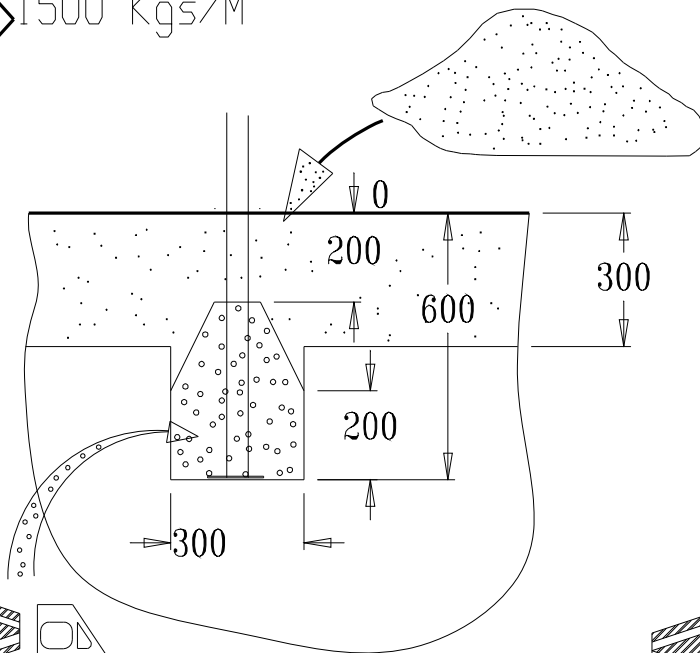

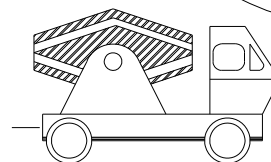
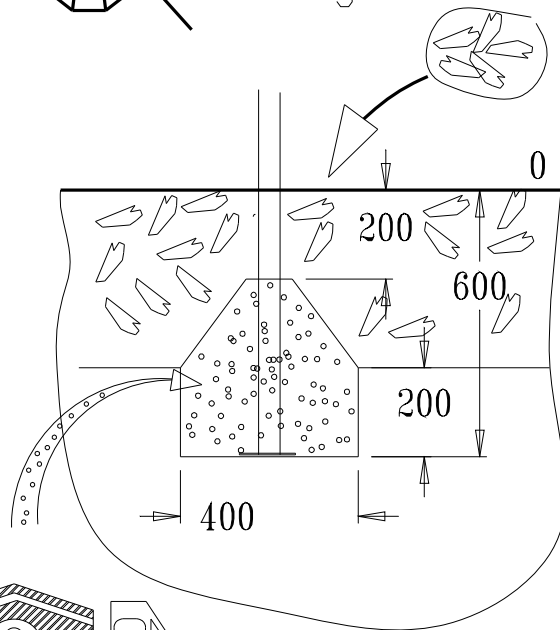

50 Kgs



90 Kgs

LG4412 + MI025 ..

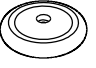
ProLudic

	VFHCM6x40	1
	MI 025..	1
	M10440..	1
	LG4412	1

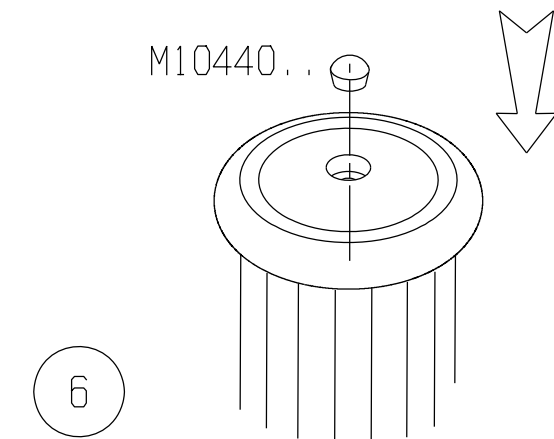
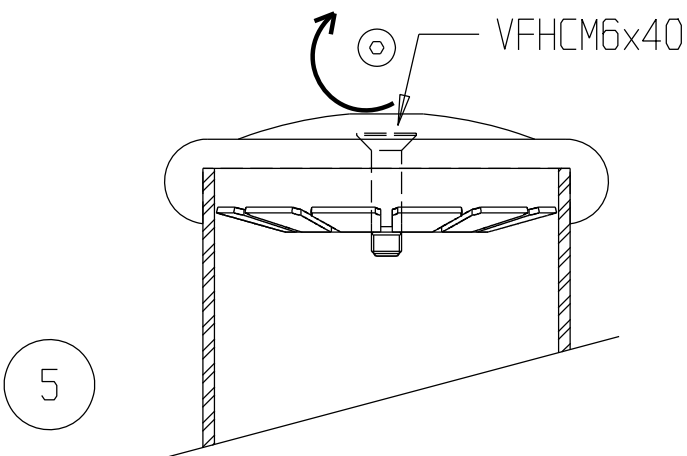
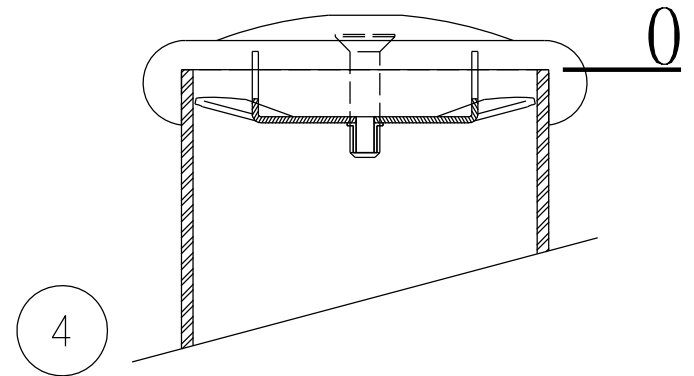
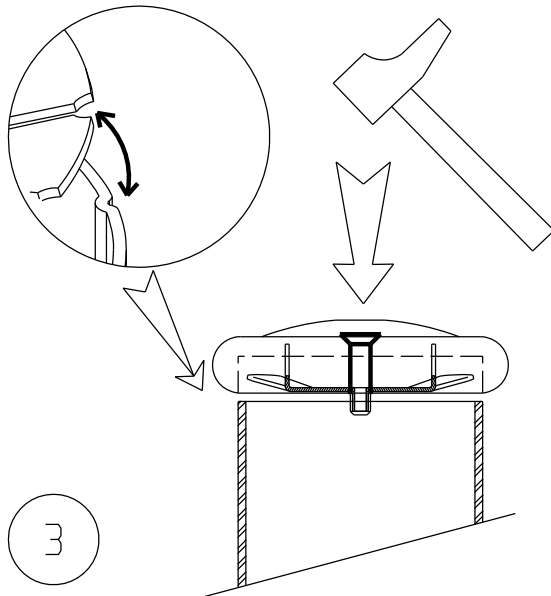
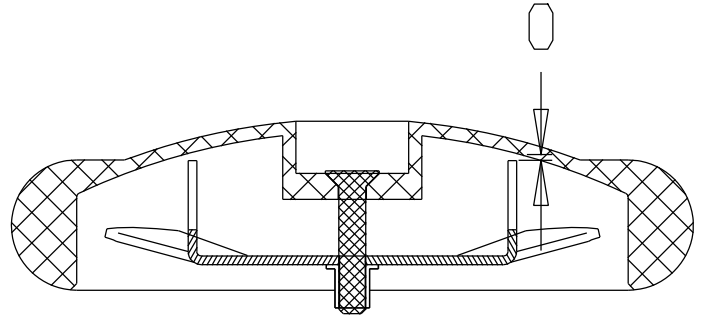
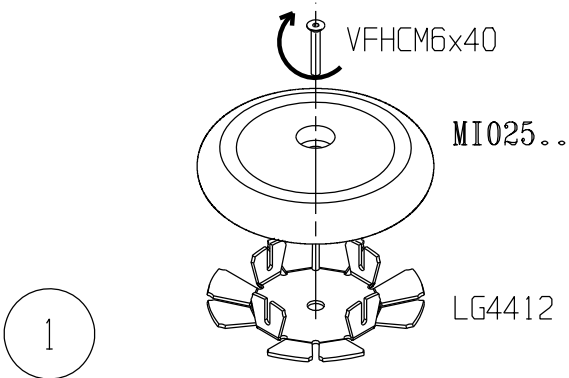

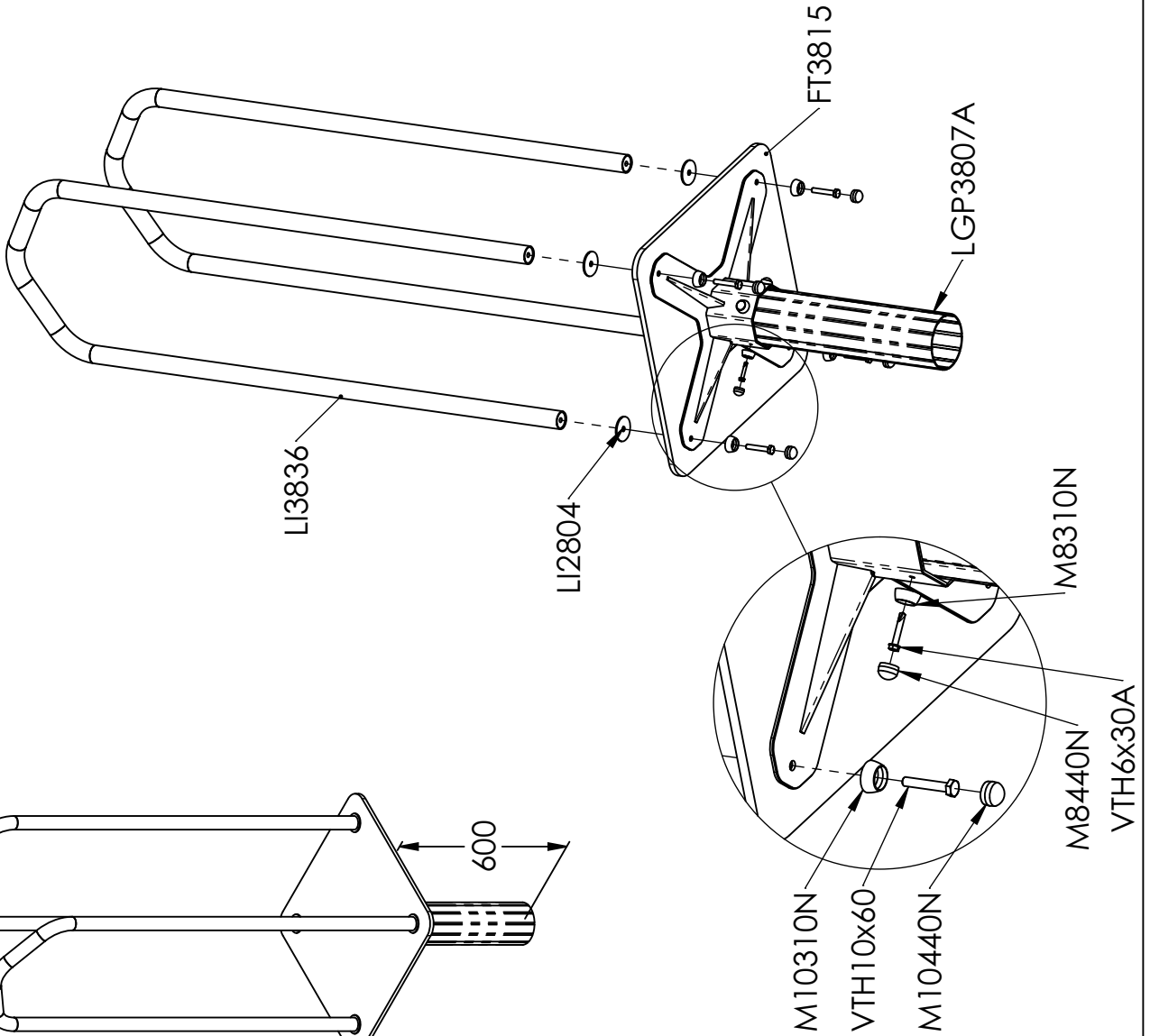
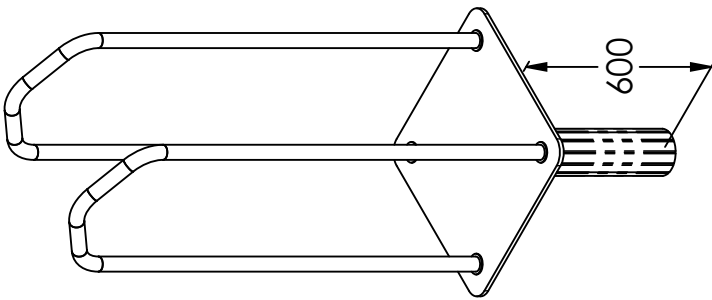

LG3810

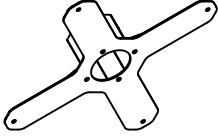

FT3815

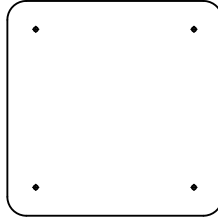

L13836

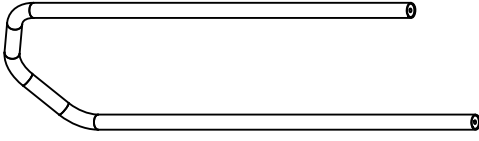

LGP3807A

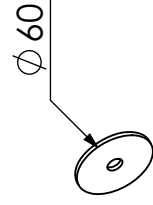

L12804

Réf	Qte
FT3815	1
LG3810	1
LGP3807A	1
L12804	4
L13836	2
M8310N	4
M8440N	4
M10310N	4
M10440N	4
VTH6x30A	4
VTH10x60	4

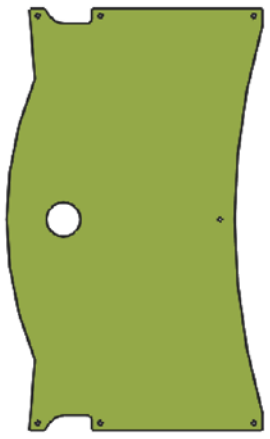
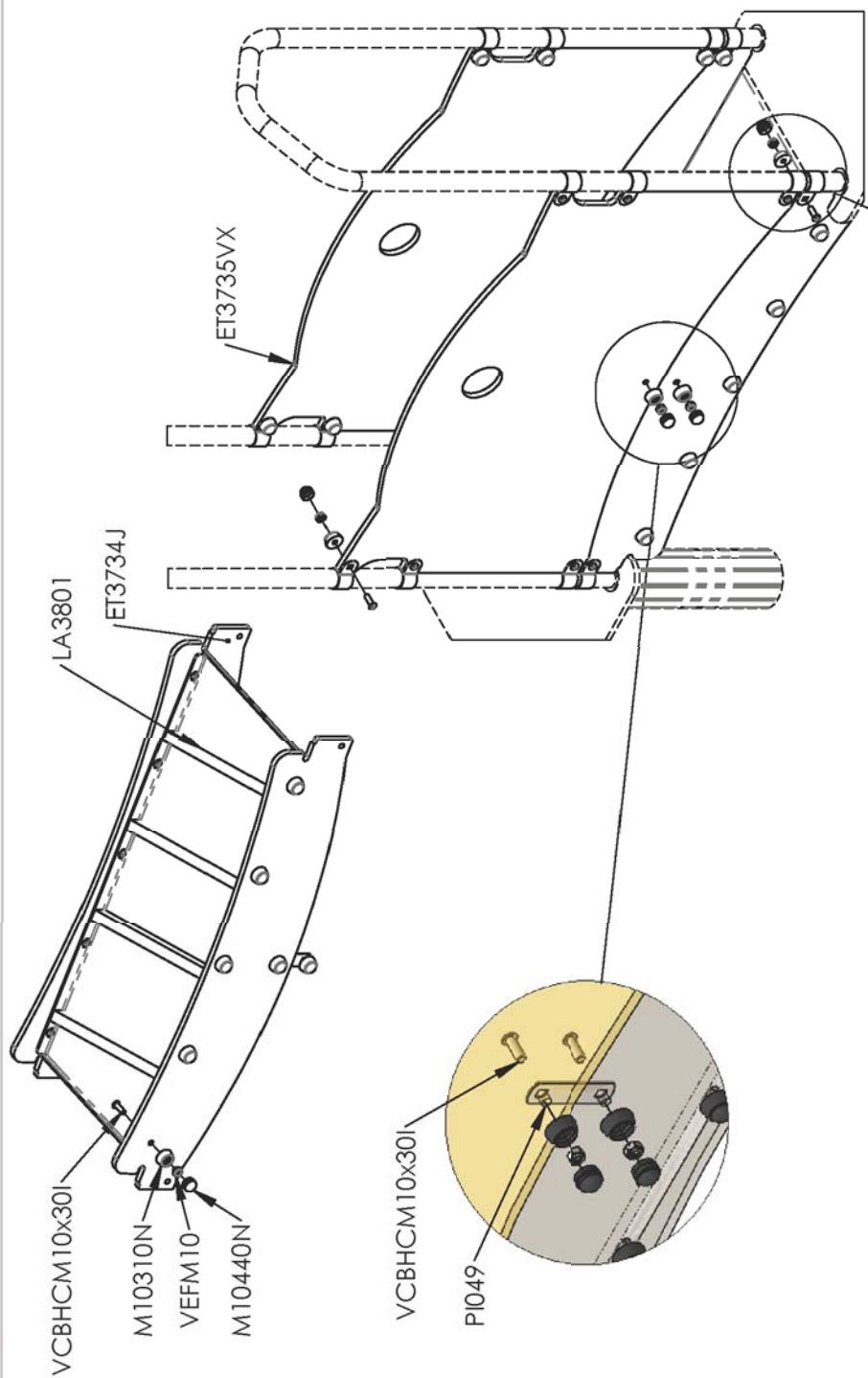

ET3735VX

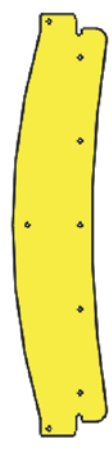

ET3734J

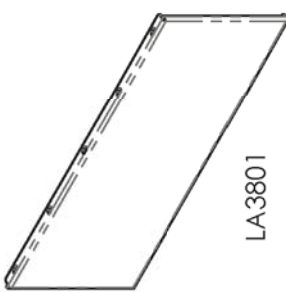

LA3801

LI4505



P1049



Ref	Qté
ET3734J	2
ET3735VX	2
LA3801	1
LI4505	16
M10310N	30
M10440N	30
P1049	2
VCBHCM10x30I	30
VEFM10	30

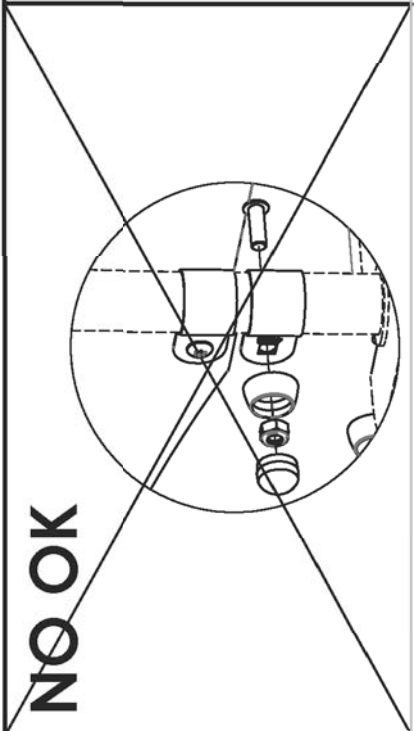

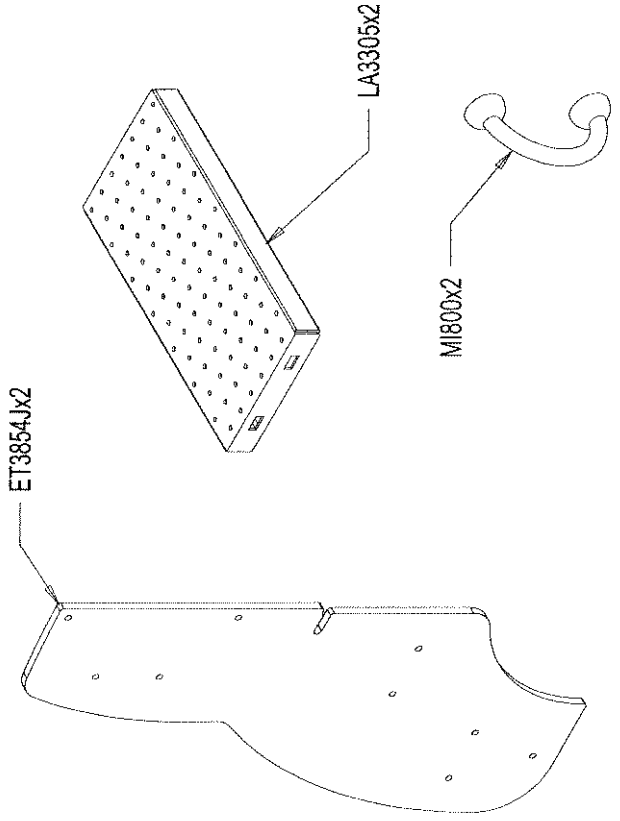
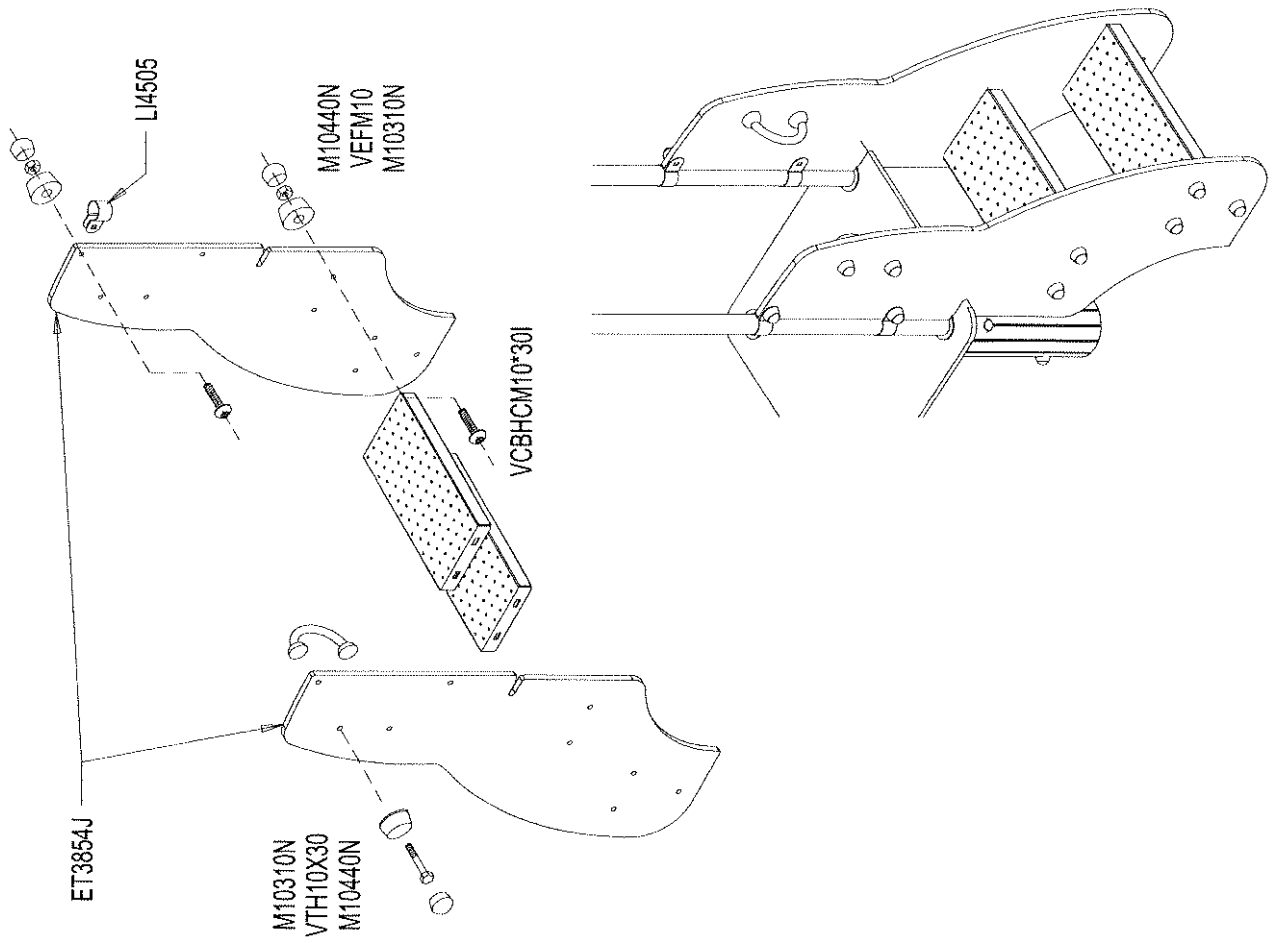

	VTH 10x30	4
	MI 800	2
	VEFM10	12
	VCBHCM10*30I	12
	M10310N	16
	M10440N	16
	LI4505	4

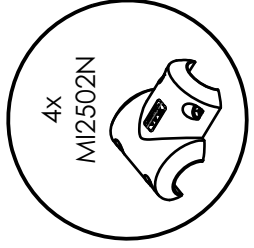
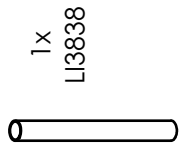
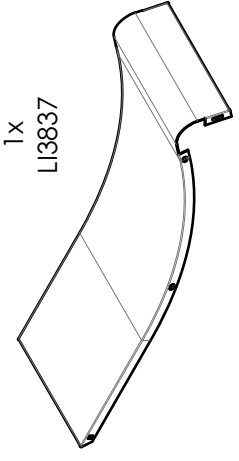
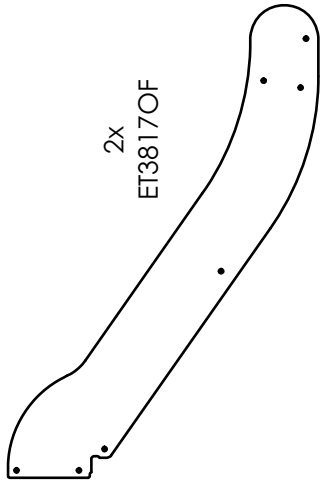
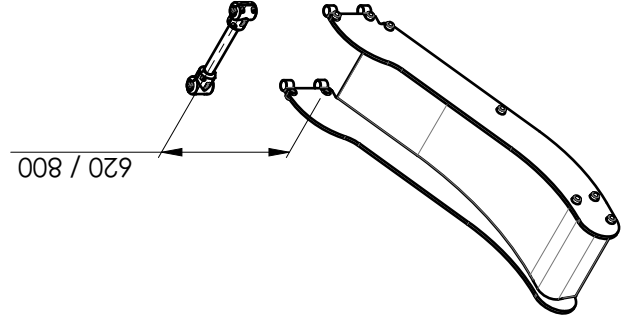
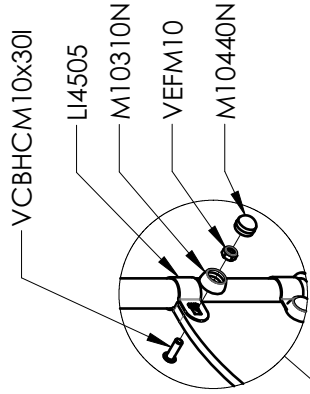
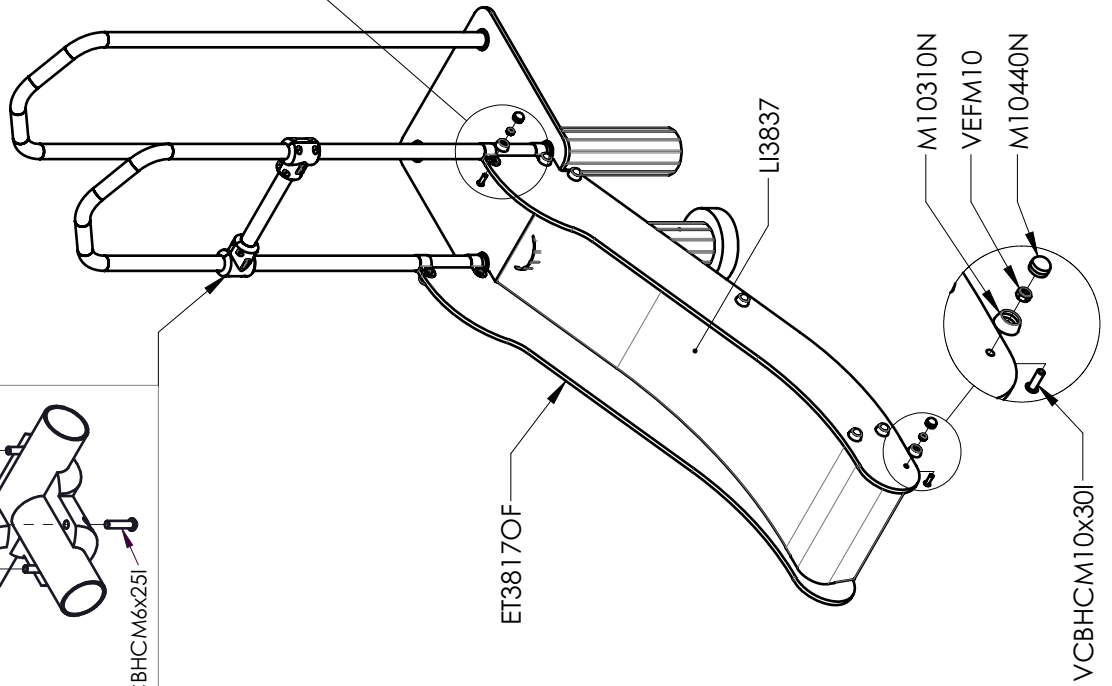
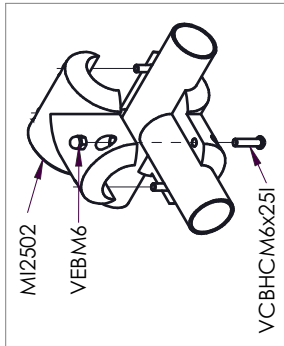

ET3817OF	2
LI3837	1
LI3838	1
LI4505	4
M10310N	14
M10440N	14
M12502N	4
VCBHCM6x25I	8
VCBHCM10x30I	14
VEBM6	8
VEFM10	14

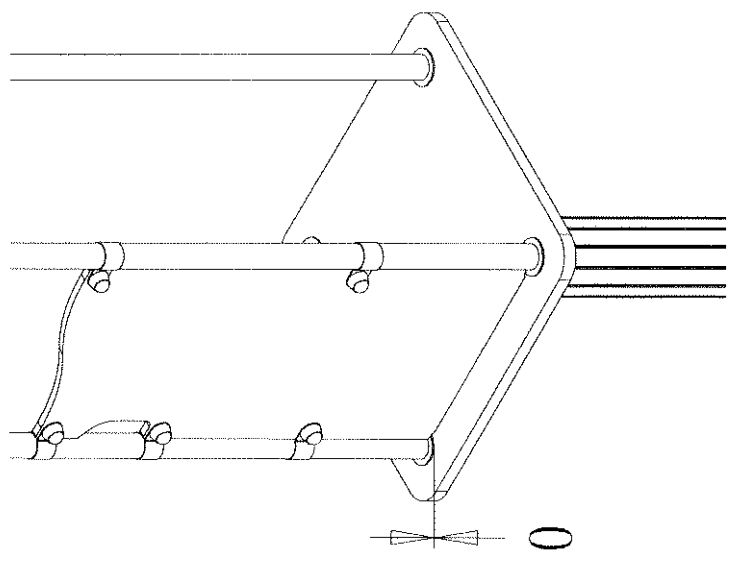
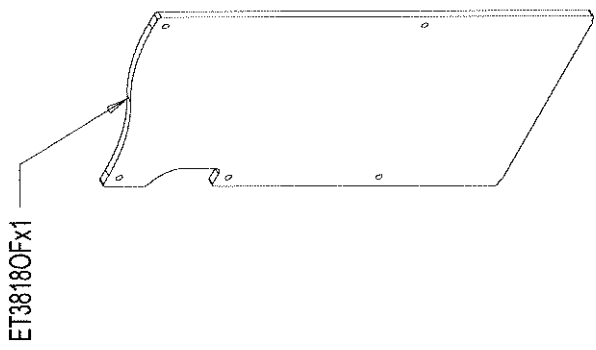
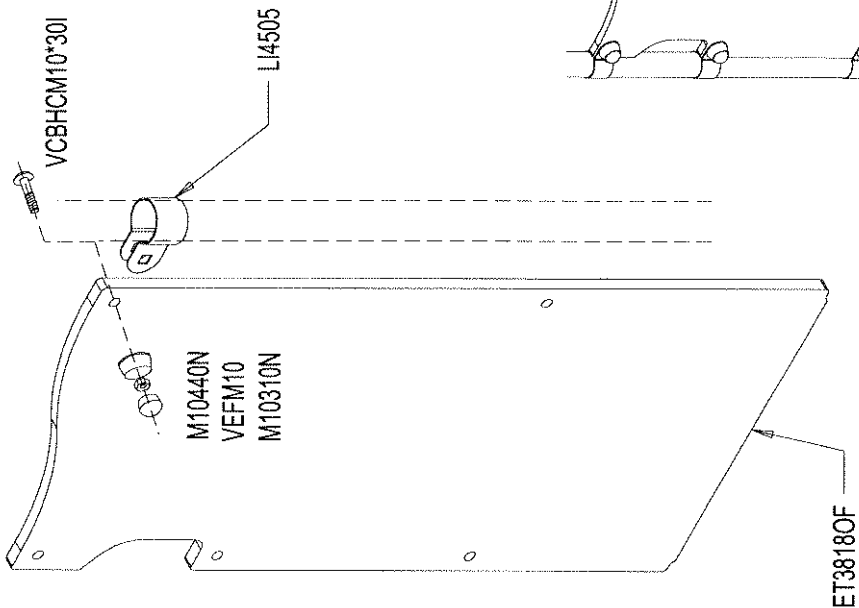

	VEFM10	5
	VCBHCM10*30I	5
	M10310N	5
	M10440N	5
	LI4505	5