

J3833

Proludic

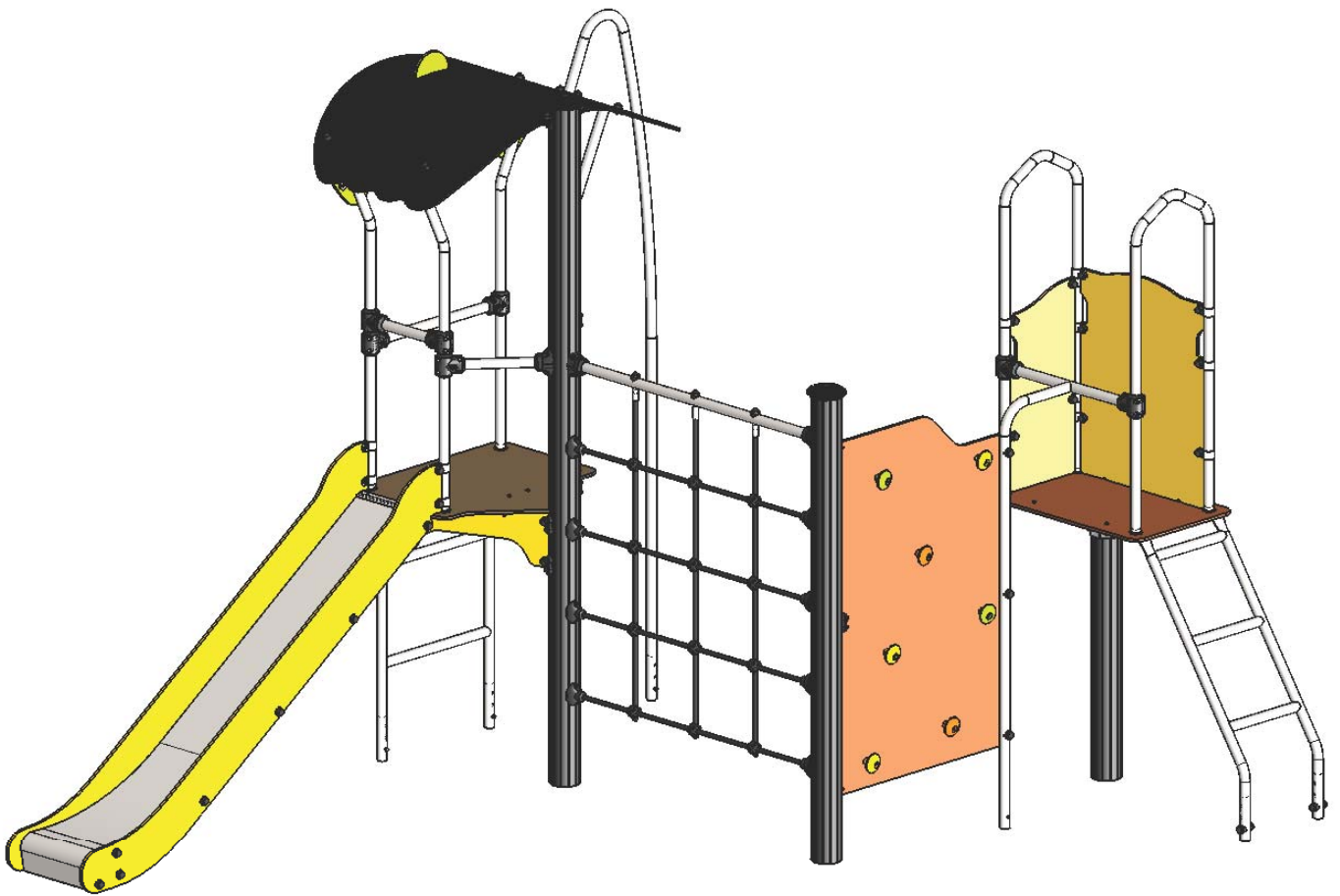

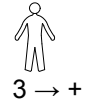
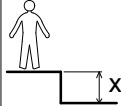
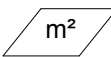

N°		
1	1 m	5.5 m ²
2	1.17 m	11.5 m ²
3	1.8 m	8.5 m ²
4	2 m	11.5 m ²

— Zone d'impact
Impact area
Area de impacto
Fallraum
Valzone

- - - Espace libre
Free space
Espacio libre
Freiraum
Vrije ruimte

 Point de référence
Setting out point
Punto de referencia
Bezugspunkt
Referentiepunt

EN1176-1:2017
EN1176-3:2017

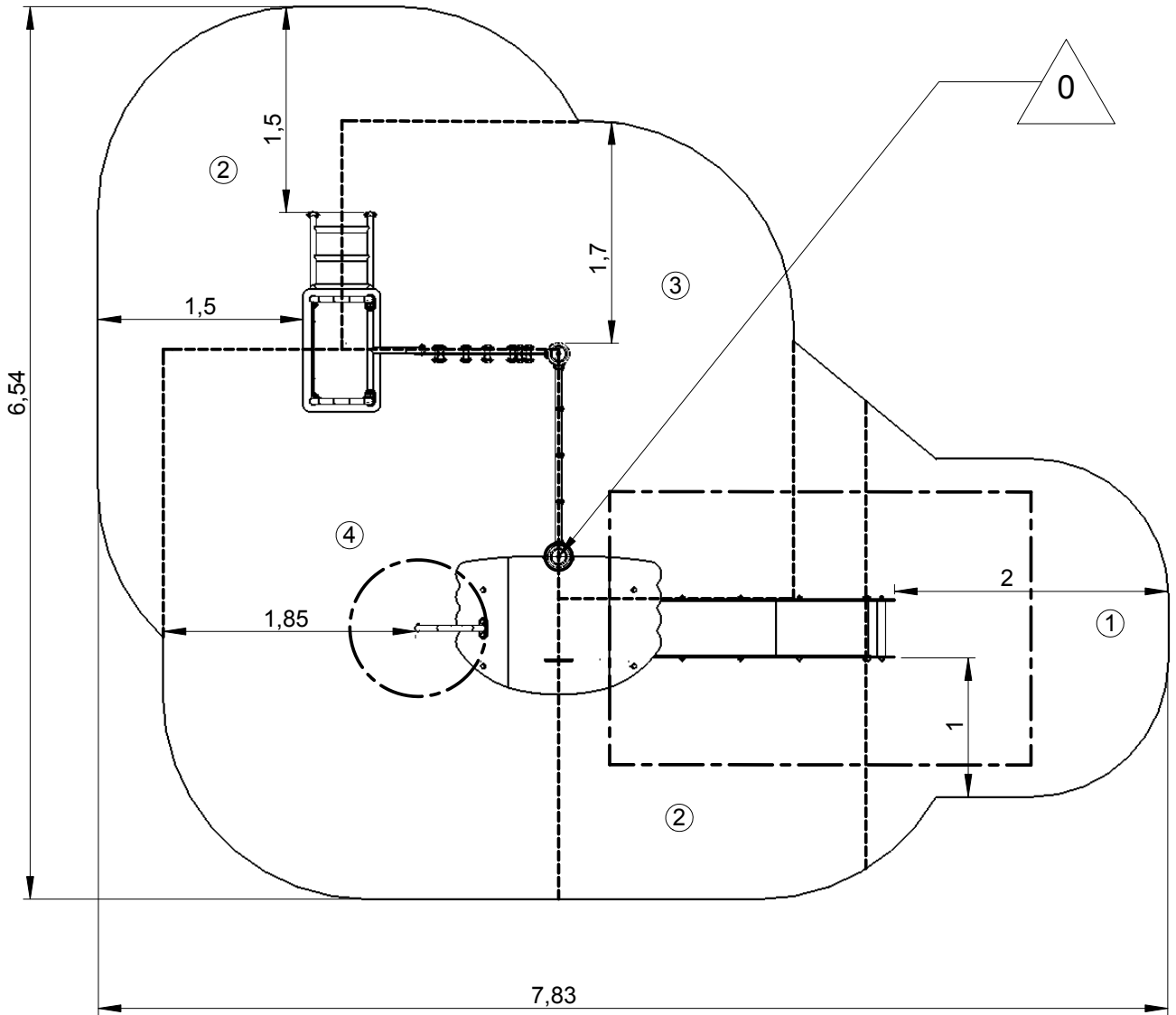

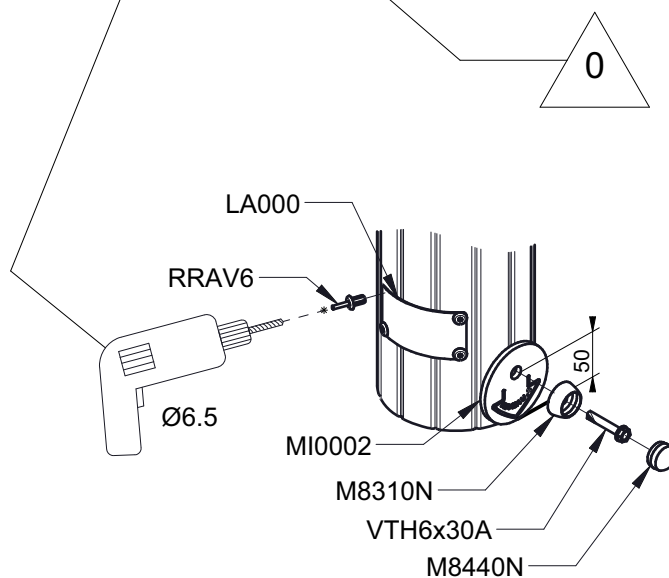
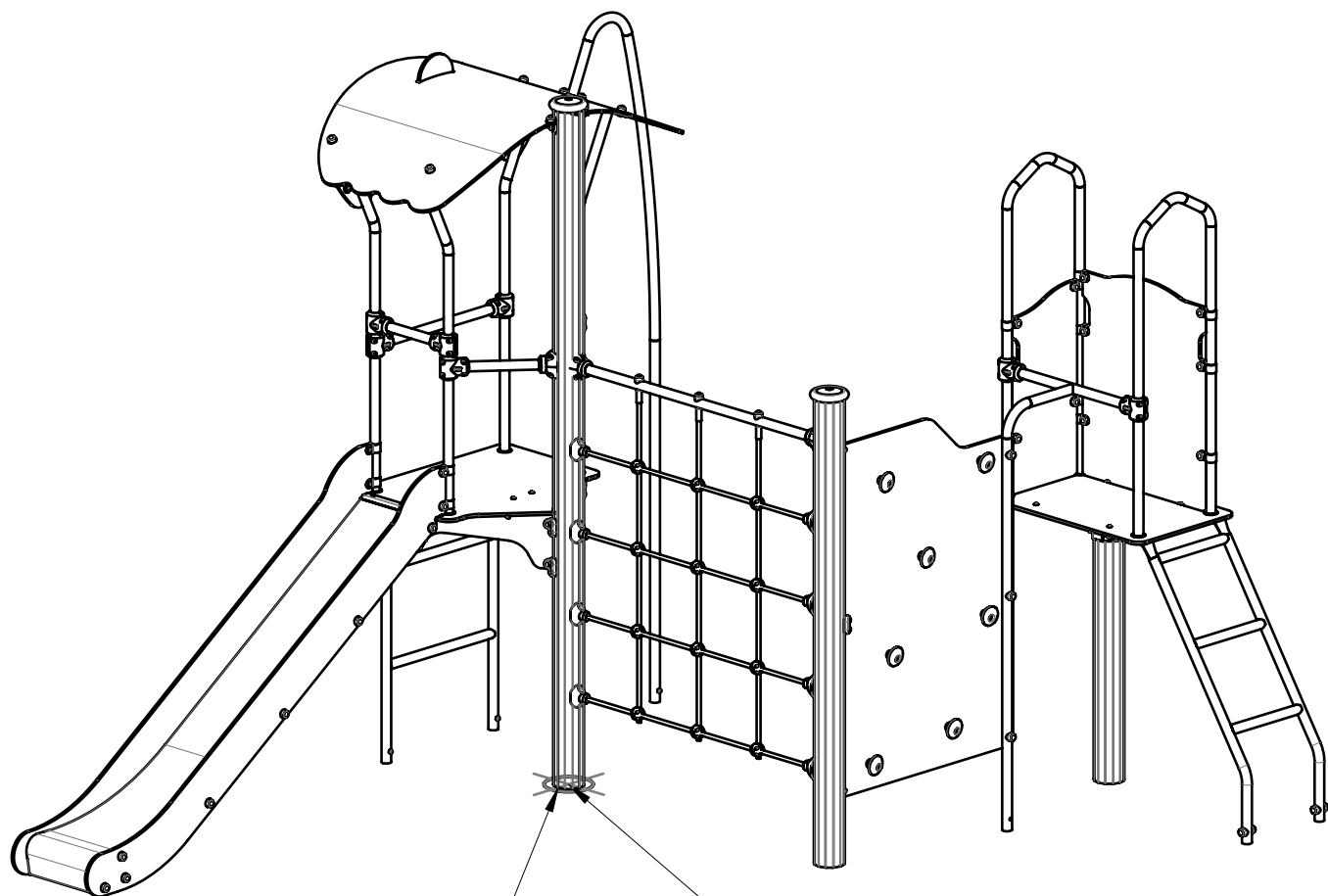

— Zone d'impact
 Impact area
 Area de impacto
 Fallraum
 Valzone

37 m²

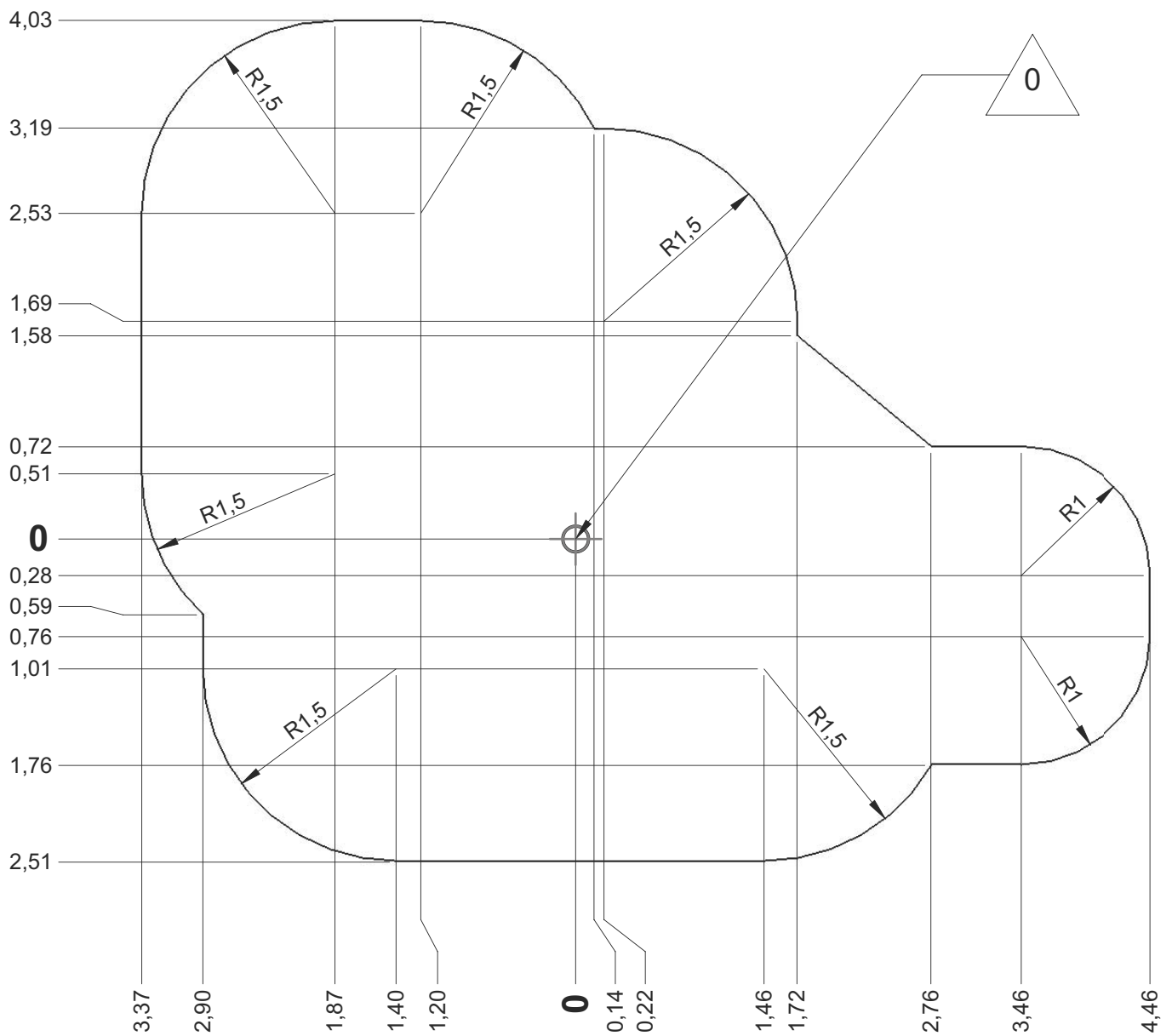

— Sol souple
Wetpour
Caucho continuo
Synthetischer fallschutz
Gietvloer

37 m²

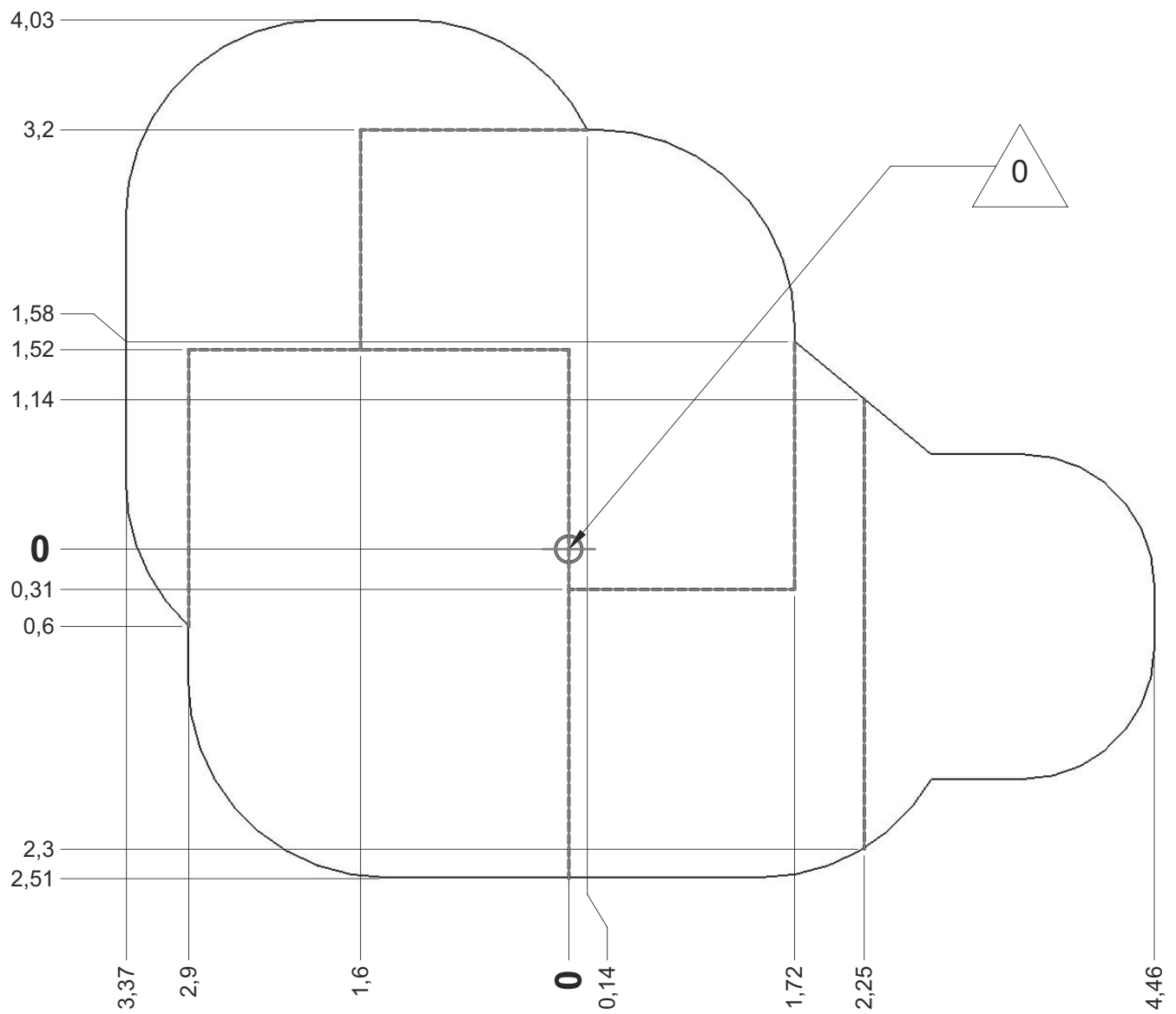

— Dalle béton
Concrete pad
Solera de hormigon
Beton bodenplatte
Betonnen bodemplaat

26 m
39 m²

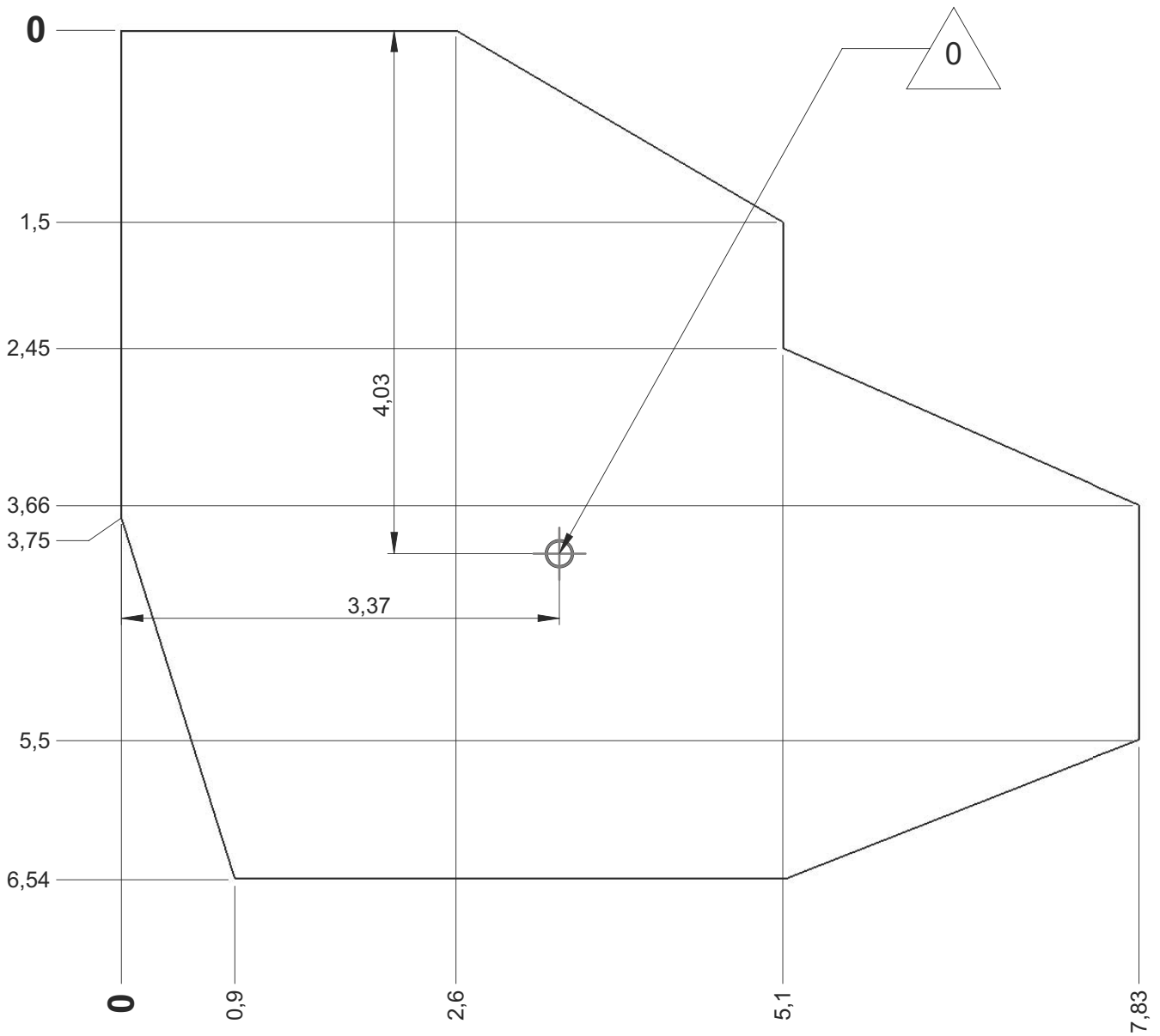

— Sol fluent
Loos partucule material
Arenero
Loses Bodenmaterial
Los bodemmateriaal

30 m
48 m²

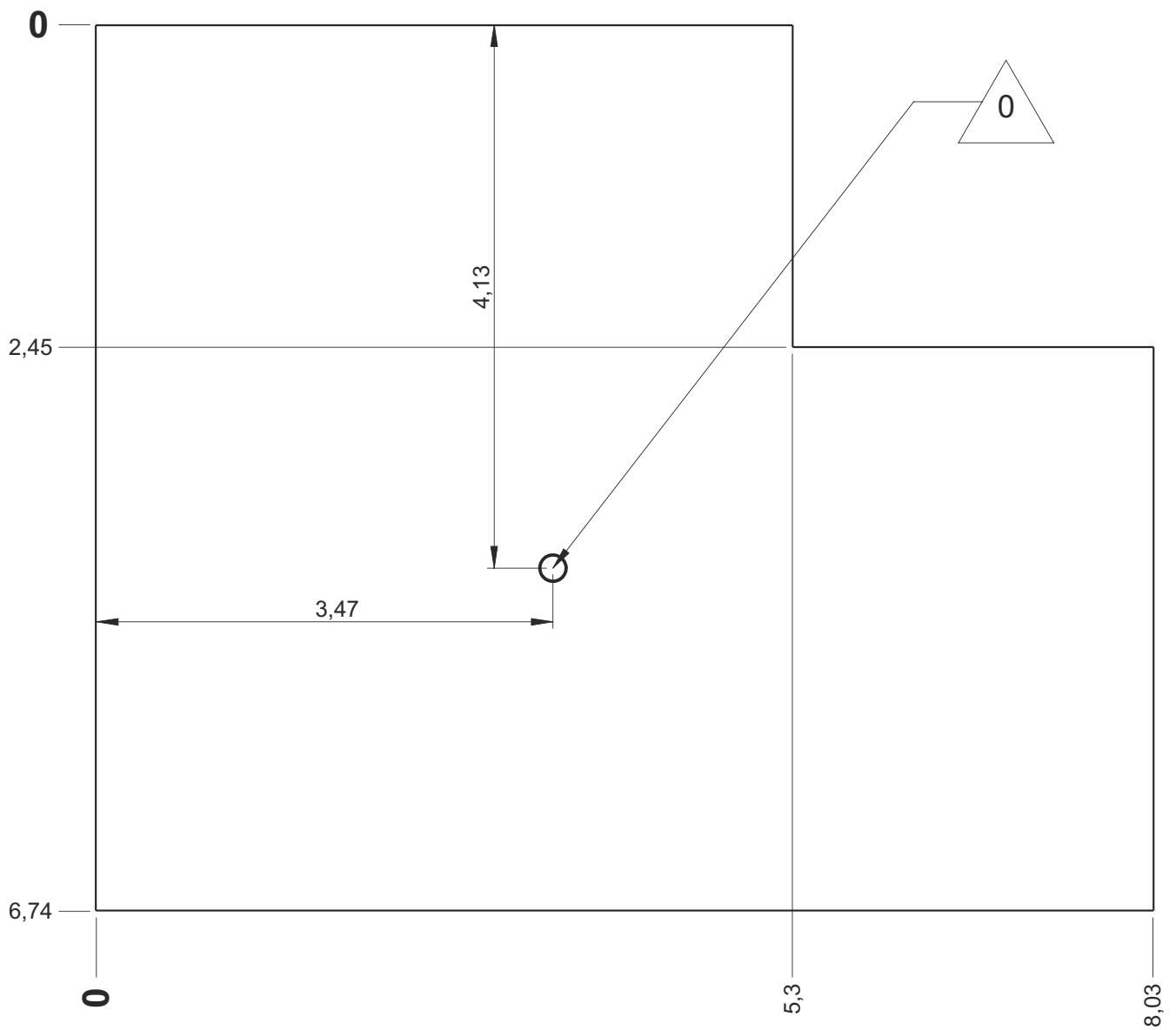

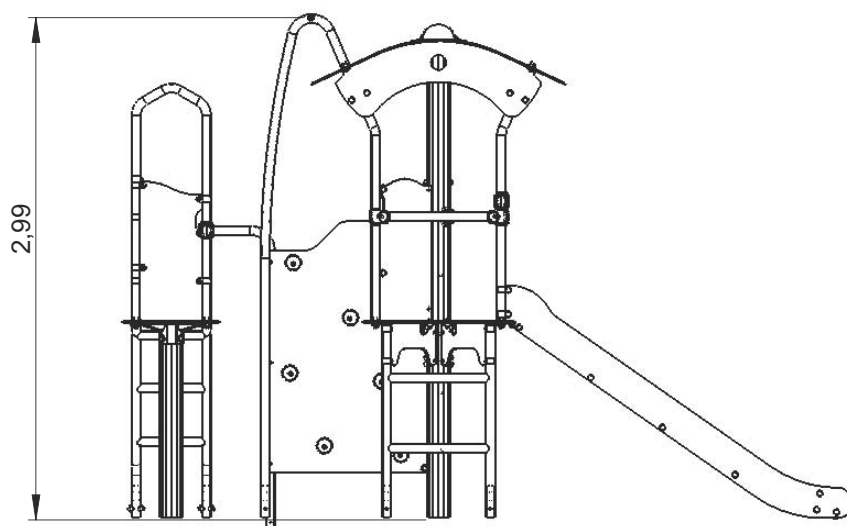
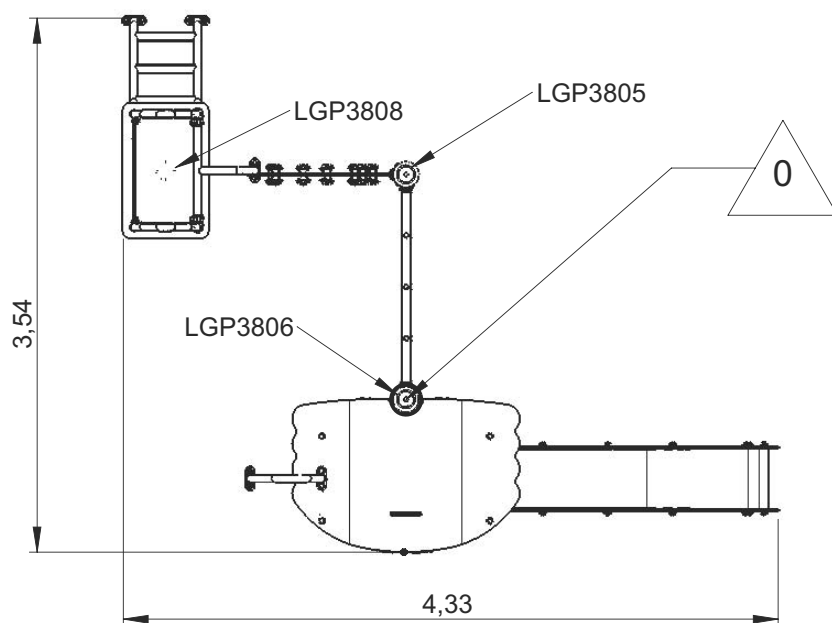
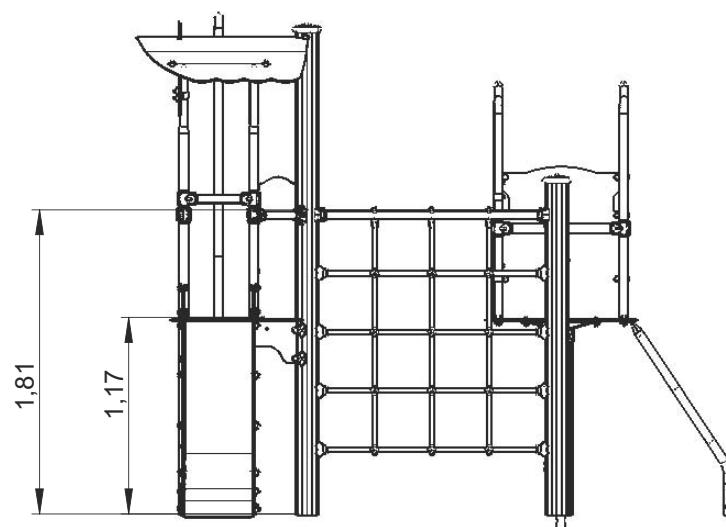

Implantation
 Footing plan
 Implantación
 Fundomentplan
 Funderingstekening

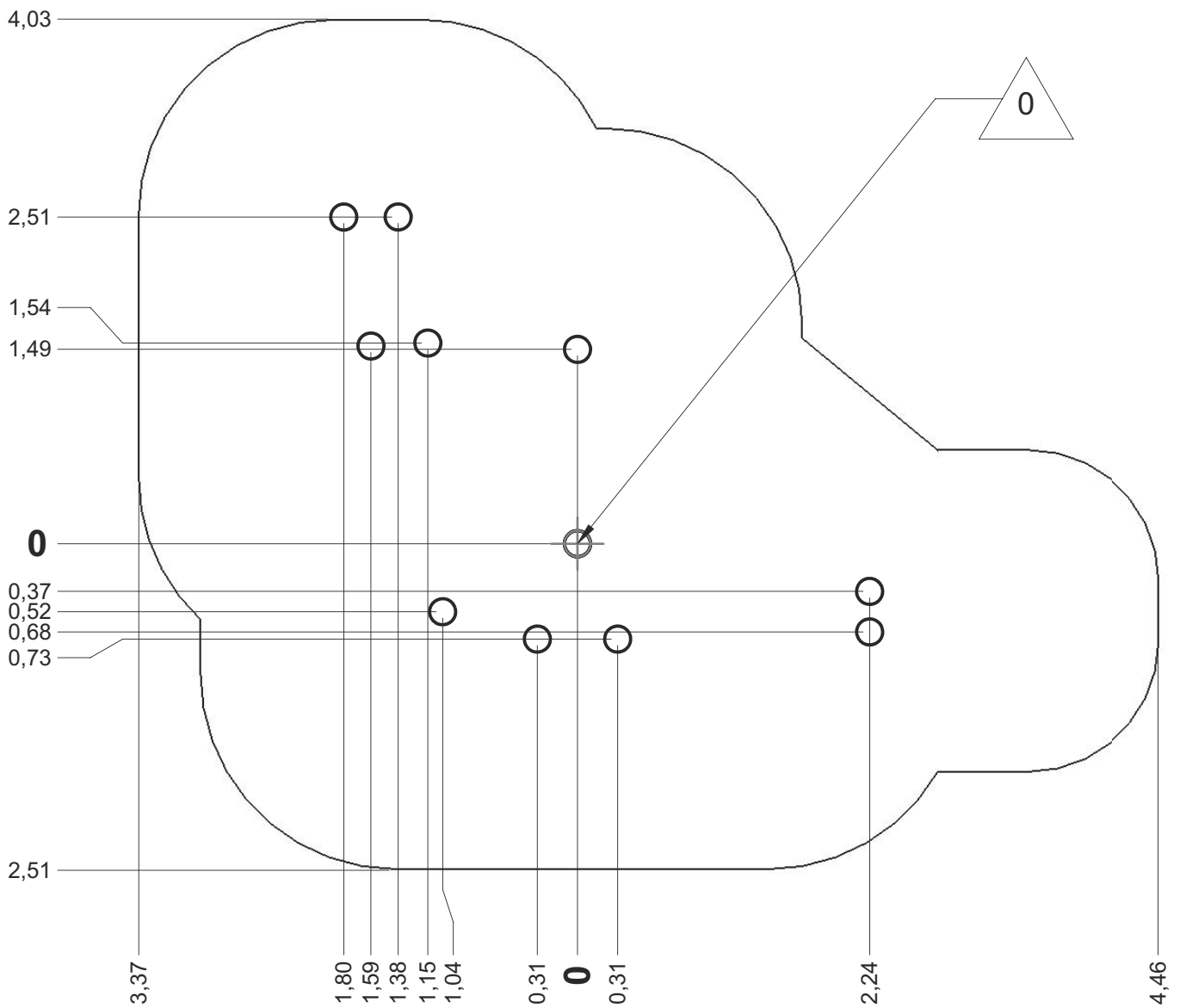

 x2	 12H	 RD14M10
---	---	---

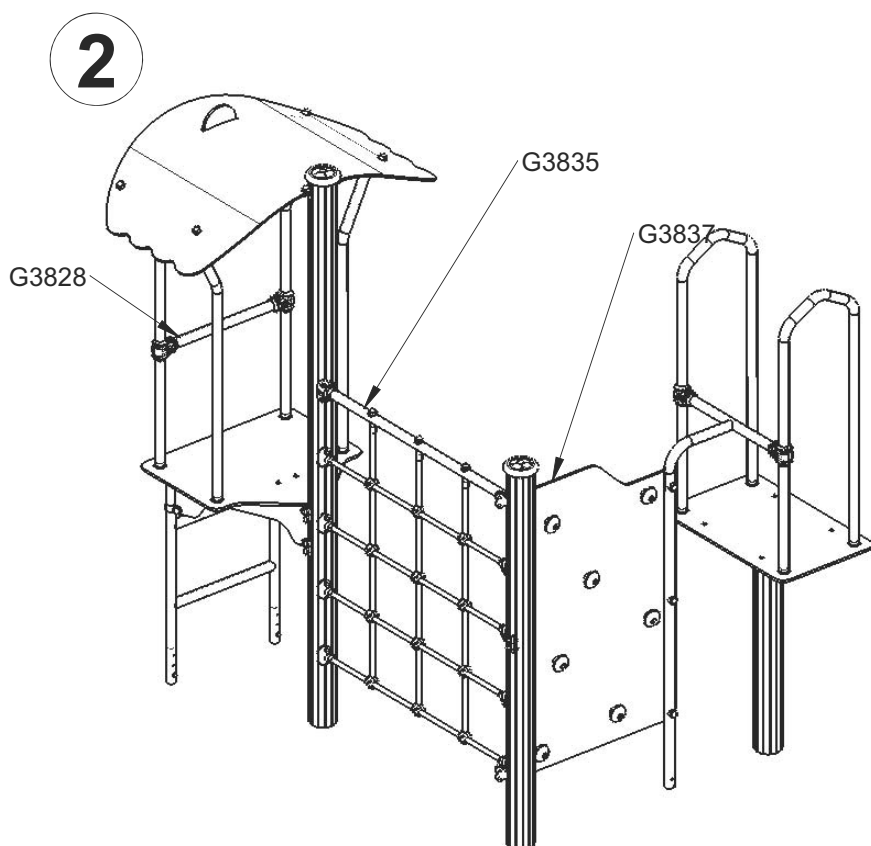
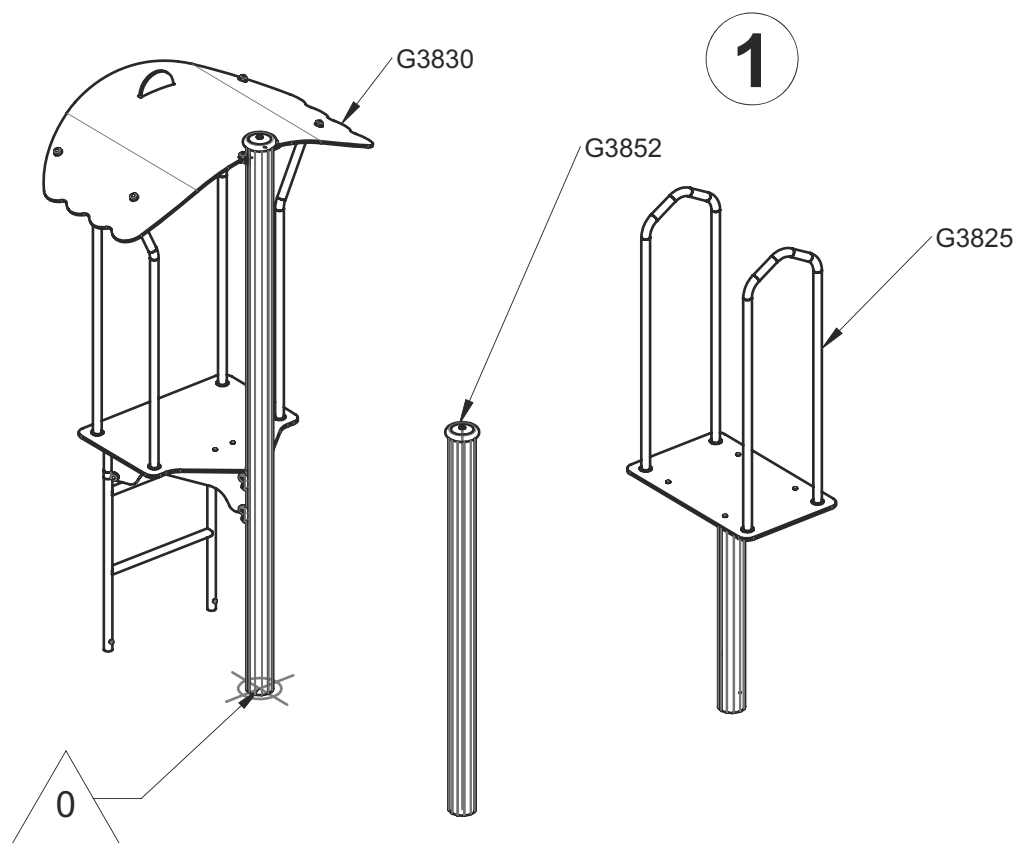

3

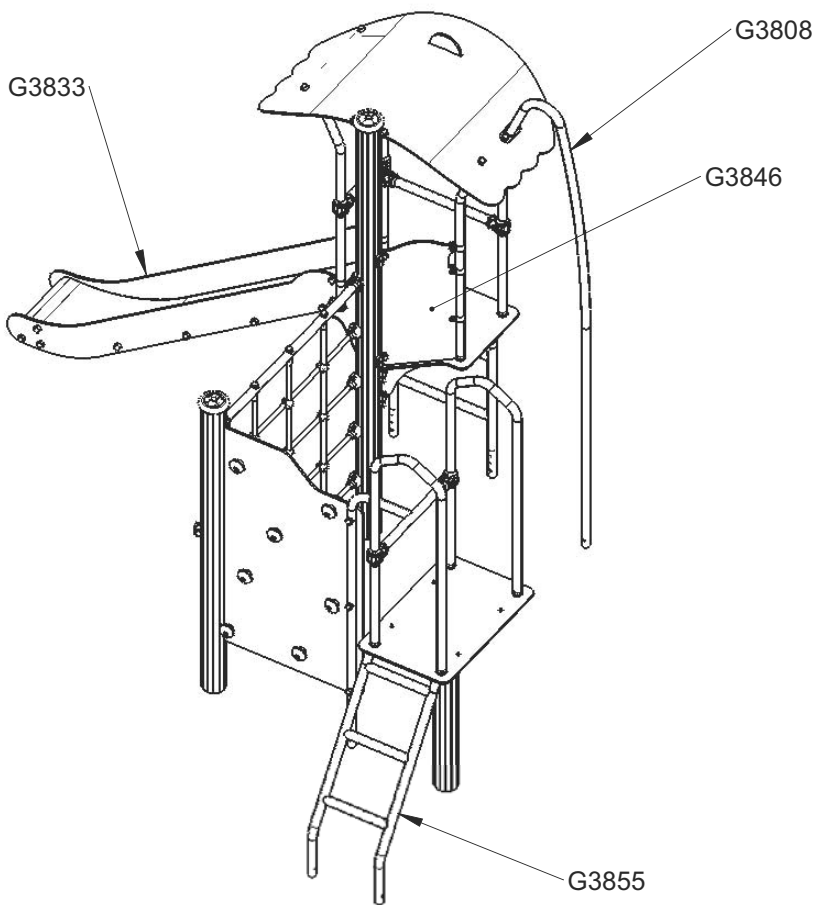

4

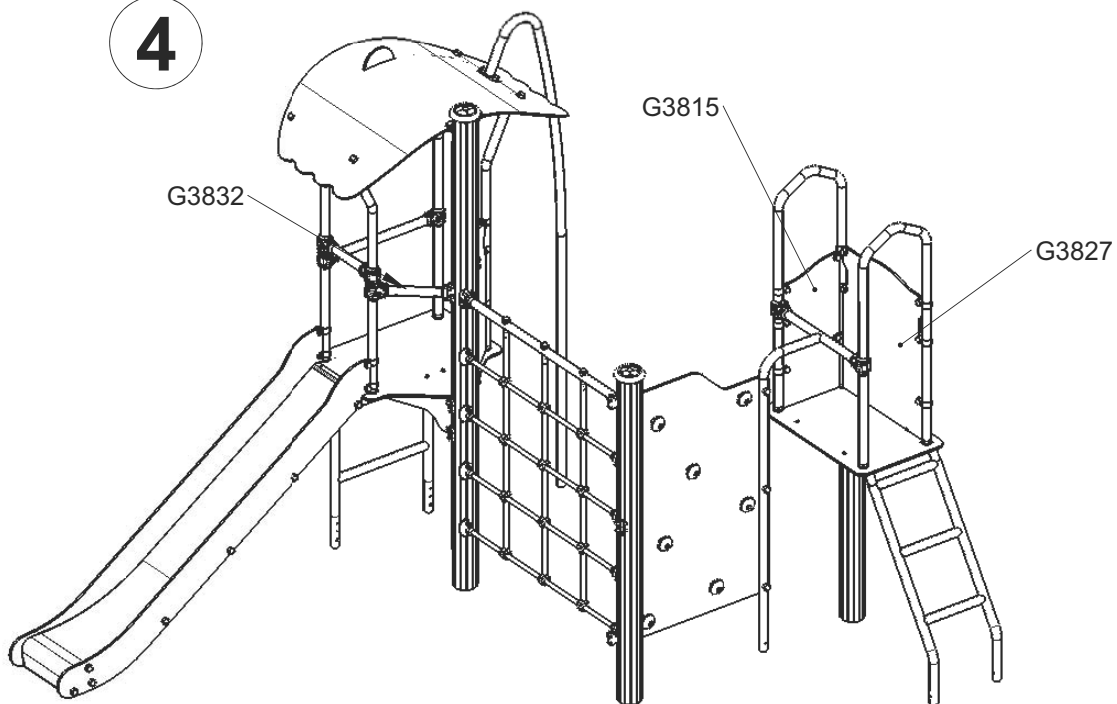

Réf	Qté
G3808	1
G3815	1
G3825	1
G3827	1
G3828	1
G3846	1
G3830	1
G3833	1
G3832	1
G3837	1
G3852	1
G3835	1
G3855	1

B

Proludic

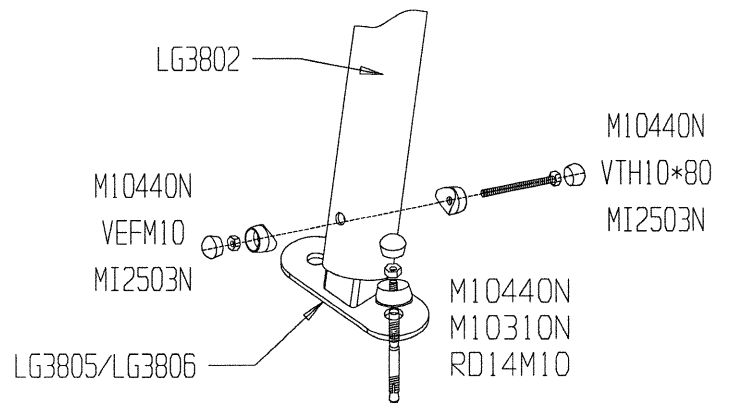
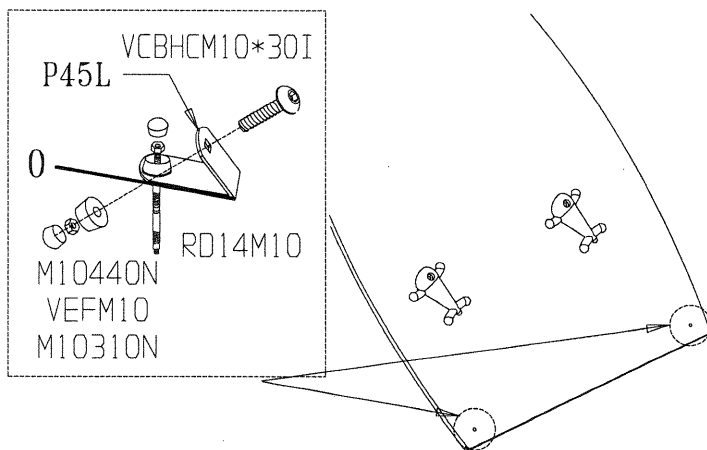
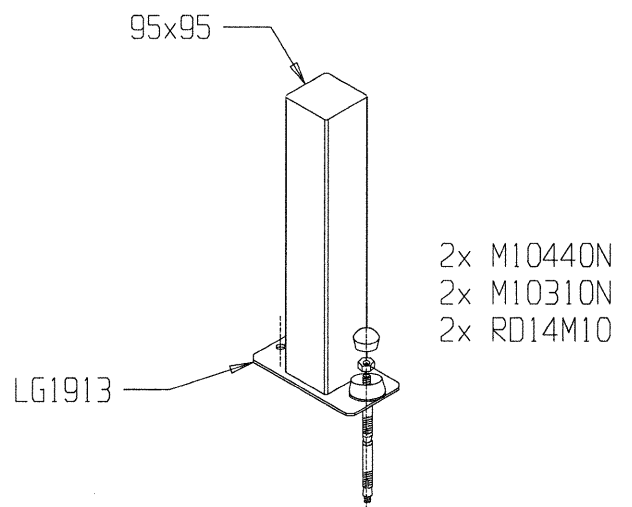
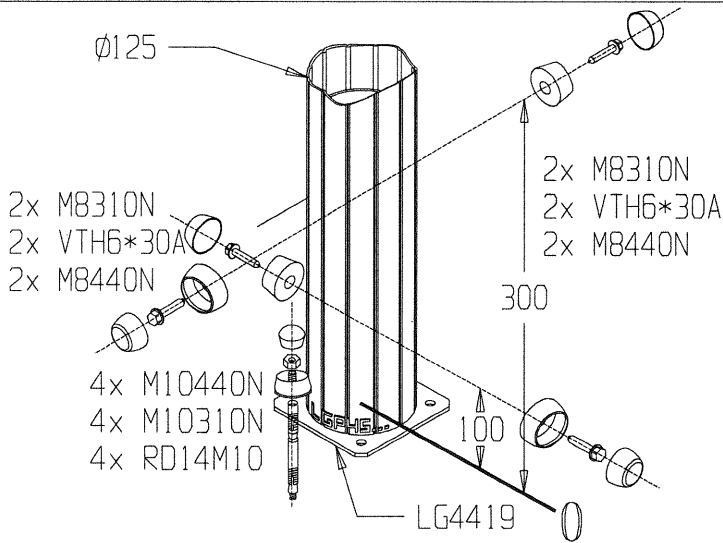
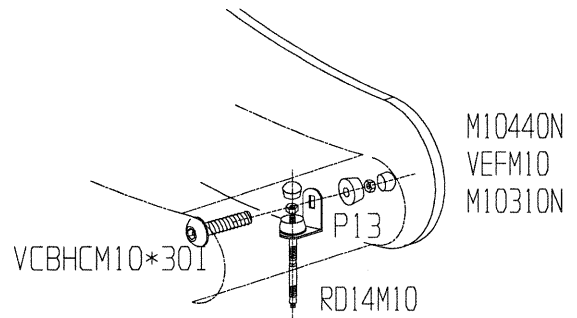
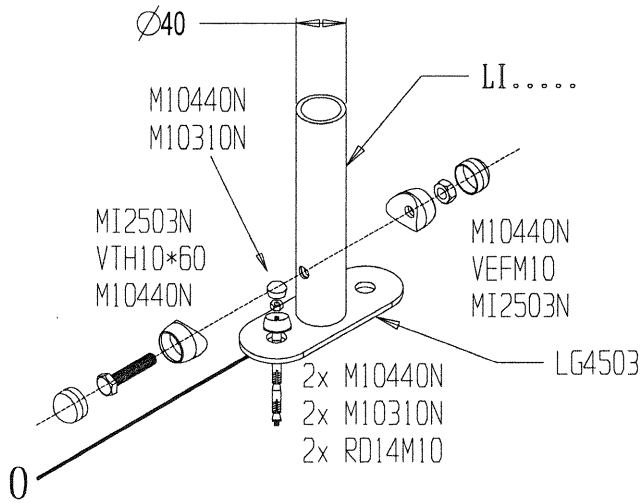
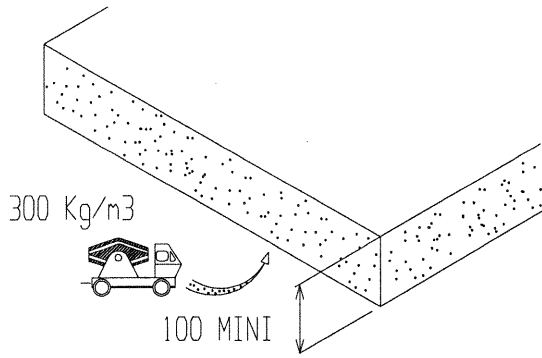

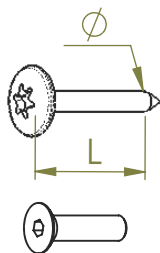

VBT 6 x 30
 \varnothing \uparrow L (mm)

VFHC



VEC M10
 \varnothing



VEF



VEB

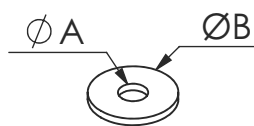

VR6x18
 $\varnothing A$ $\varnothing B$

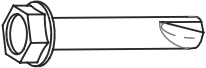

VTHA

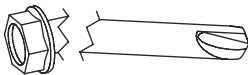
< 14 N.m

Couple de rupture
Breakage torque



1000 - 1800 RPM

Vitesse de rotation
Rotation speed

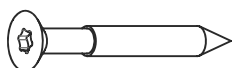

VWT

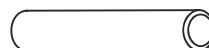

VGC

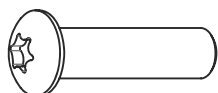

VCBHC

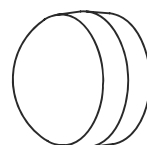

M10 440N

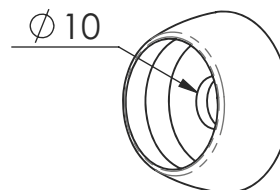

M10 310 N

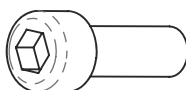

VBTR

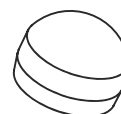

M8440N

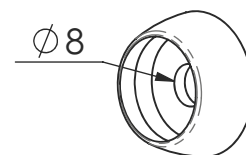

M8310N

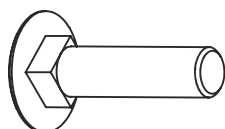

VTRCC

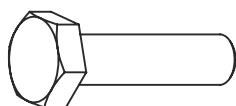

VTH

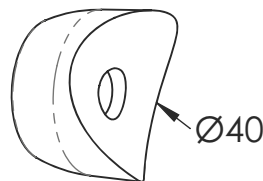

MI2503

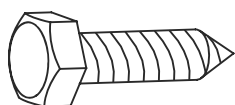

VTF

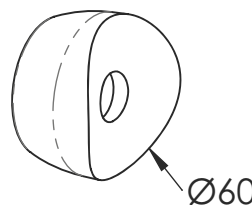

MI2701

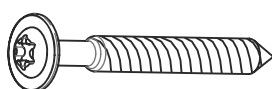

VBT

1

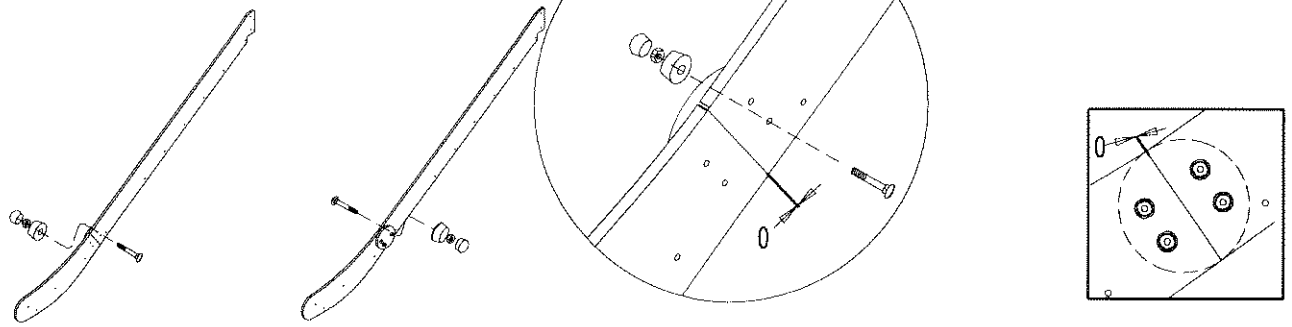

2

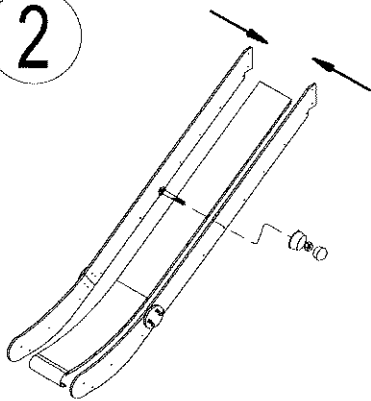

3

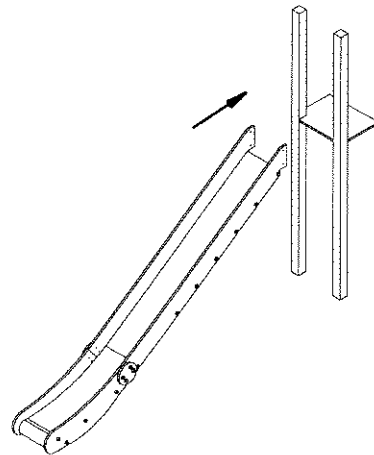

NON
NO

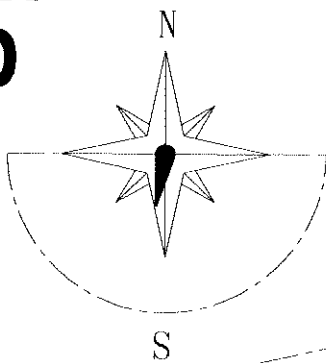

OUI
YES

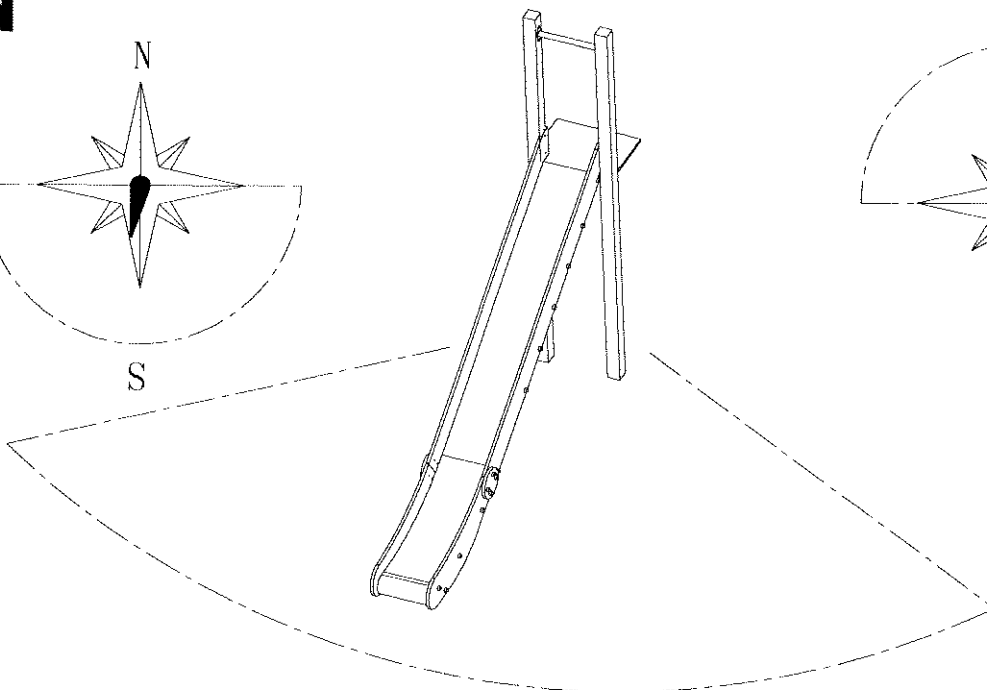
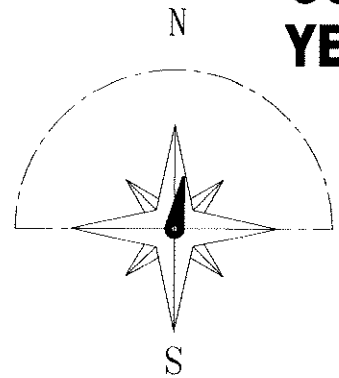

FR

Il est recommandé de ne pas orienter la glissière Sud / Sud Ouest

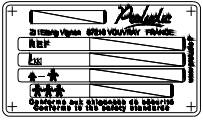

LA000

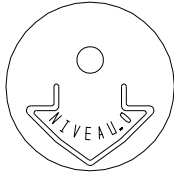

MI0002

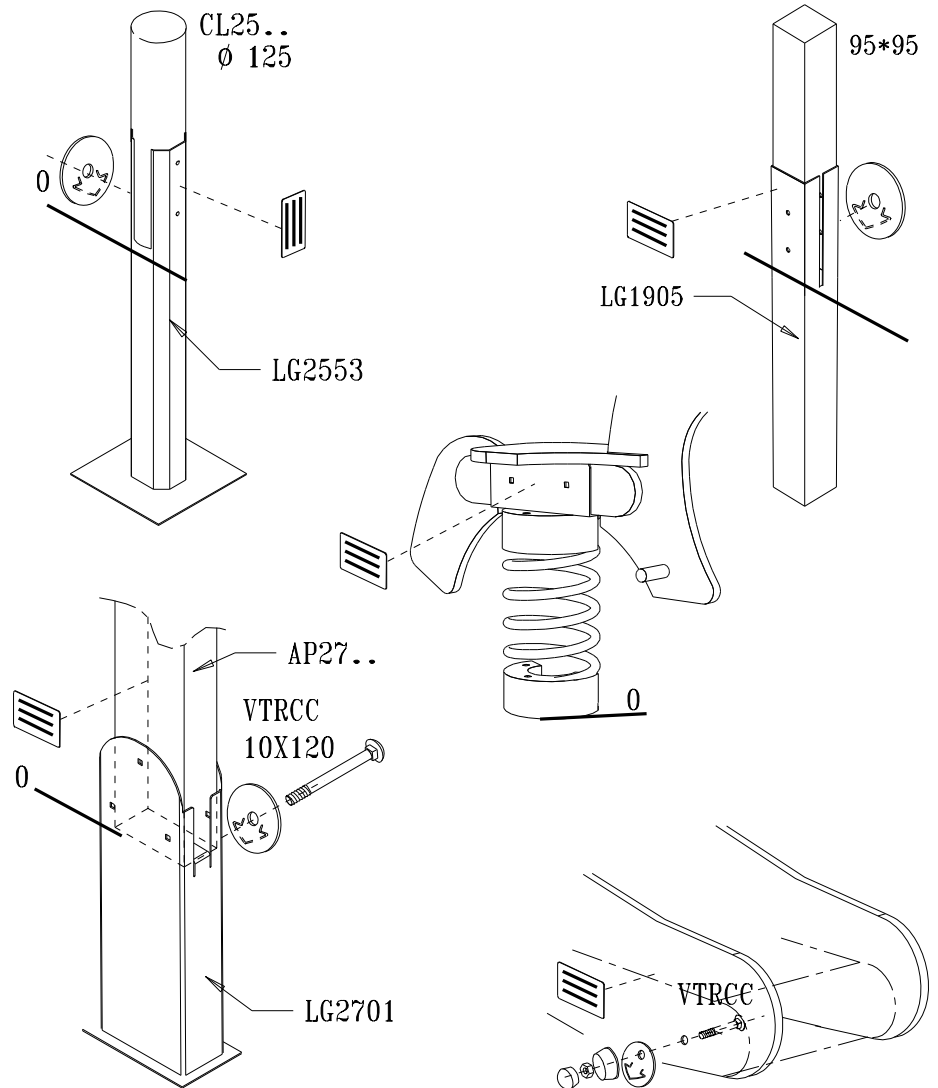
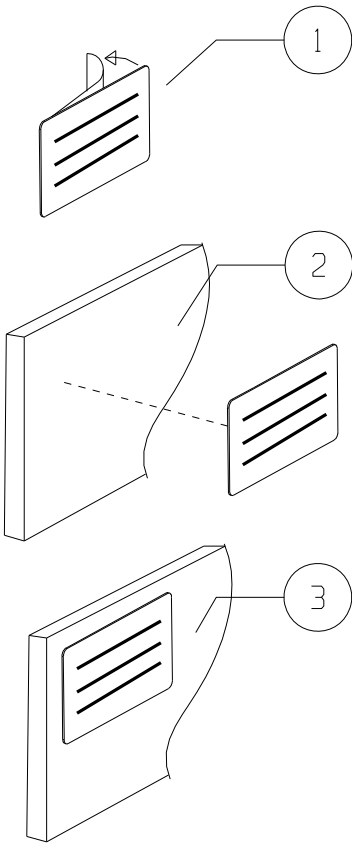
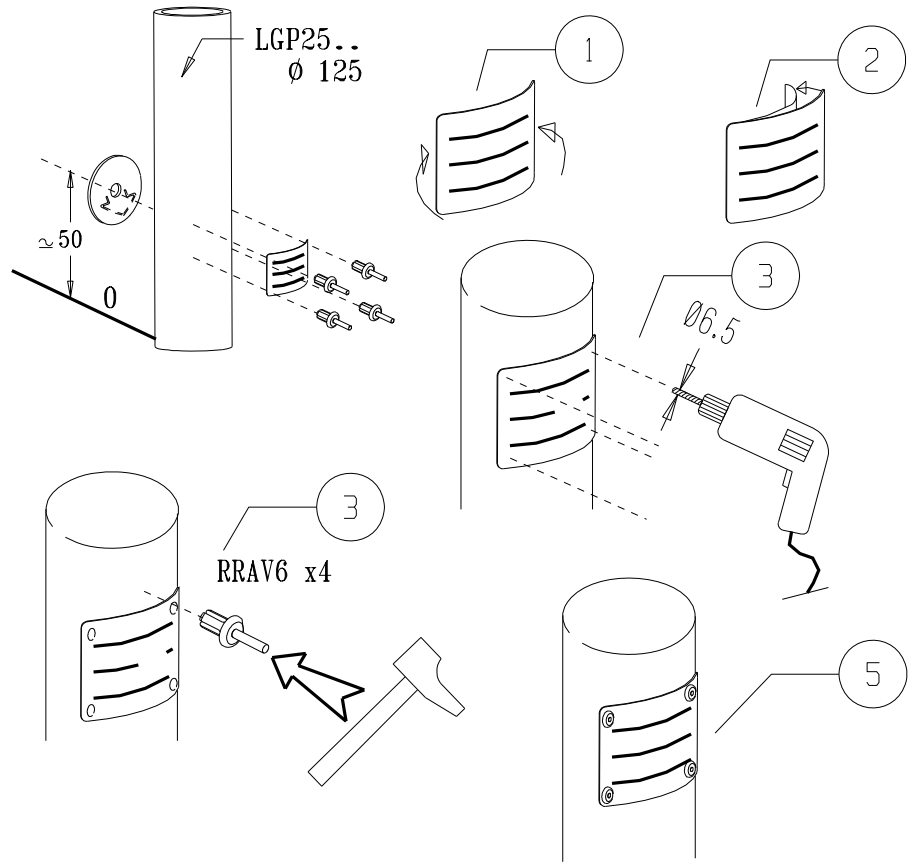

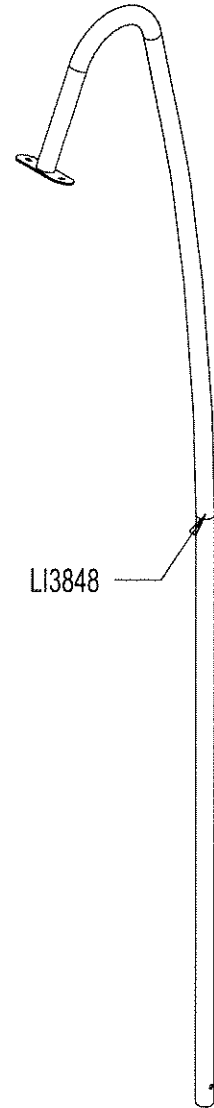
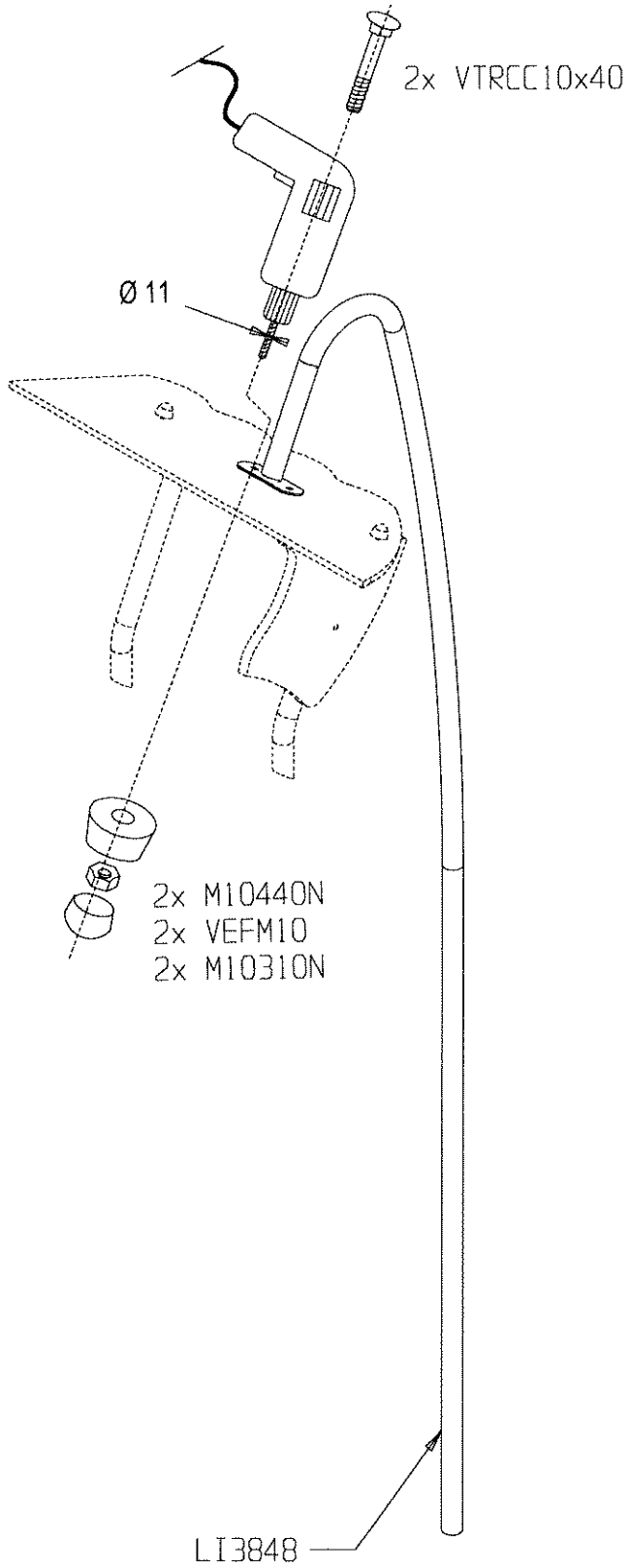

	VTRCC10x40	2
	VEFM10	2
	M10310N	2
	M10440N	2

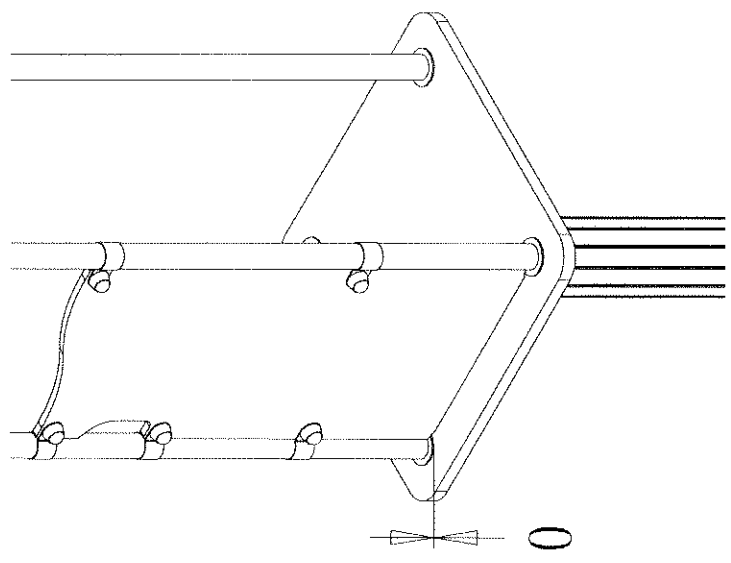
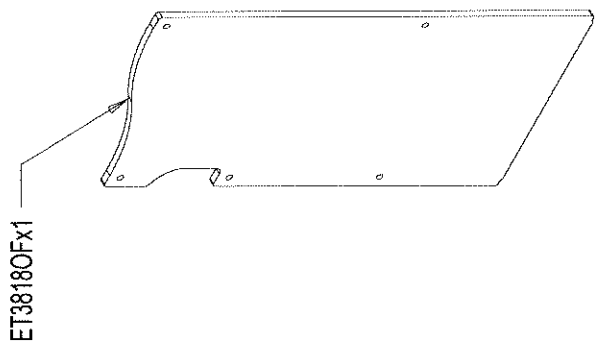
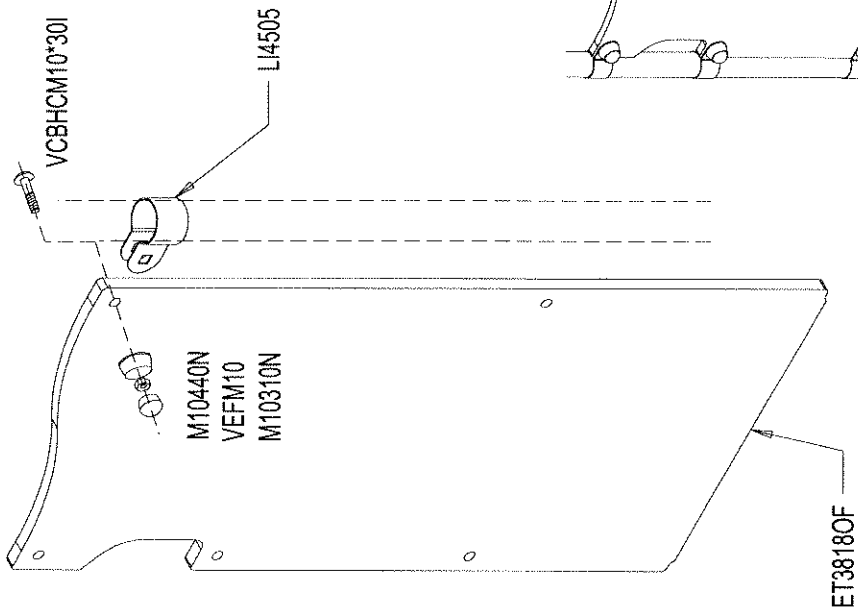

	VEFM10	5
	VCBHCM10*30I	5
	M10310N	5
	M10440N	5
	LI4505	5

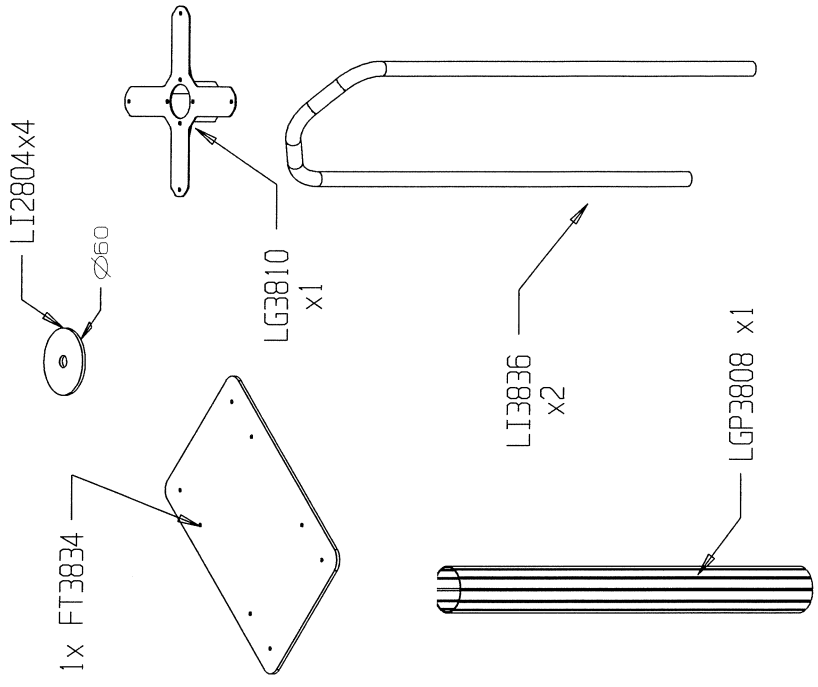
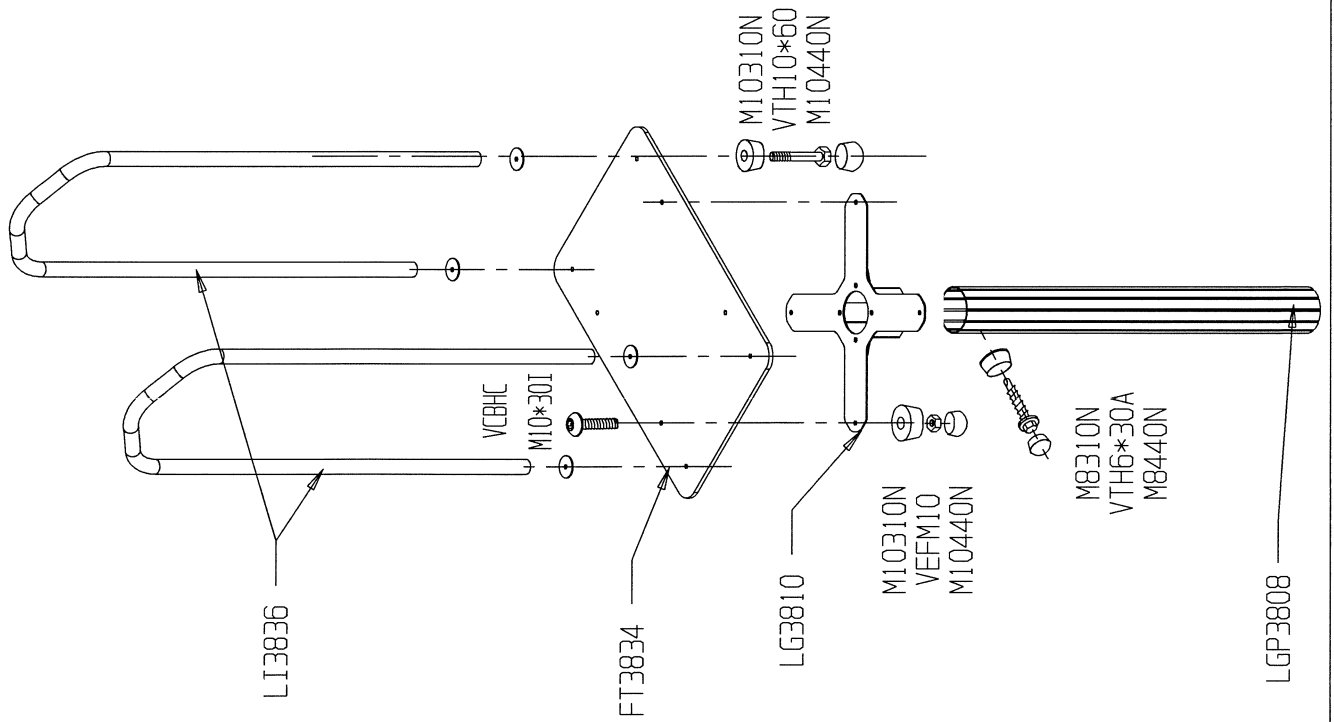

	M831ON	4
	M8440N	4
	VTH6*30A	4
	M1031ON	8
	M10440N	8
	VTH10*60	4
	VCBHC M10*30	4
	VEFM10	4

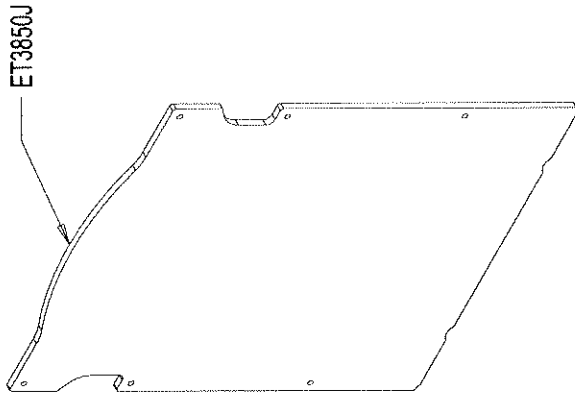
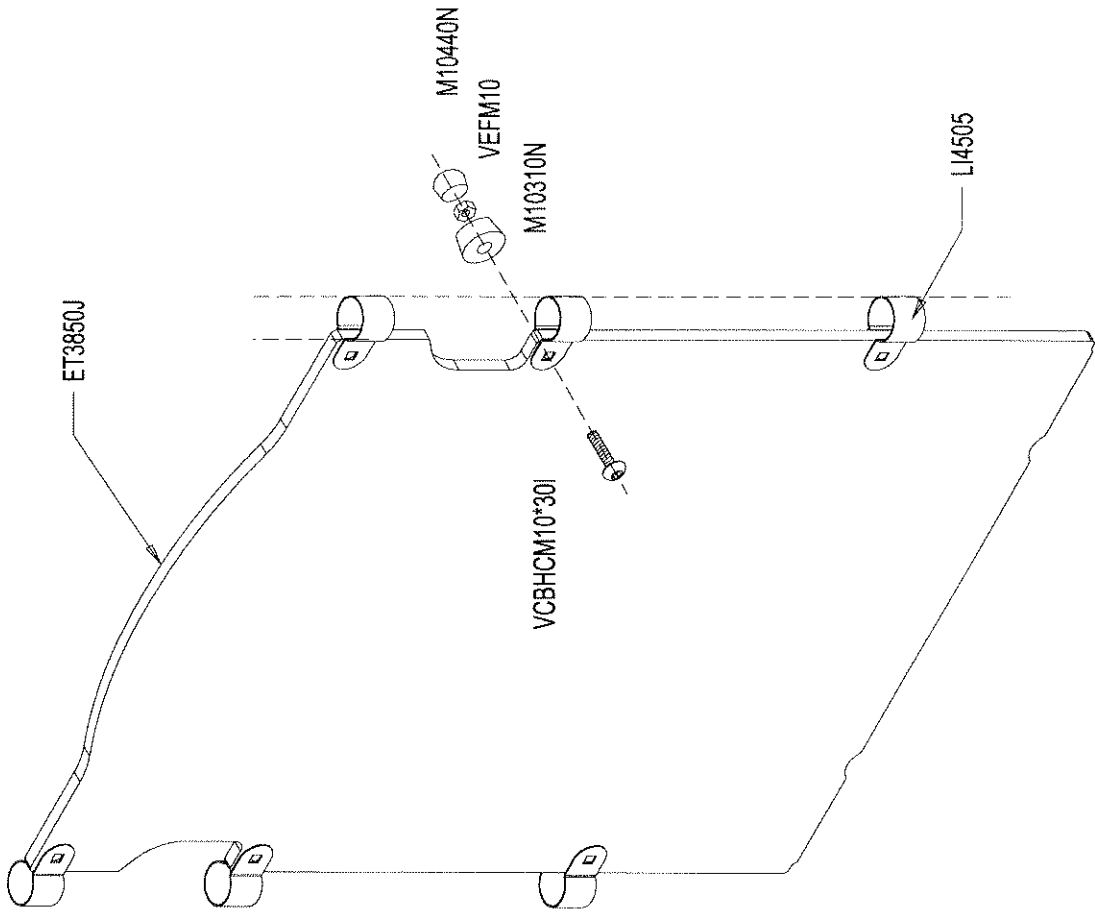

	VEFM10	6
	VCBHCM10*30I	6
	M10310N	6
	M10440N	6
	LI4505	6

63828

HT620 OU HT715

11/01/2011

Proactive

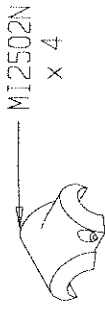
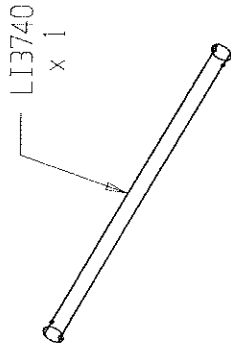
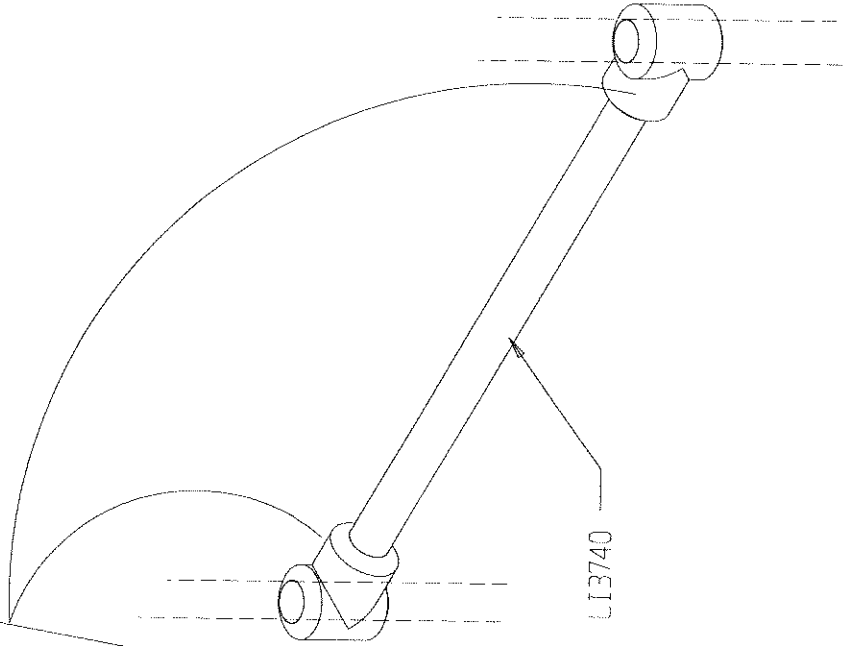
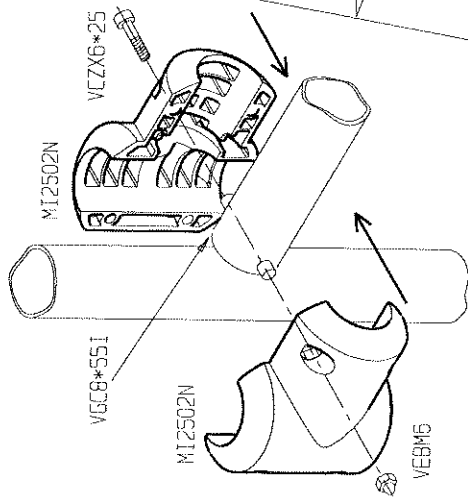

	VEBM6	8
	VCZX 6x25	8

MI4700 X4 LI2610 X2

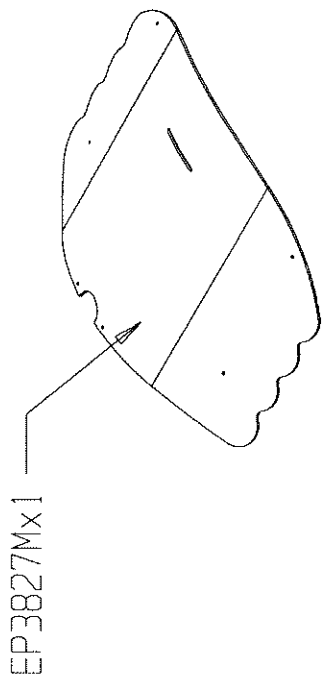
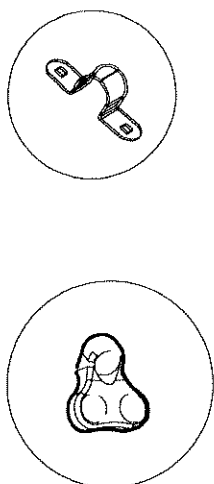

EP3827Mx1

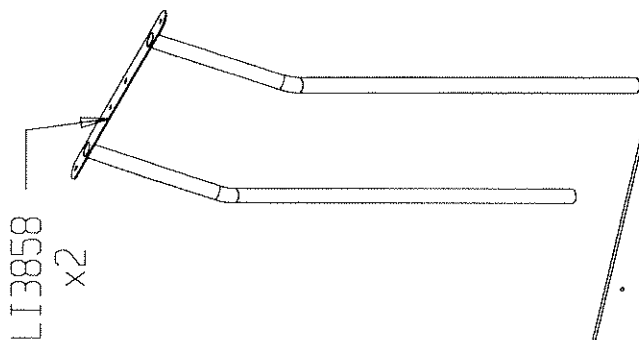

LI3858
x2

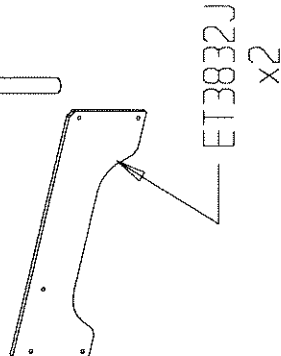

ET3832J
x2

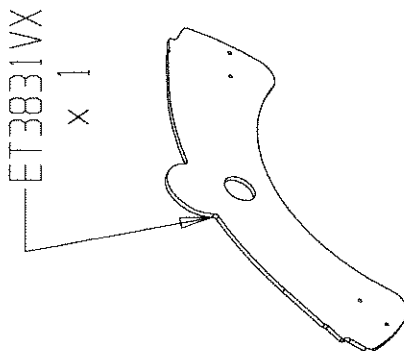

ET3831VX
x1

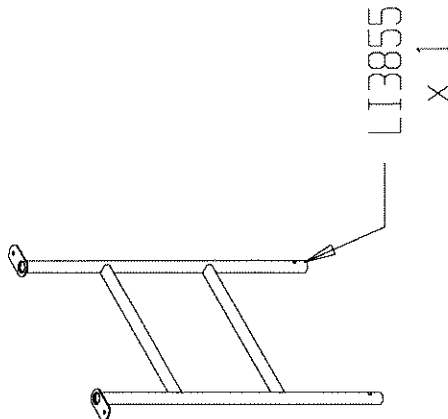

LI3855
x1

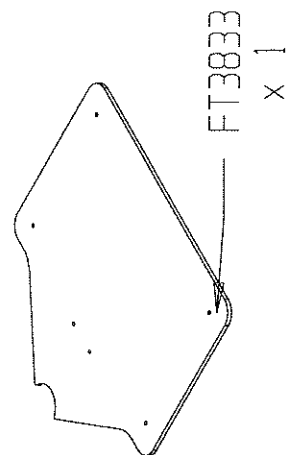

FT3833
x1

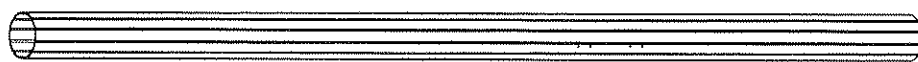

LGP3806
x1



LP3800Nx1



LG4412x1

MI025Nx1

	FHCM6x40	1
	VTRCC10x30	6
	LI4505	4
	VTH 10x60	4
	70 mm : P13	2
	VTH6*30A	10
	VEFM10	22
	VCBHCMI0*30I	16
	MI0310N	22
	MI0440N	35
	M8310N	2
	M8440N	2
	LI2804	4

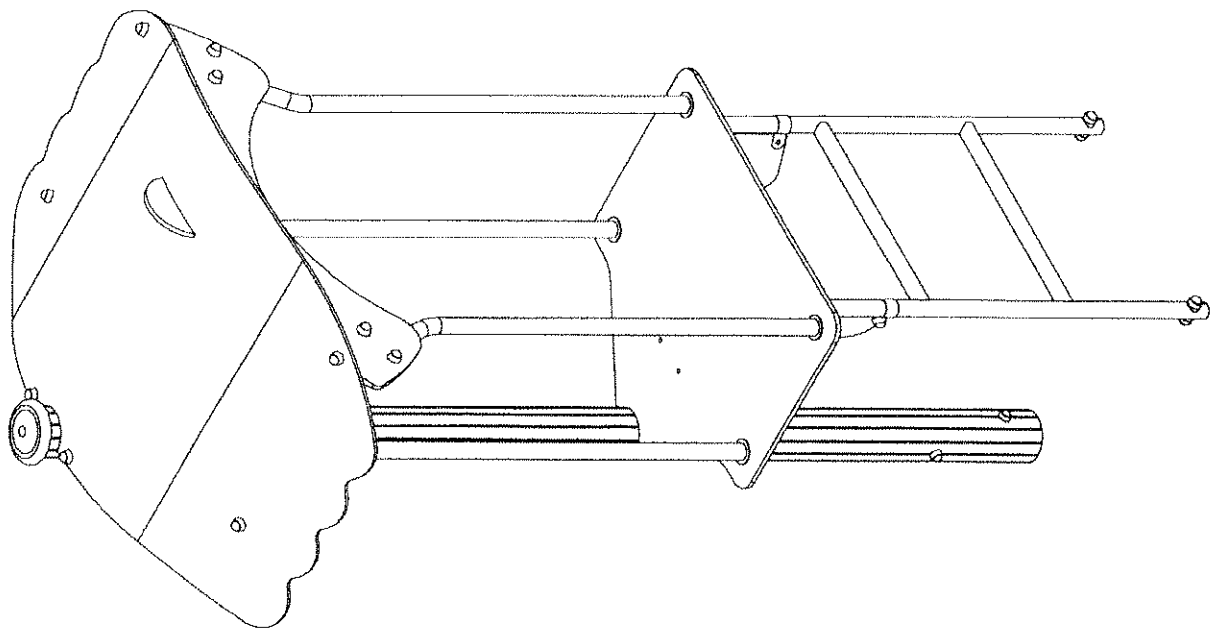
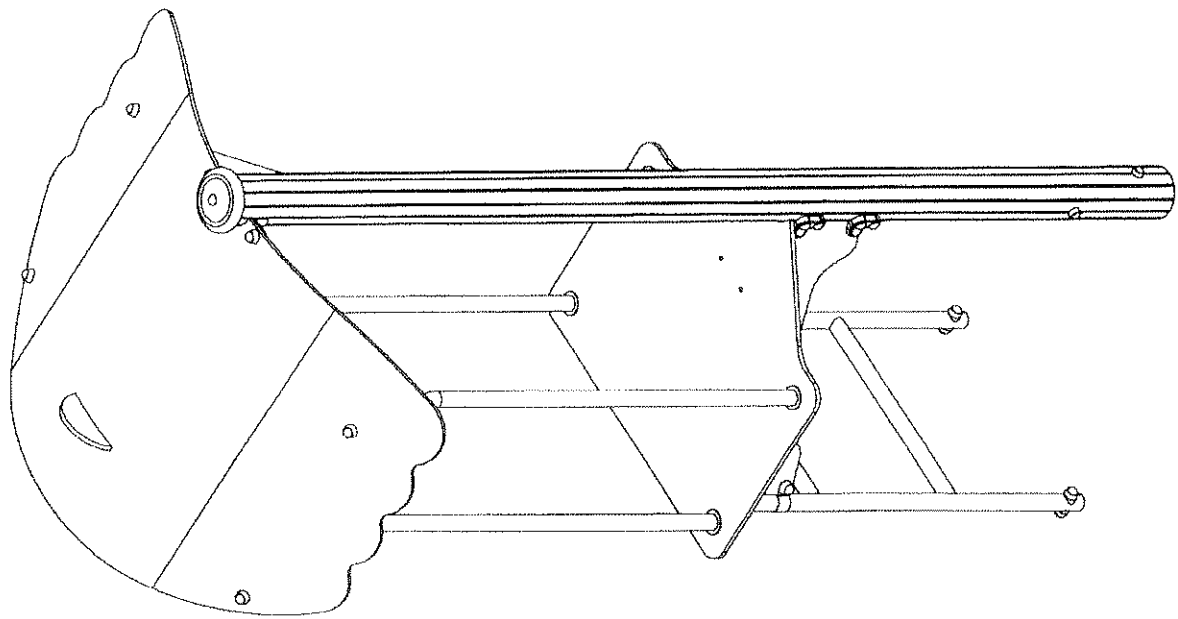

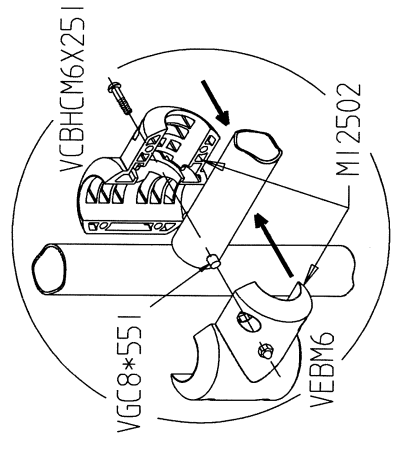
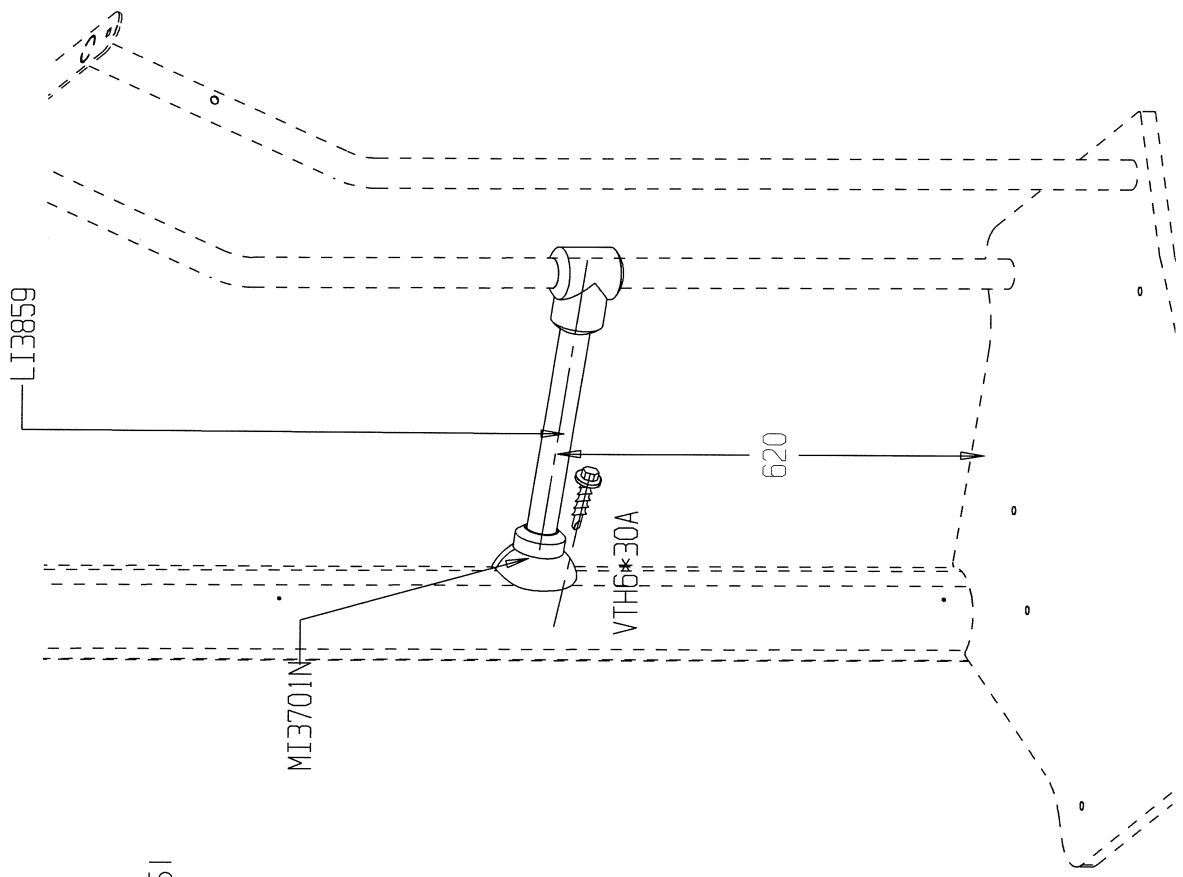
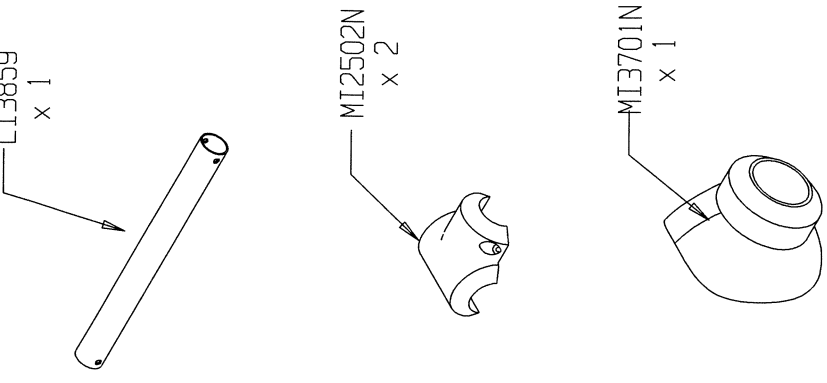

	VGC8*55I	2
	VEBM6	4
	VCBHC6*25I	4
	VTH6*30A	4

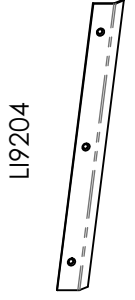
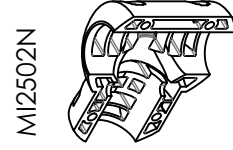
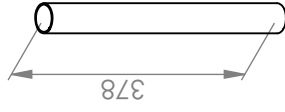
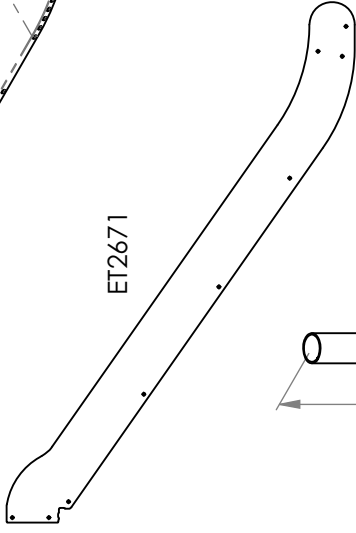
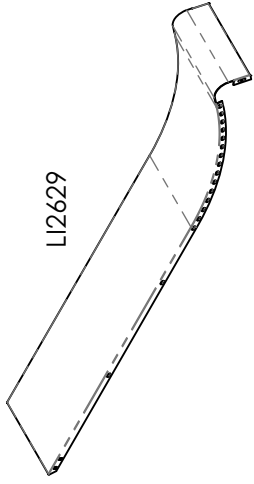
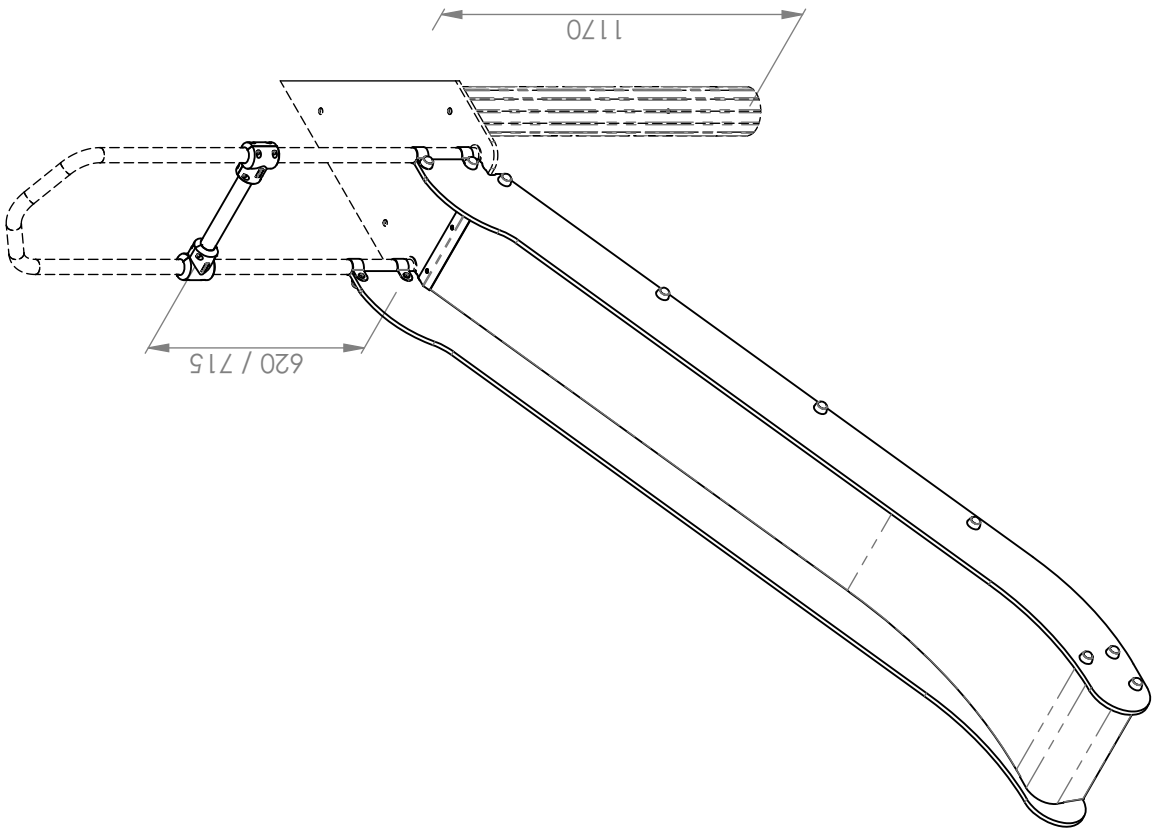

Réf	Qté
ET2671J	2
LI2629	1
LI3838	1
LI9204	1
M10310N	16
M10440N	16
MI2502N	4
VCBHC6M6x25I	8
VCBHC6M10x30I	16
VEFM5	3
VEFM10	16
VEBM6	8
M8310N	3
M8440N	3
LI4505	4
VFHCM5x30	3
VR6x18	3

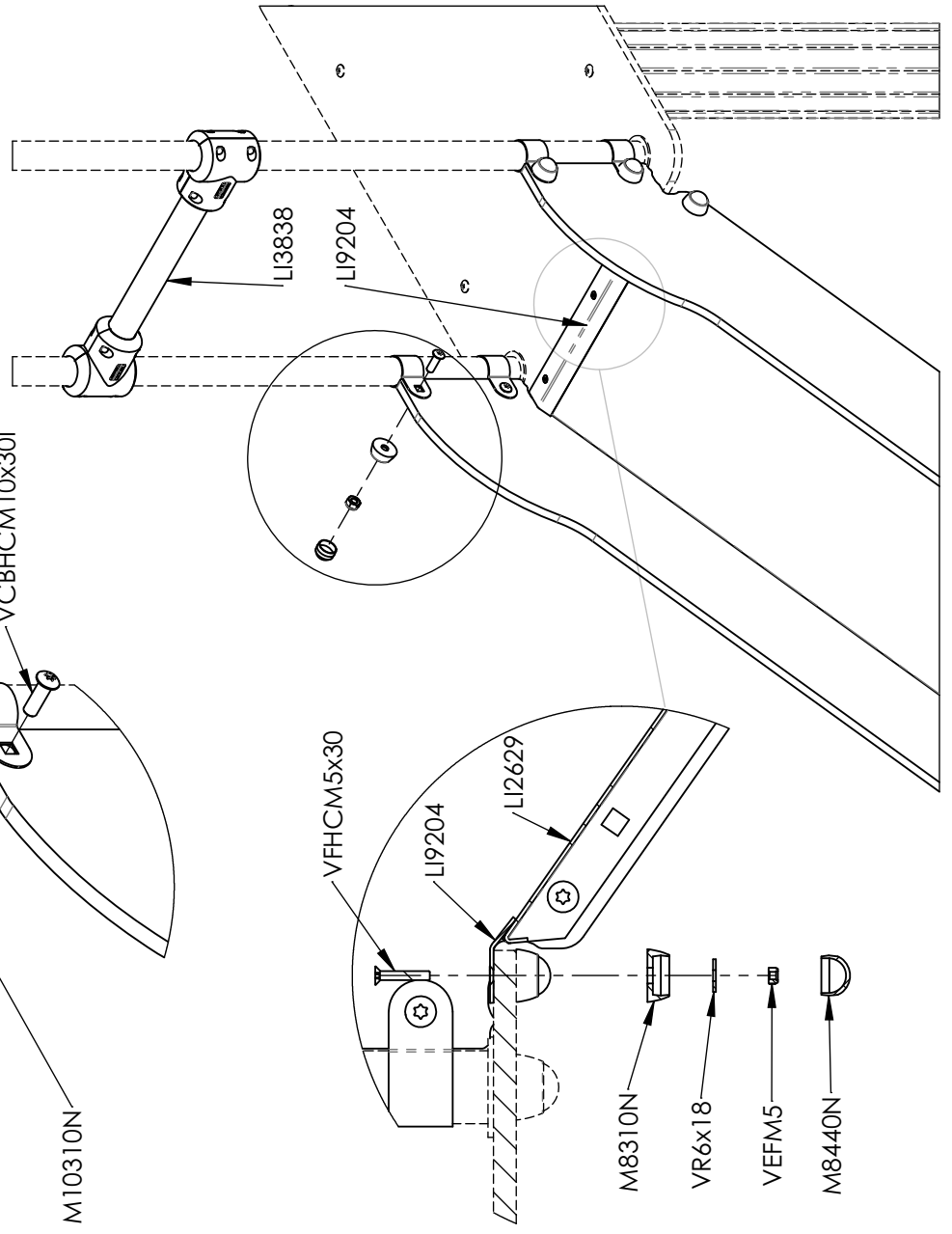
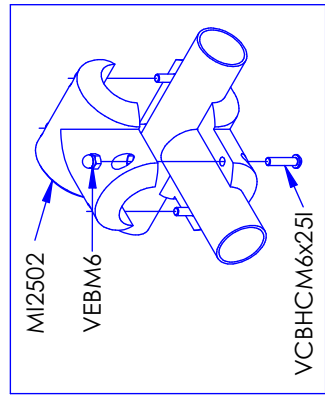
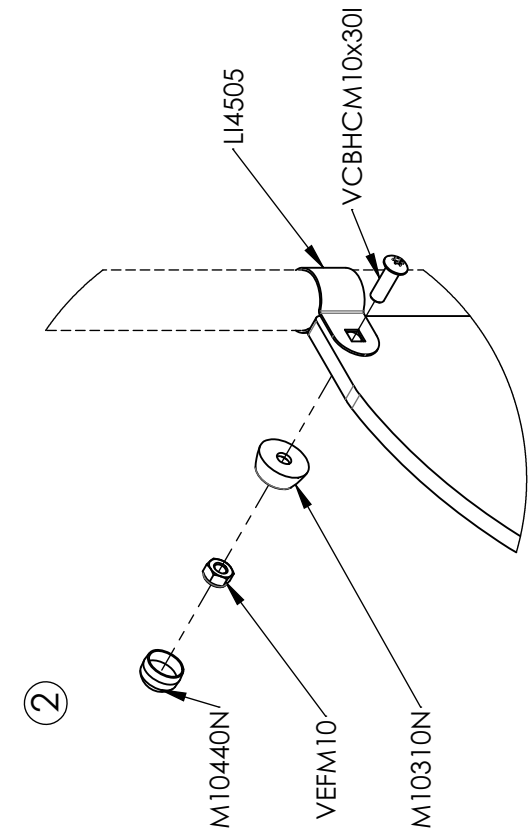
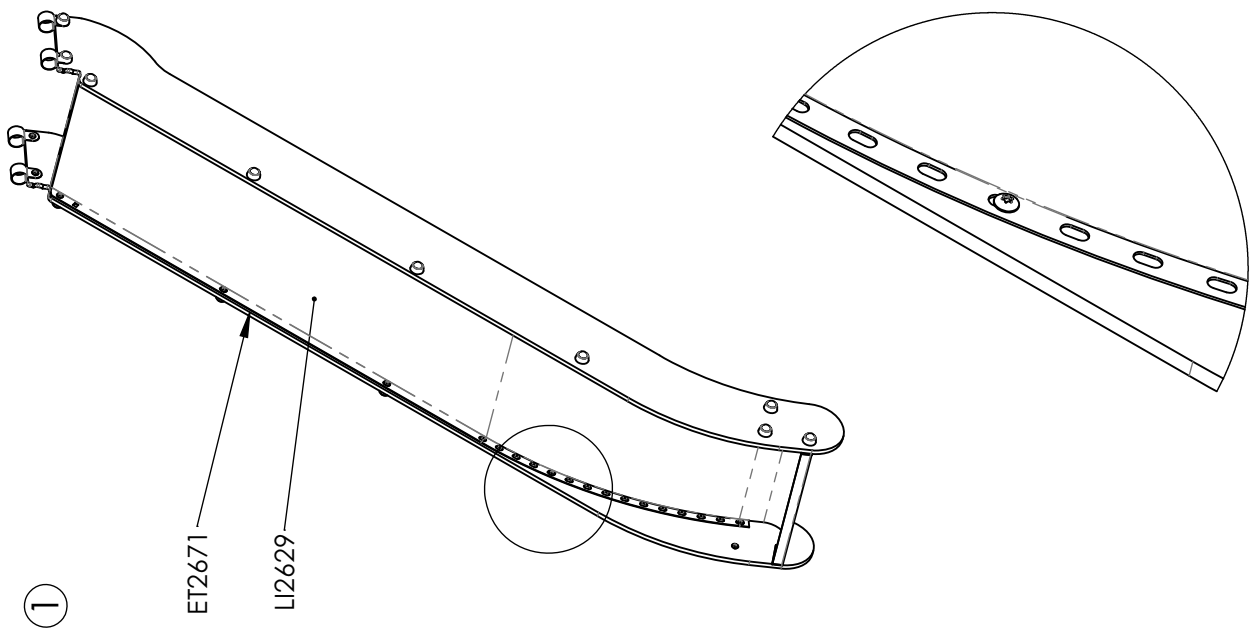

1

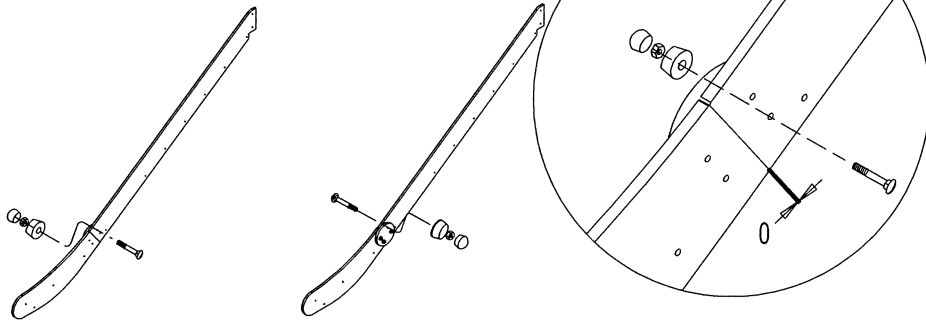

2

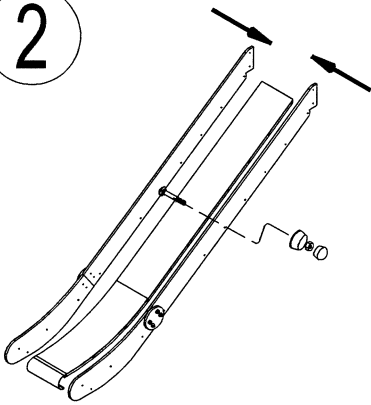

3

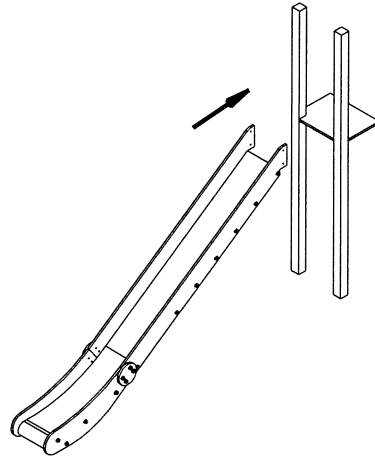

NON
NO

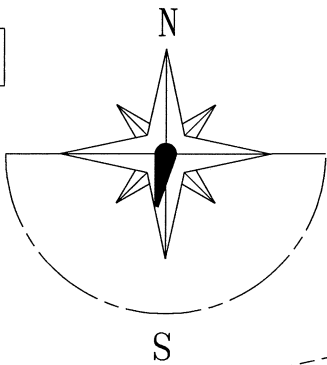

OUI
YES

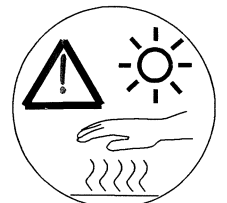
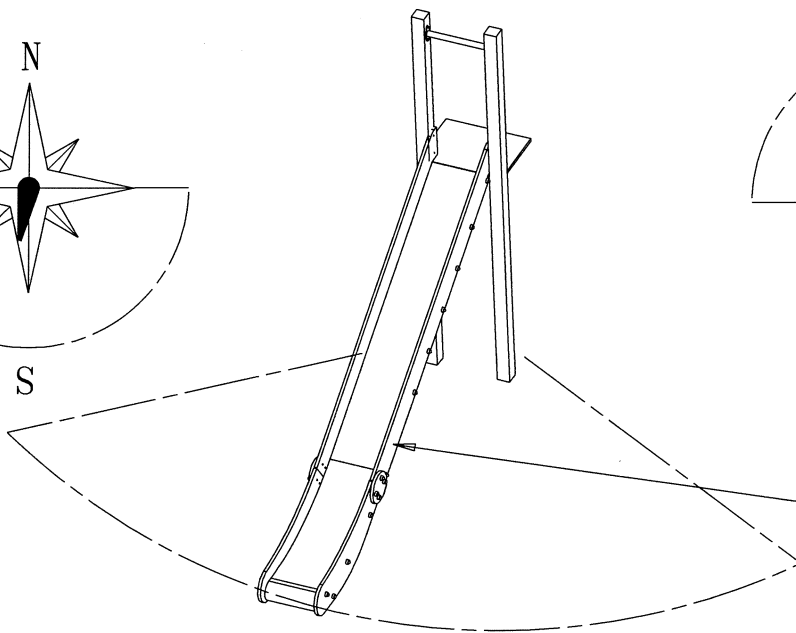
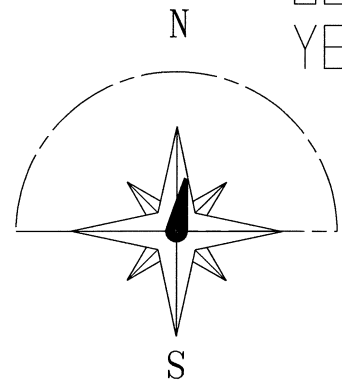

STOBG

FR

Il est recommandé de ne pas orienter la glissière Sud / Sud Ouest

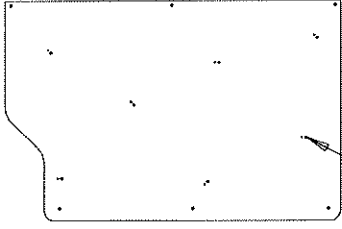
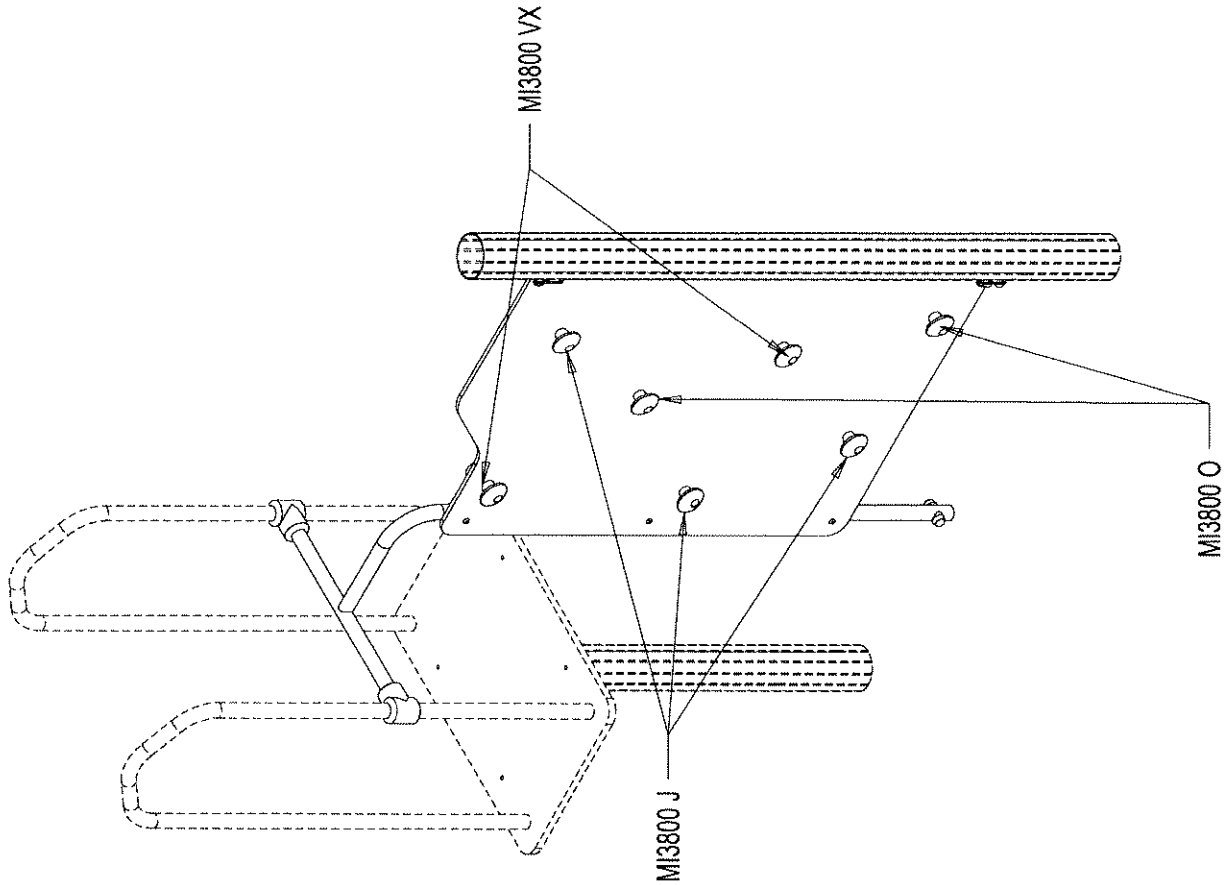

FT3839
x1

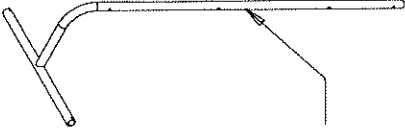

LI3868
x1

MI14700 X 3

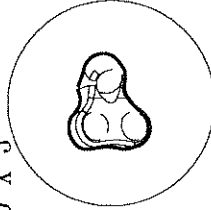

- MI3800 VX X4
- MI3800 J X6
- MI3800 O X4

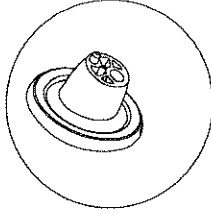

MI2502N x2

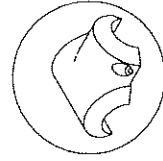

	M2503N	3
	VTH6*30A	6
	VCBHC10*30I	3
	M10310	6
	M10440	26
	VEFM10	13
	VCZX 6x25	8
	VEBM6	8
	VCBHC10*70I	3
	VTRCC10x100	7

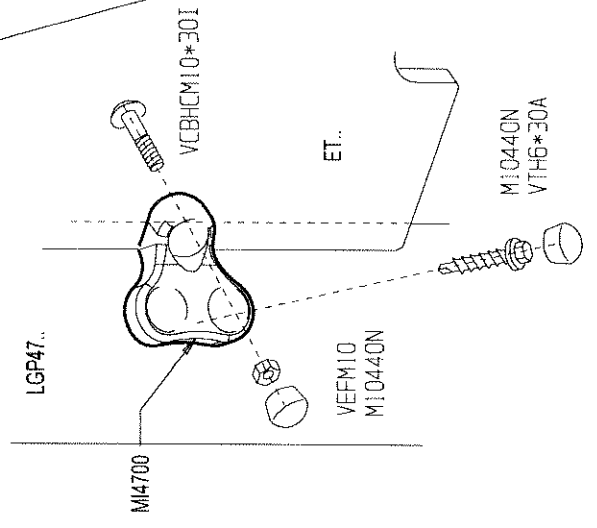
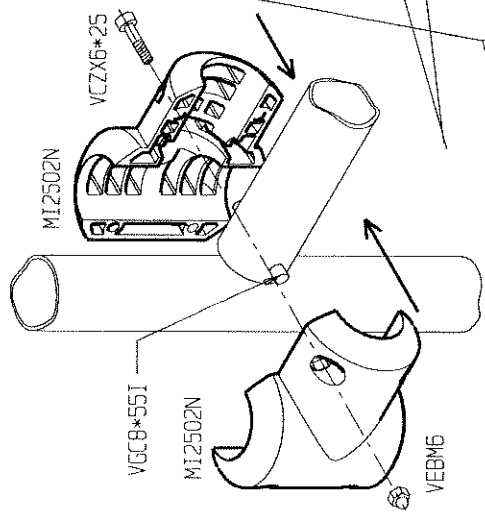
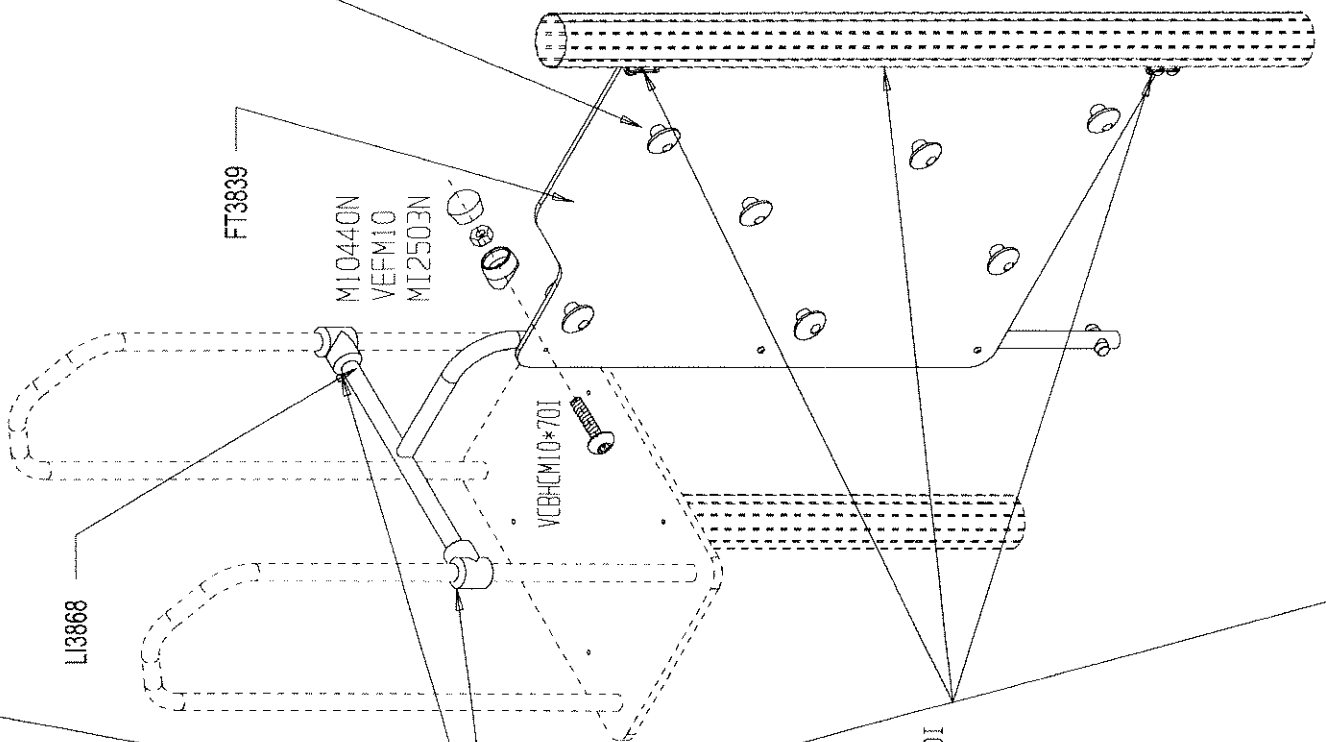
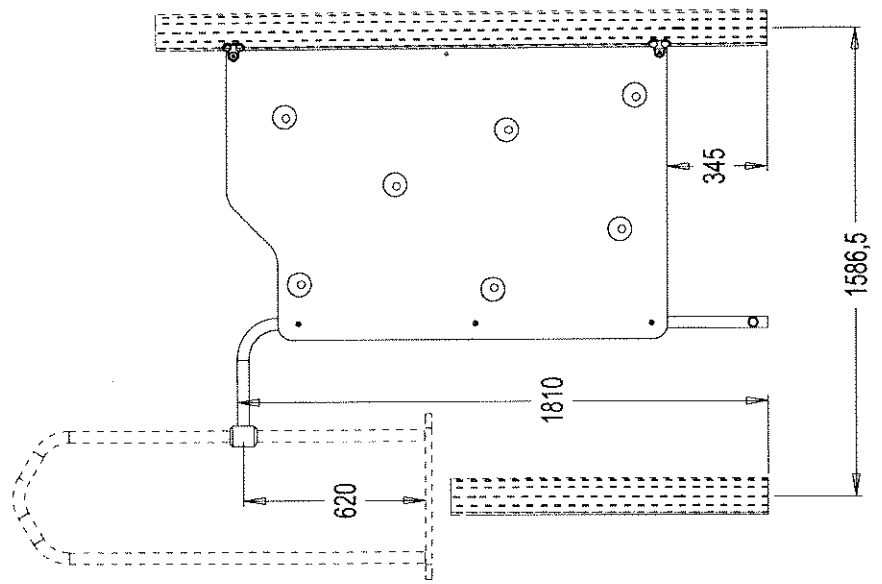
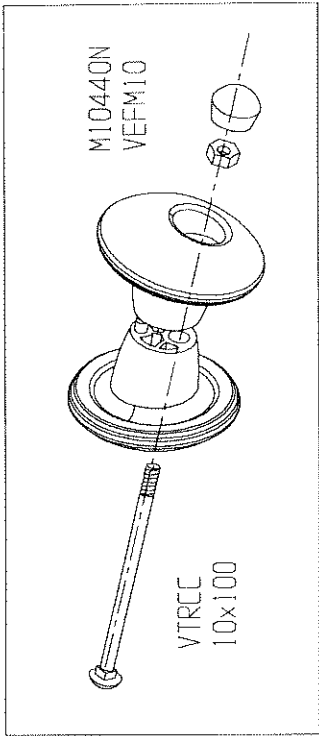

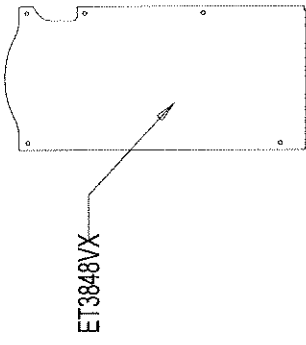

ET3848VX

LI4505 x 3

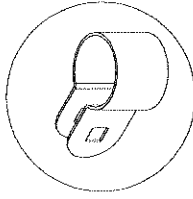



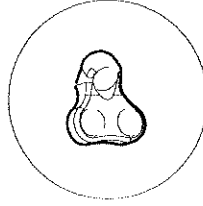

MI4700 X 2

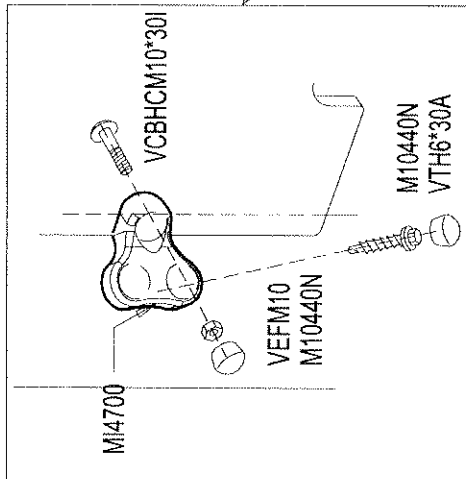
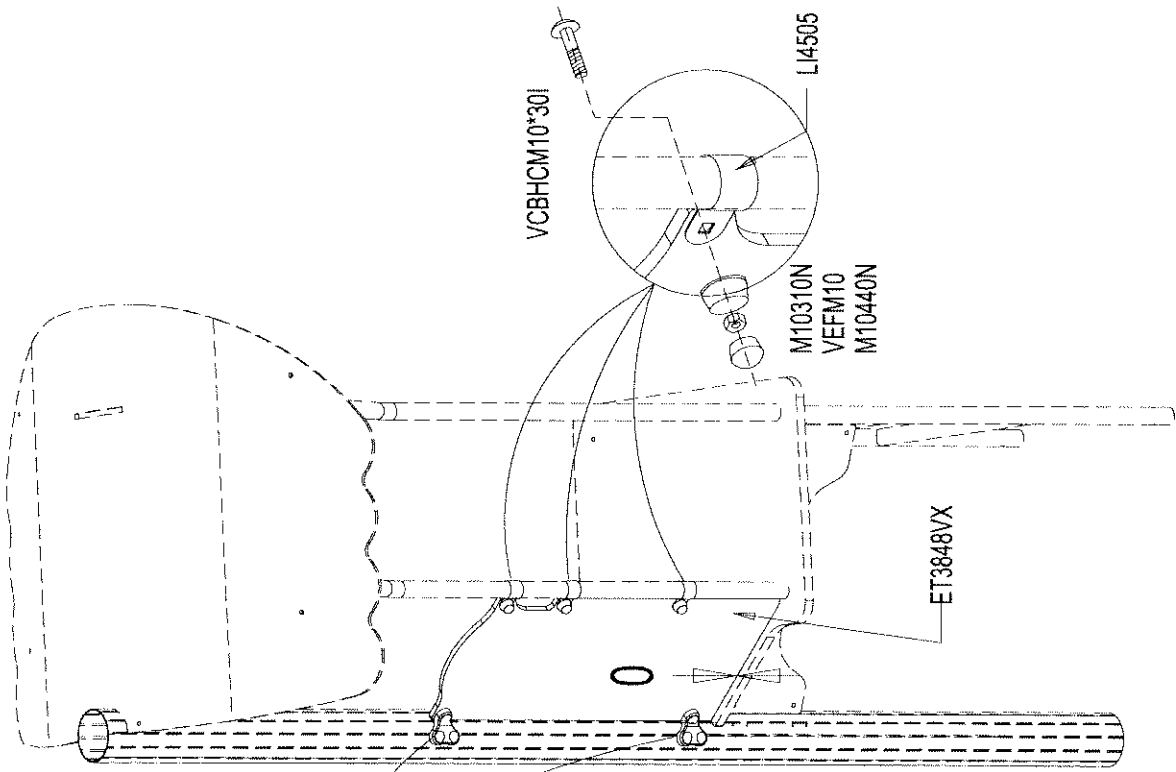

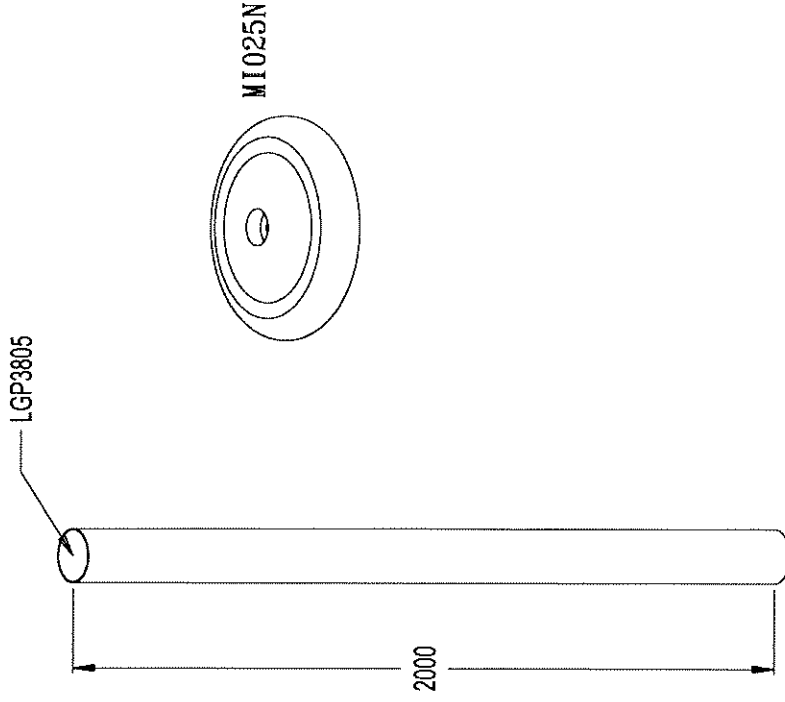
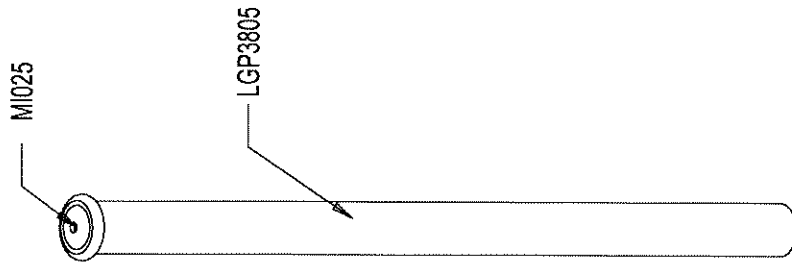



	VTH6*30A	4
	VEFM10	5
	VCBHCM10*30I	5
	M10310N	3
	M10440N	3



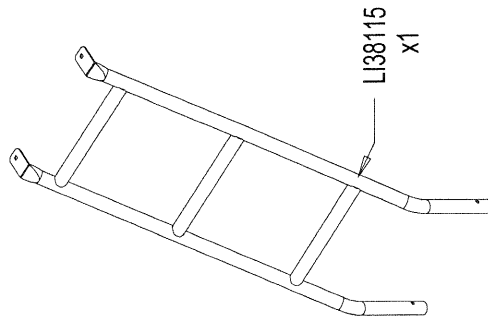
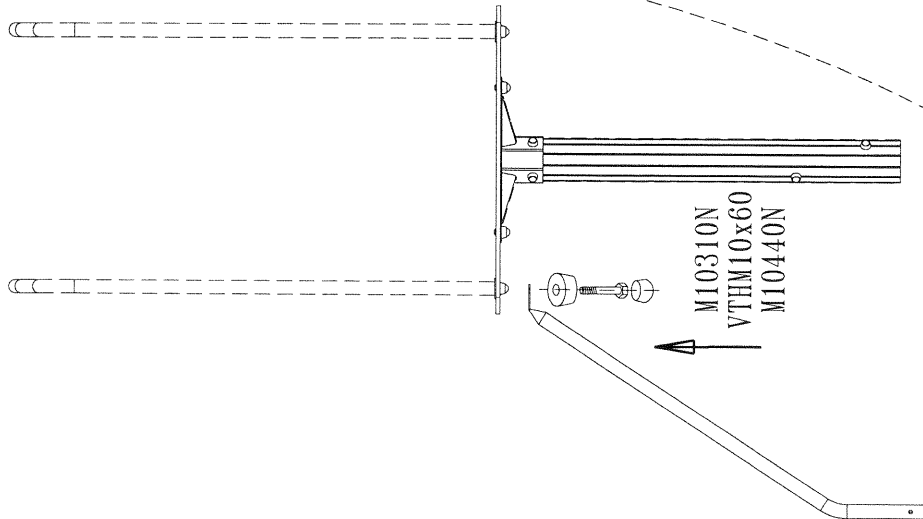
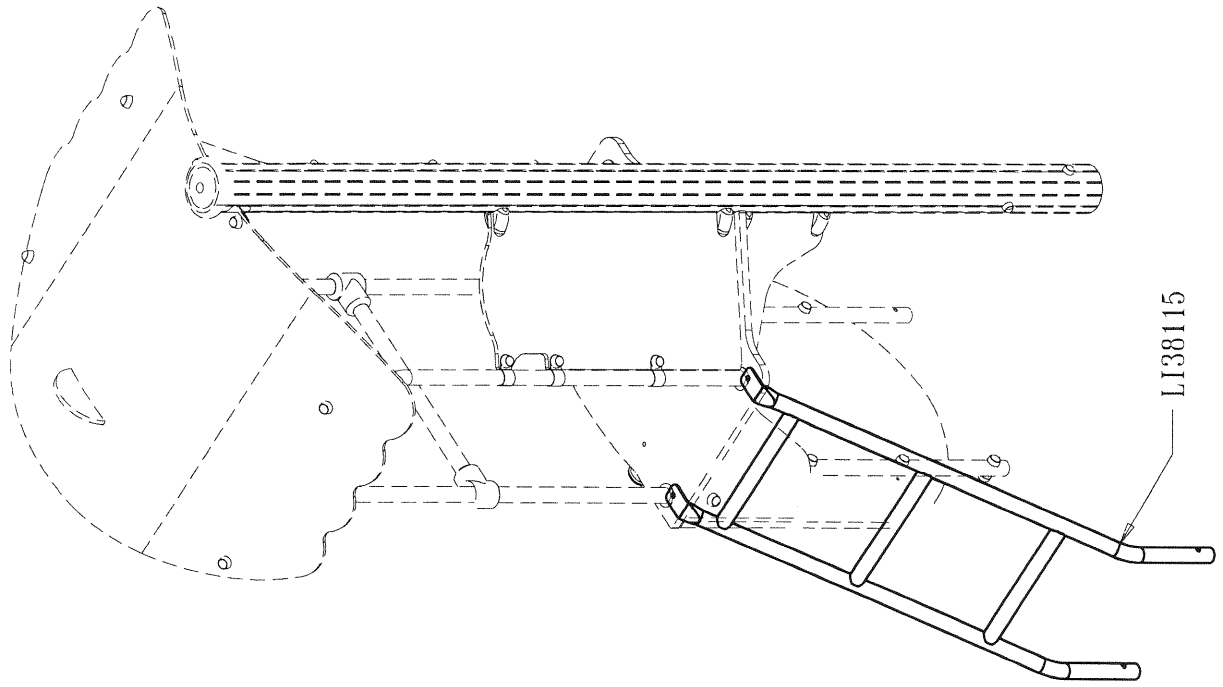

	LG4412	1
	VFHCMB*40	1
	M10440	1



	VTH 10x60	?
	M10310N	2
	M10440N	2