

F5875  
2X



F5876  
2X



P30  
5X

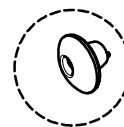

MI3800J  
32X

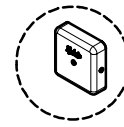

M68x68  
6X



L5888  
2X

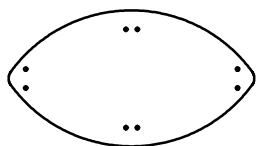

F5877  
1X

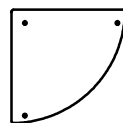

F5878  
4X

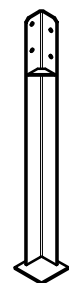

LG5800  
6X

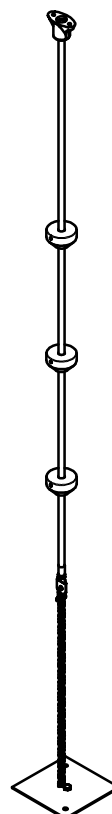

U58202A  
1X

LGP5801  
6X

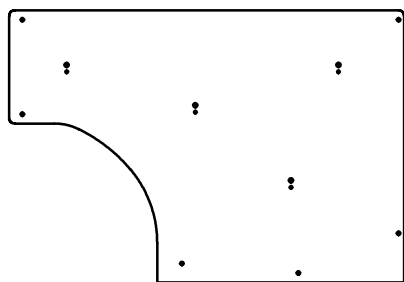

F5880  
2X

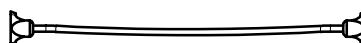

U58203  
2X

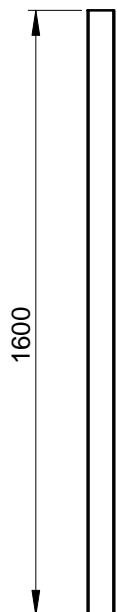

LGP5850  
2X

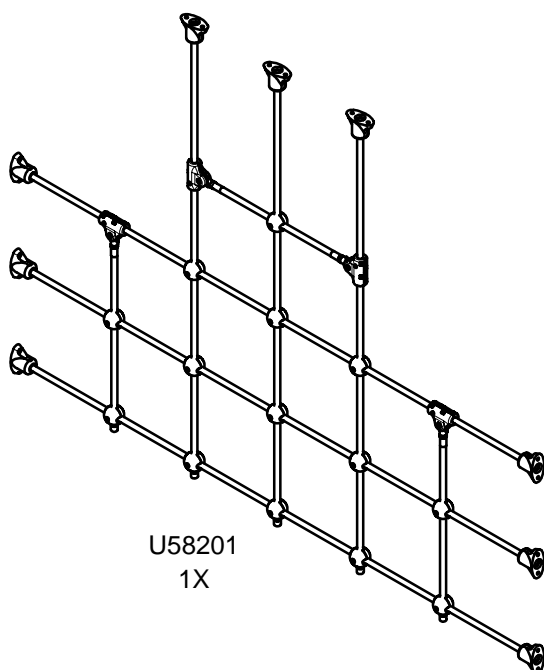

U58201  
1X

| Réf          | Qté |
|--------------|-----|
| LA000        | 1   |
| M8310N       | 79  |
| M8440N       | 79  |
| M10440N      | 32  |
| MI0002       | 1   |
| RRAV6        | 6   |
| VCBHCM8x50I  | 8   |
| VEFM8        | 8   |
| VEFM10       | 15  |
| VR8x18       | 5   |
| VTH6x30A     | 71  |
| VTH6x60 AUTO | 28  |
| VTRCC10x110  | 16  |



| N° |        |                     |
|----|--------|---------------------|
| 1  | 1.98 m | 31.5 m <sup>2</sup> |

— Zone d'impact  
Impact area  
Area de impacto  
Fallraum  
Valzone



Point de référence  
Setting out point  
Punto de referencia  
Bezugspunkt  
Referentiepunt

- - - Espace libre  
Free space  
Espacio libre  
Freiraum  
Vrije ruimte

EN1176-1:2017

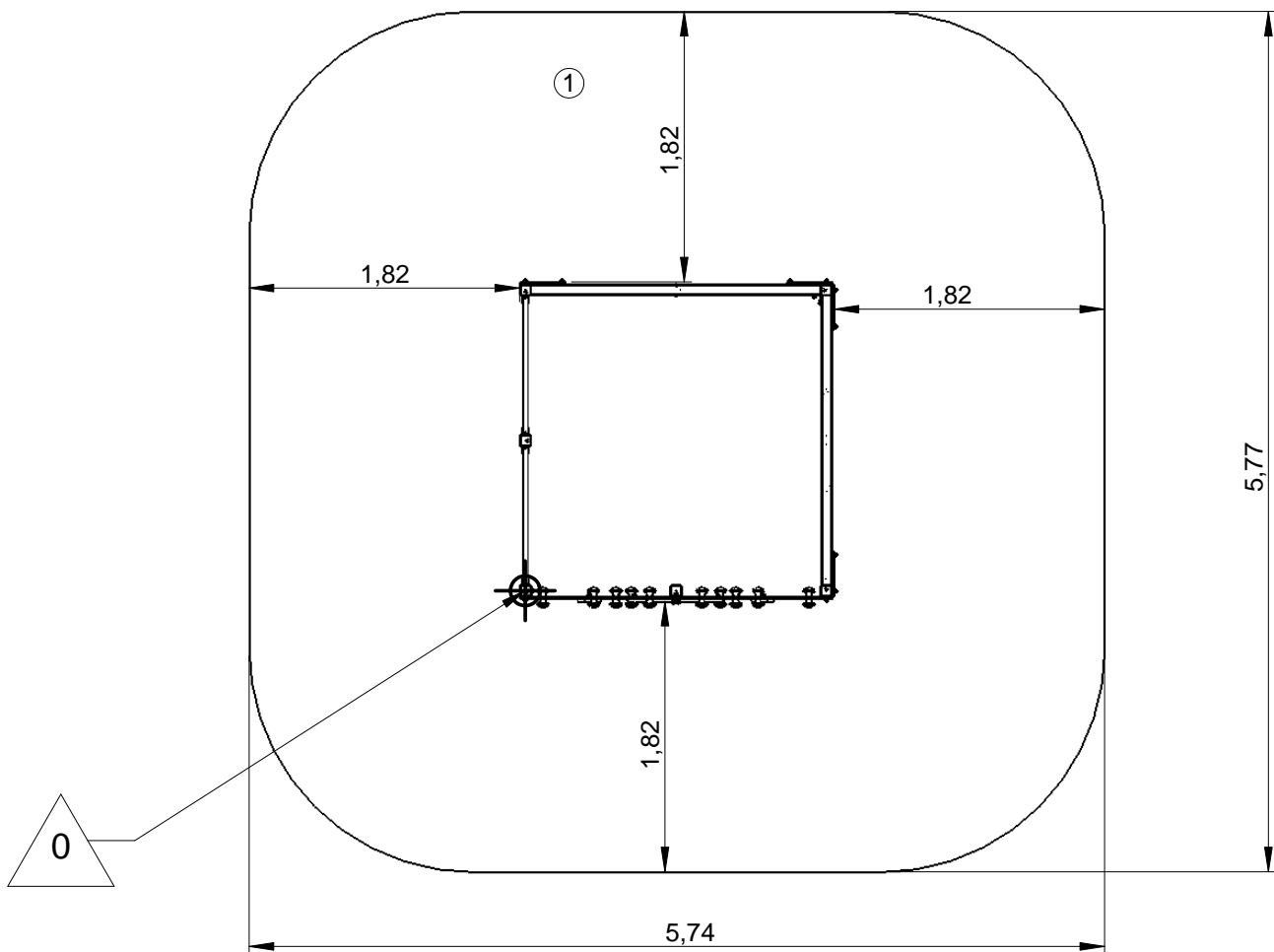

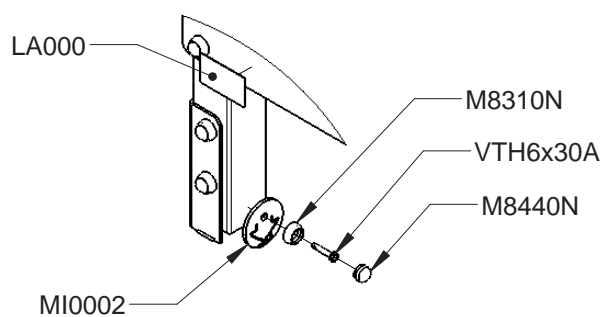
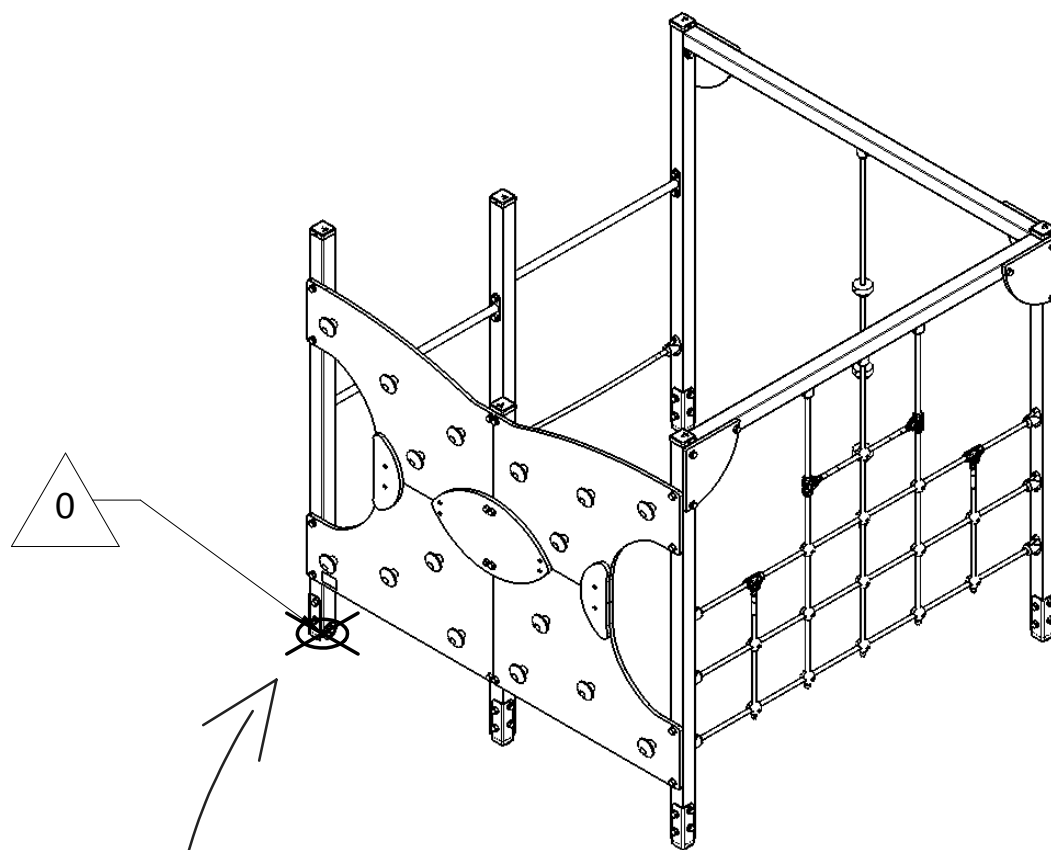

— Zone d'impact  
Impact area  
Area de impacto  
Fallraum  
Valzone

31.5 m<sup>2</sup>

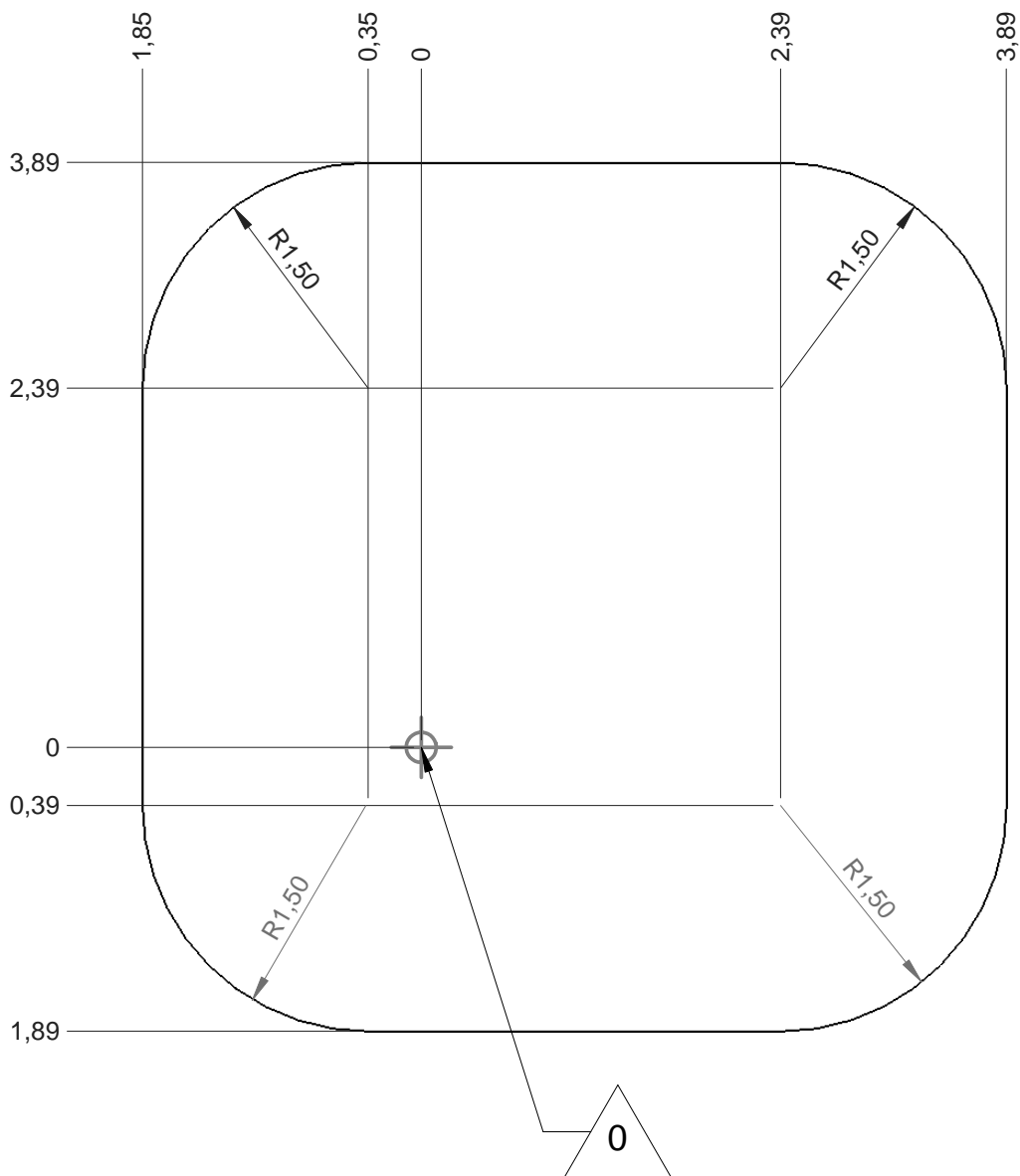

— Sol souple  
Wetpour  
Caucho continuo  
Synthetischer fallschutz  
Gietvloer

31.5 m<sup>2</sup>

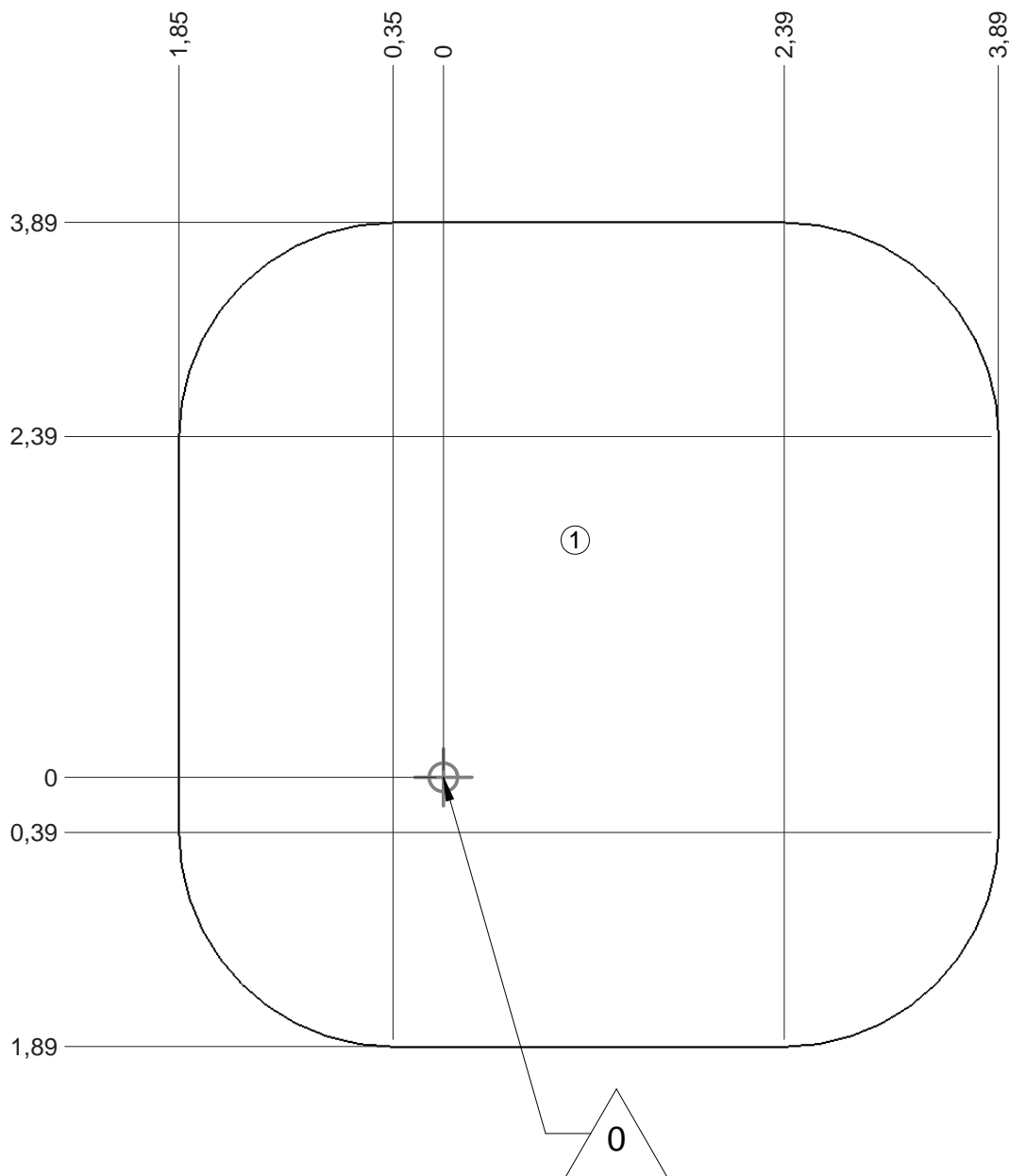

— Dalle béton  
Concrete pad  
Solera de hormigon  
Beton bodenplatte  
Betonnen bodemplaat

23 m  
34 m<sup>2</sup>

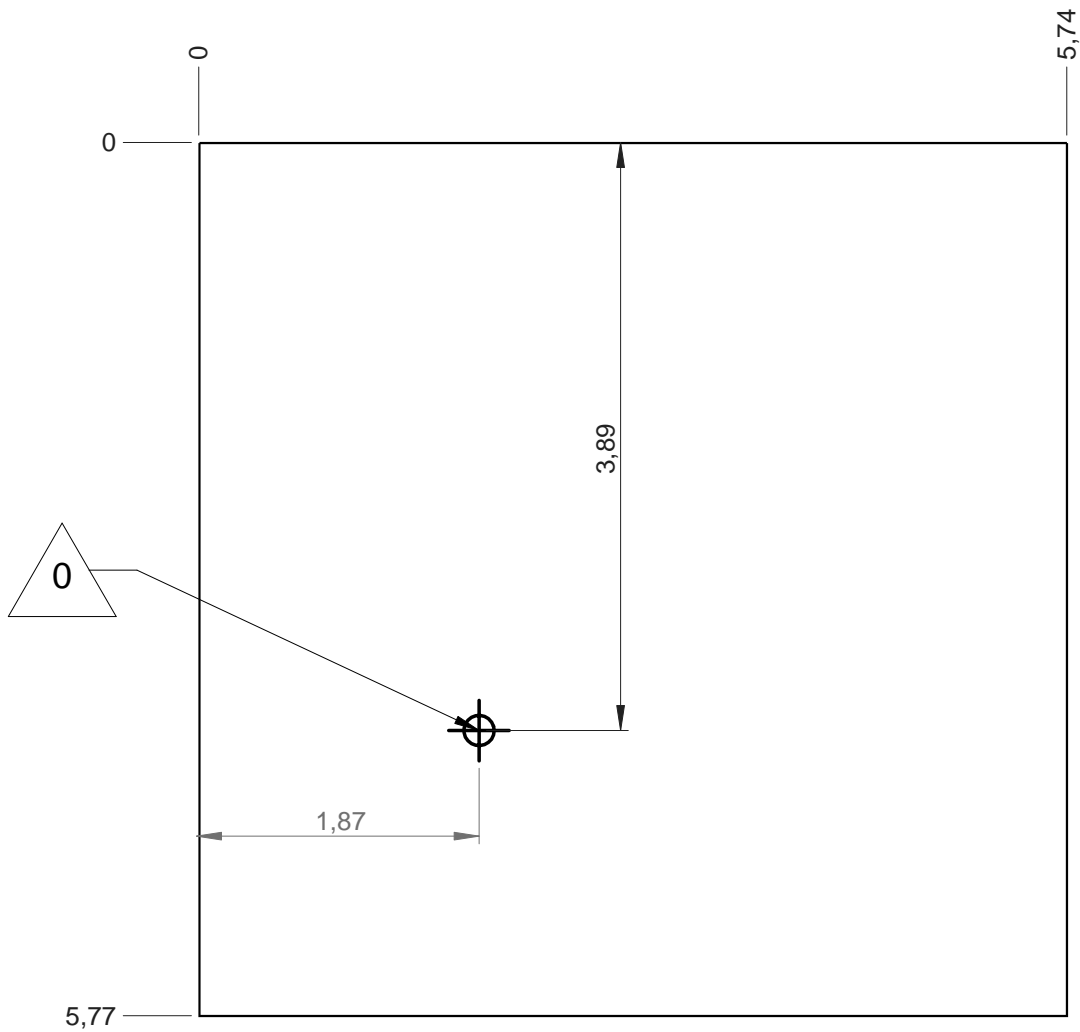

— Sol fluent  
Loos partucule material  
Arenero  
Loses Bodenmaterial  
Los bodemmateriaal

**24 m**  
**36 m<sup>2</sup>**

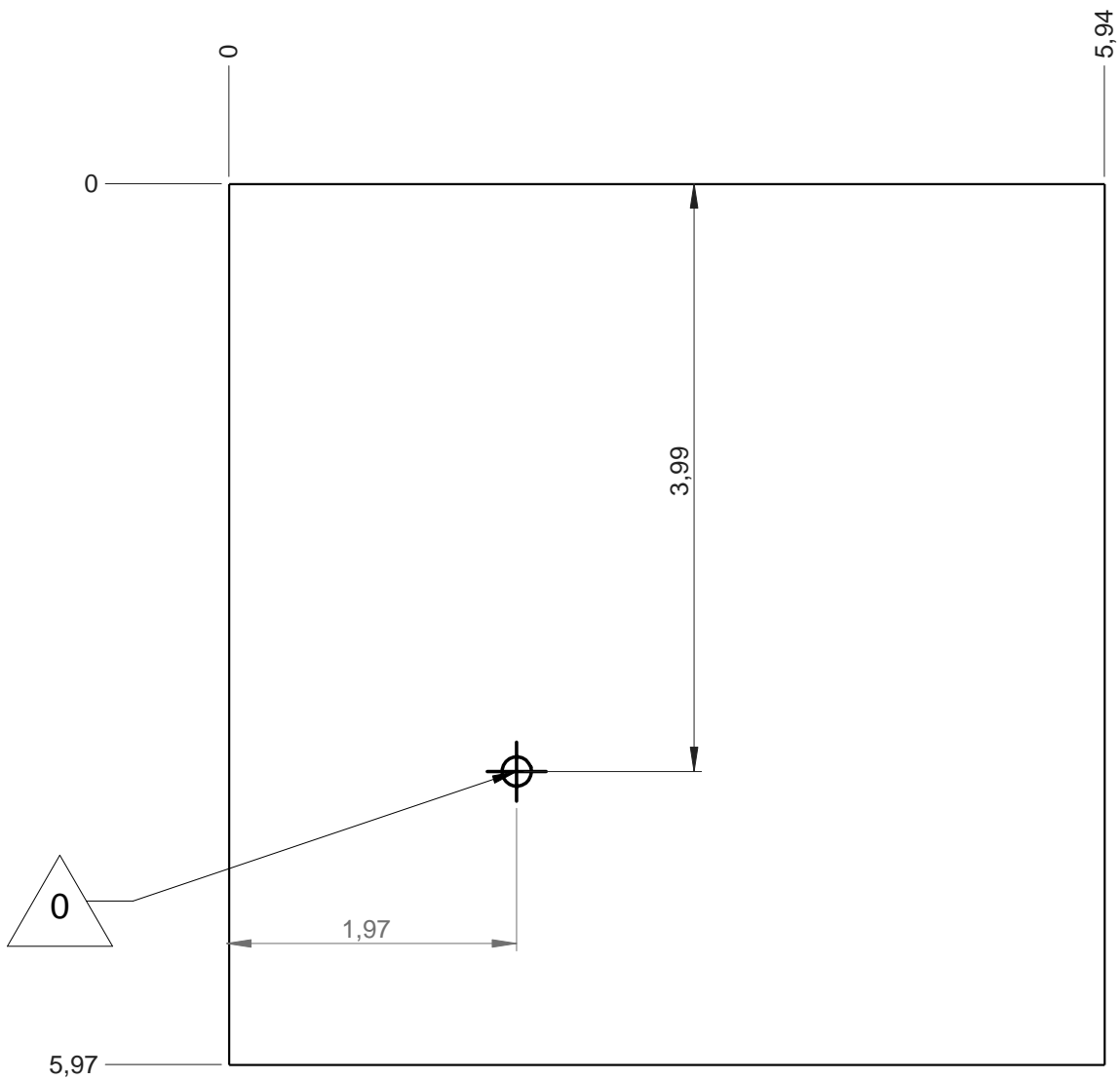



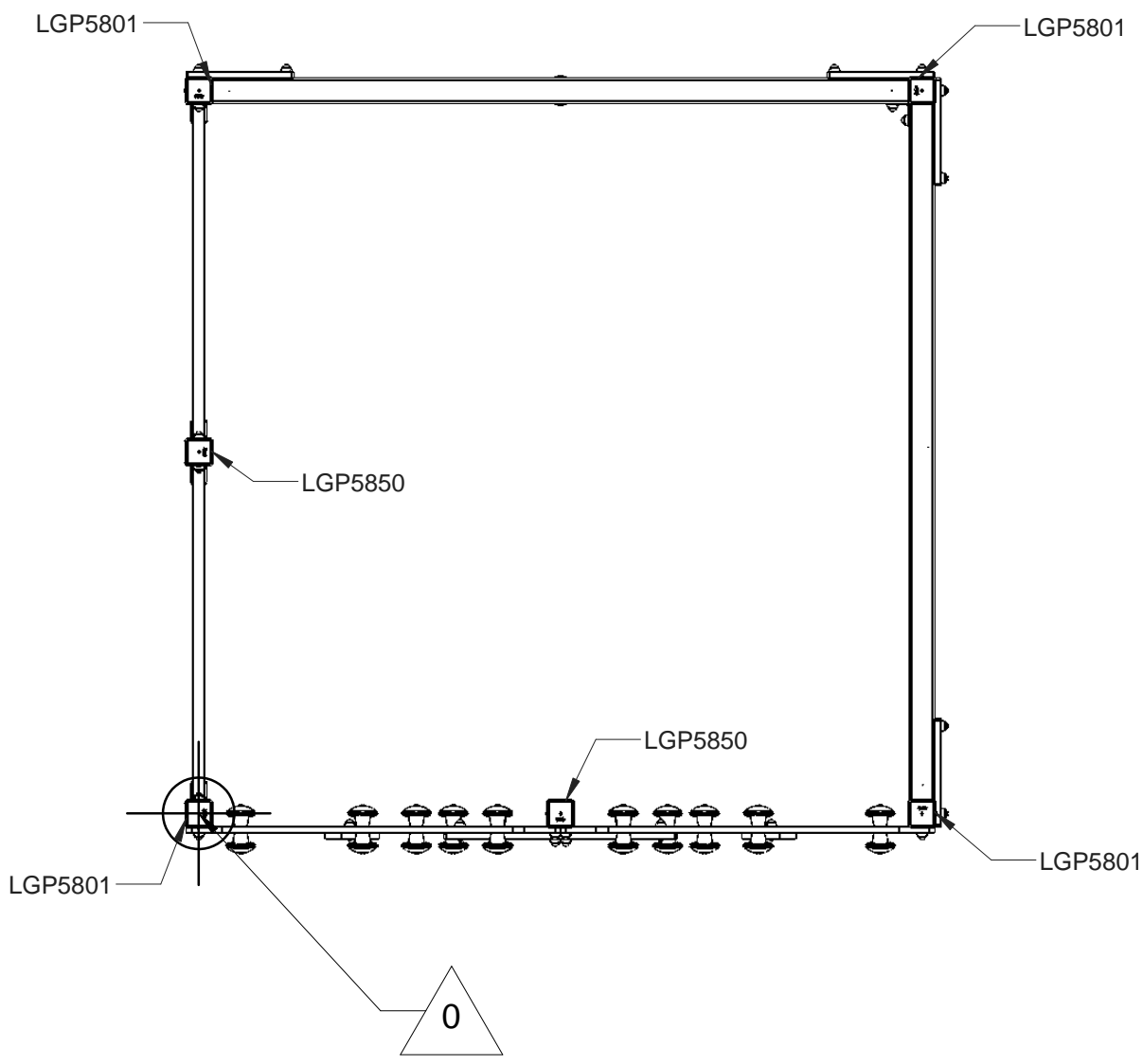

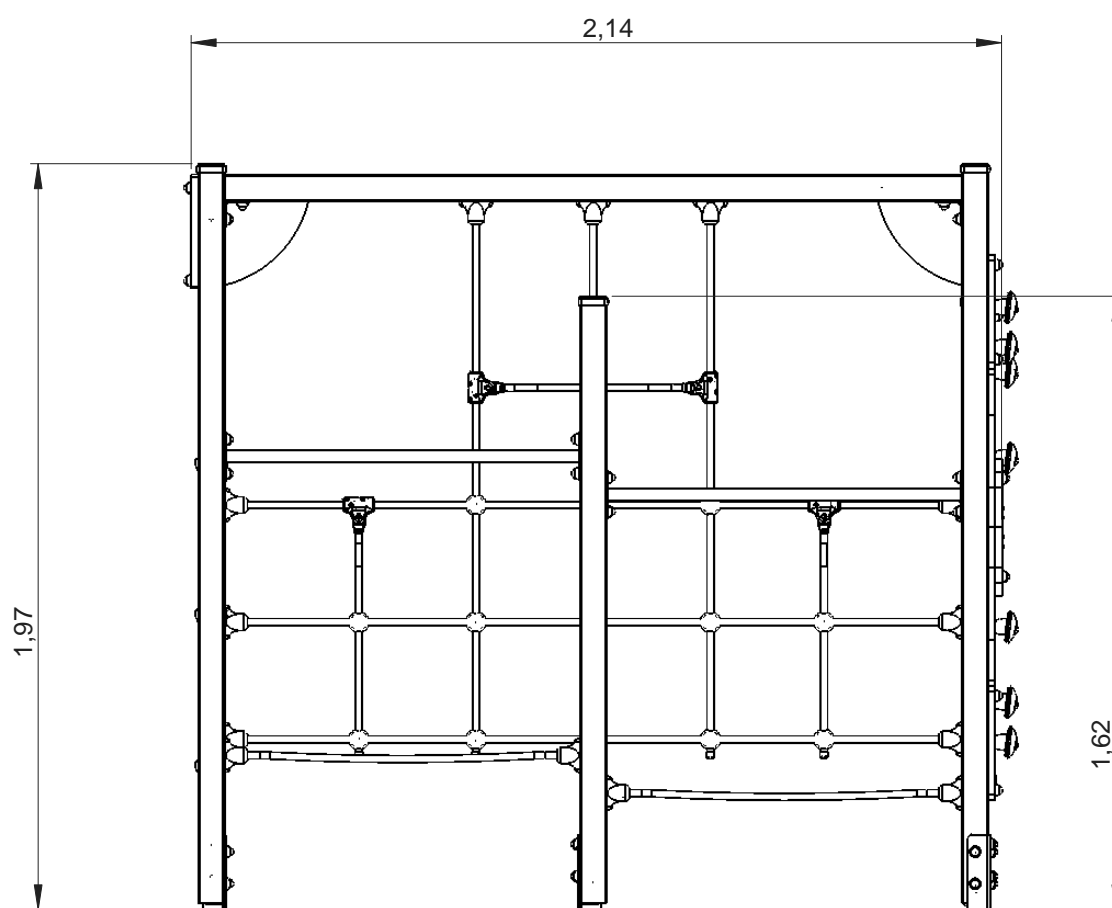
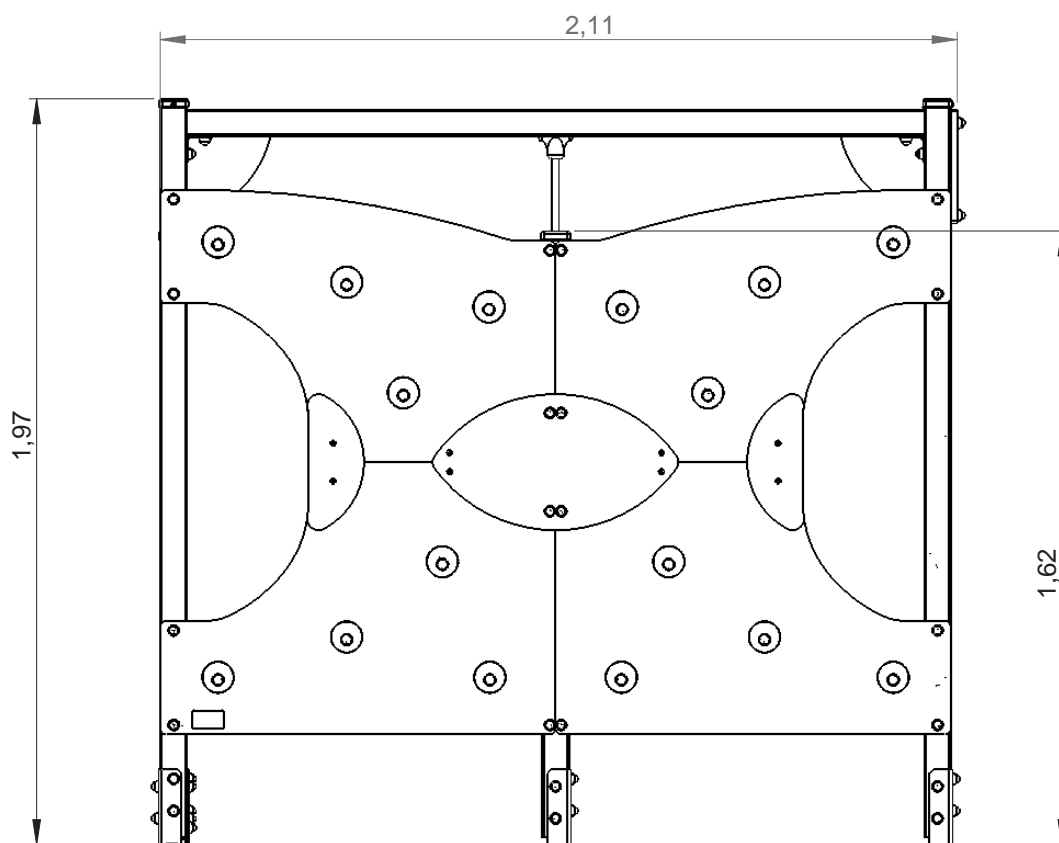



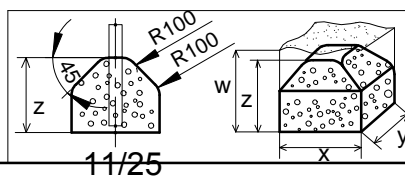
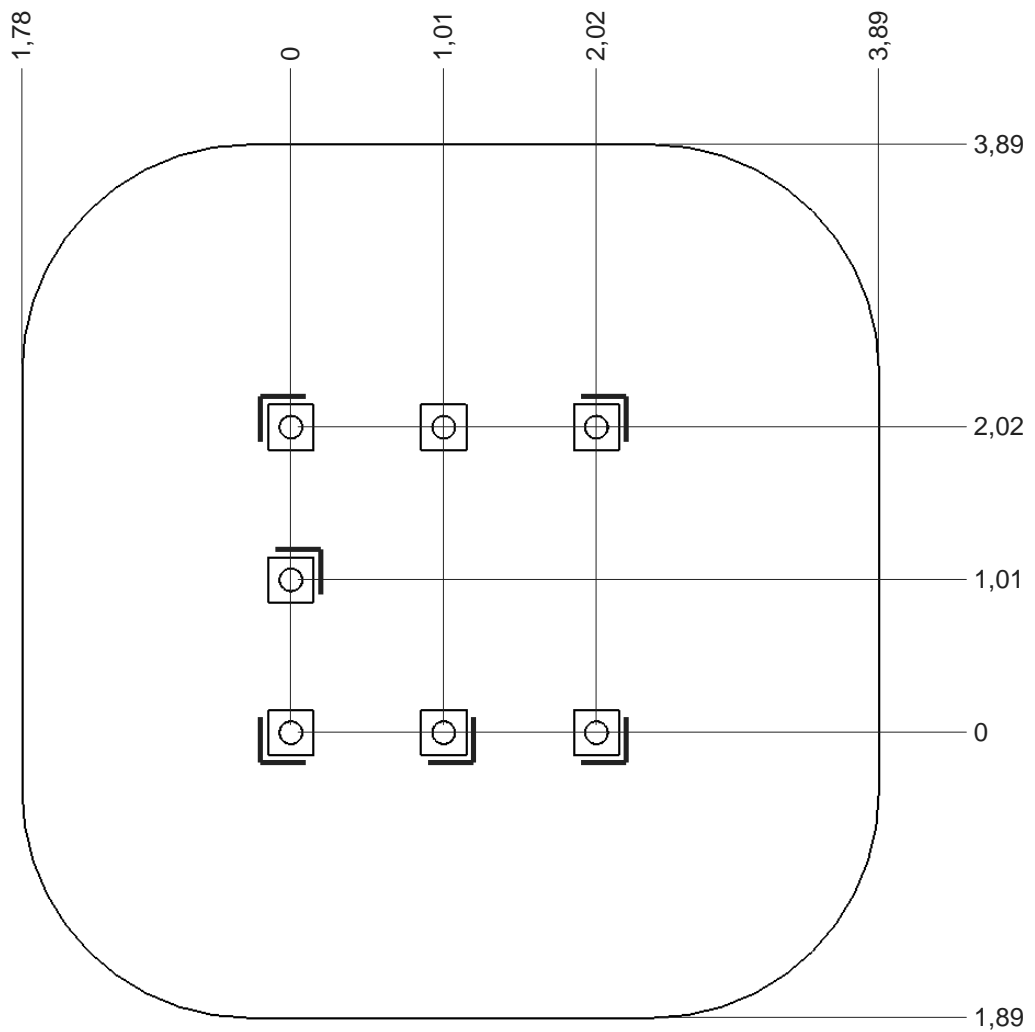

Implantation  
 Footing plan  
 Implantación  
 Fundamentplan  
 Funderingstekening

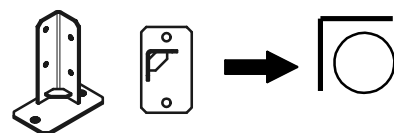
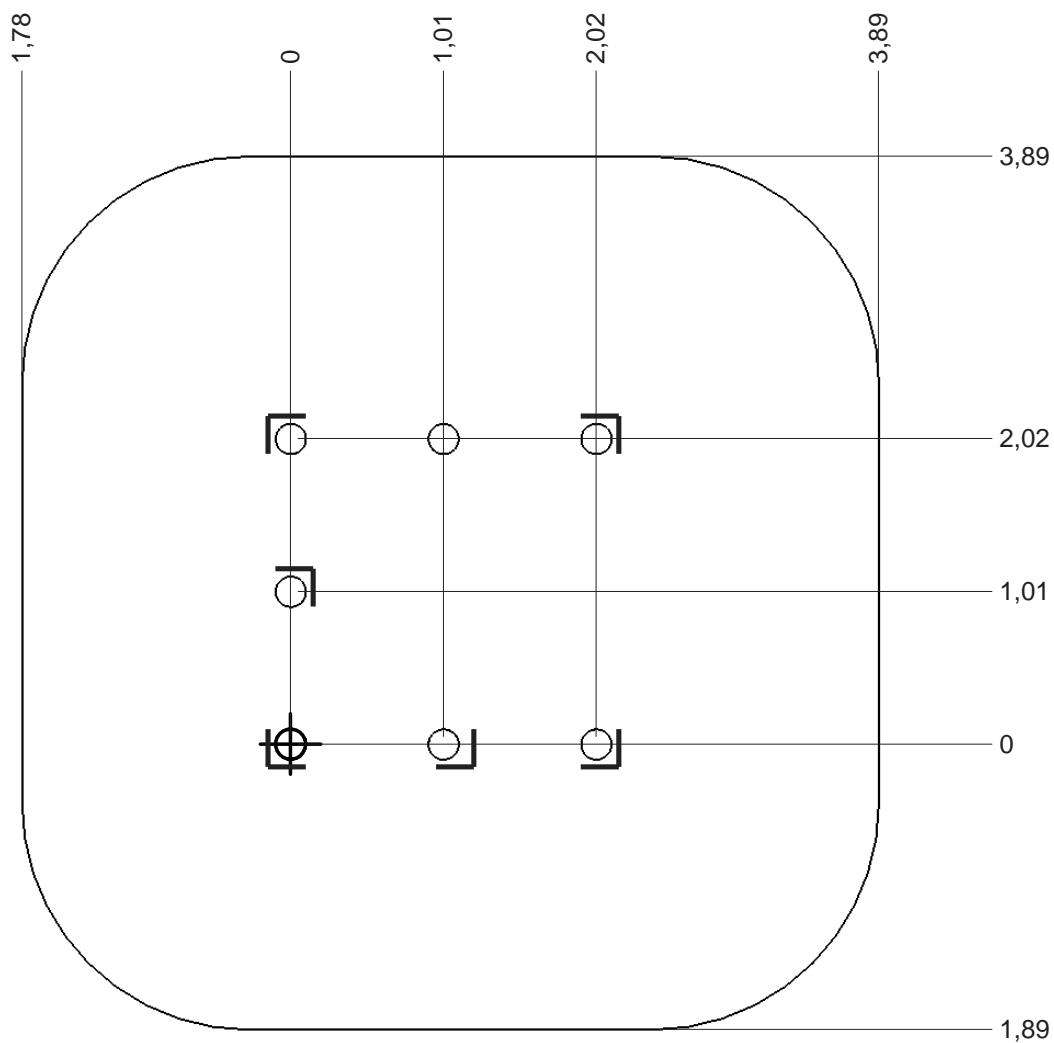

|  | x   | y   | z   | w   |
|--|-----|-----|-----|-----|
|  | 0.3 | 0.3 | 0.3 | 0.6 |
|  | 0.4 | 0.4 | 0.3 | 0.6 |
|  | 0.6 | 0.3 | 0.3 | 0.6 |

Implantation  
 Footing plan  
 Implantación  
 Fundomentplan  
 Funderingstekening



|  |   |  |
|--|---|--|
|  <p>x2</p> |  <p>4H</p> | <p>RD14M10</p>  |
|--|---|--|

### LGP.... A

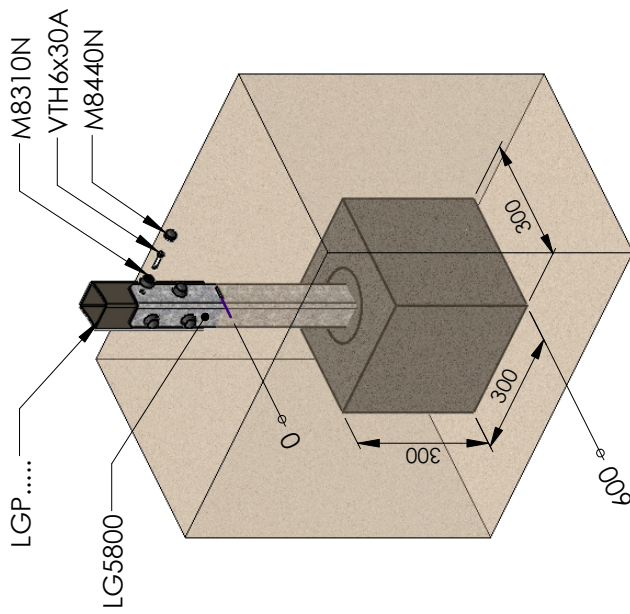

### LGP.... B

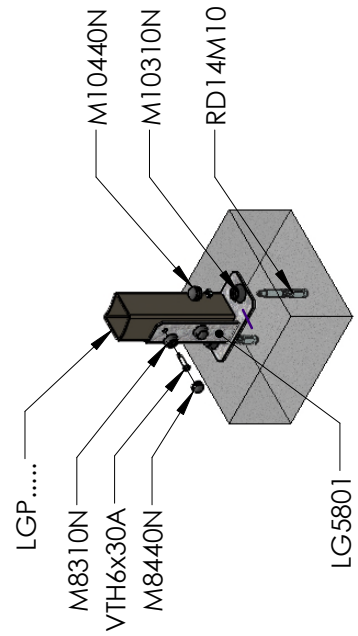

### B.... A

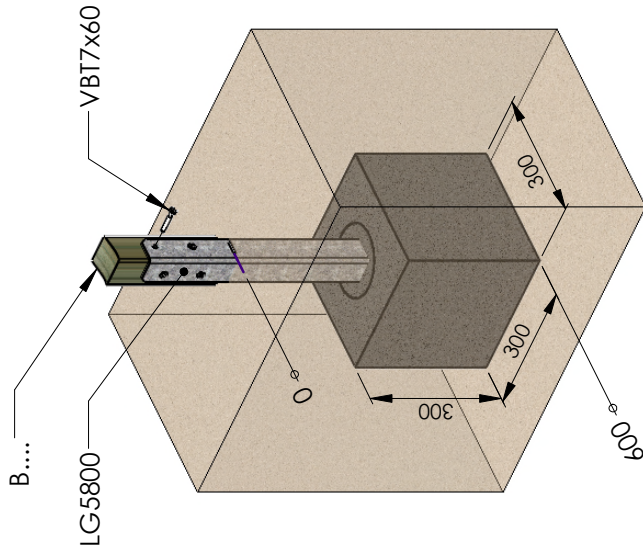

### B.... B

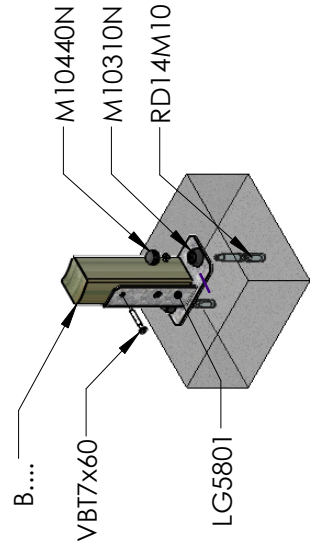

### ET.... A

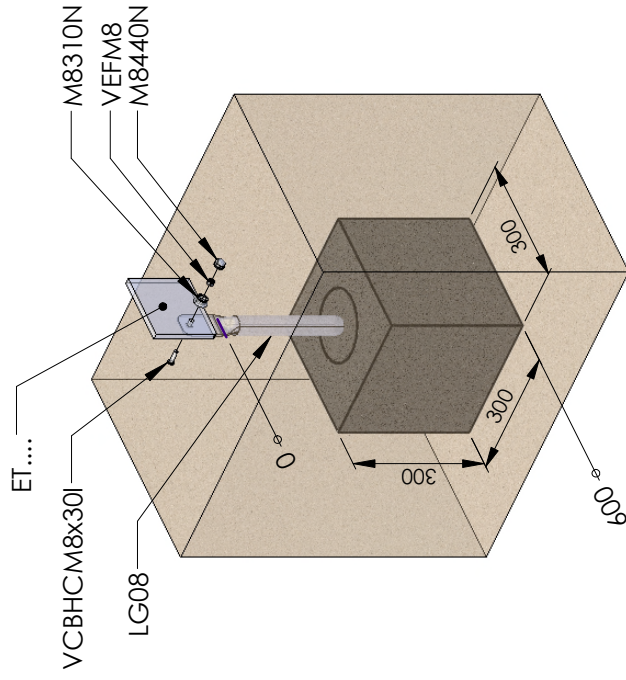

### ET.... B

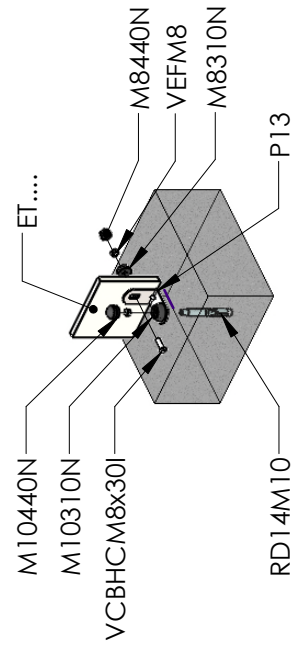

U.... A

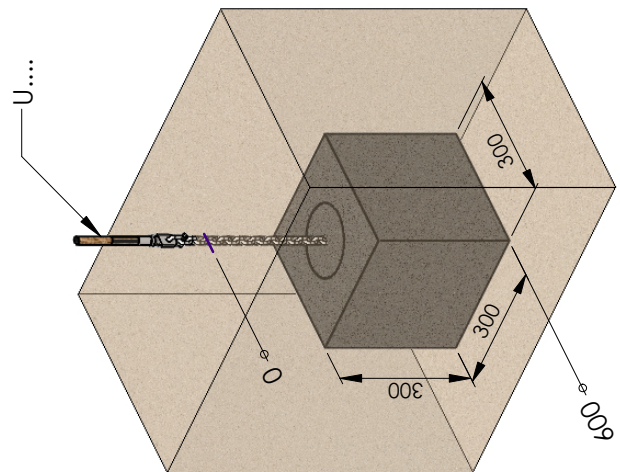

U.... B

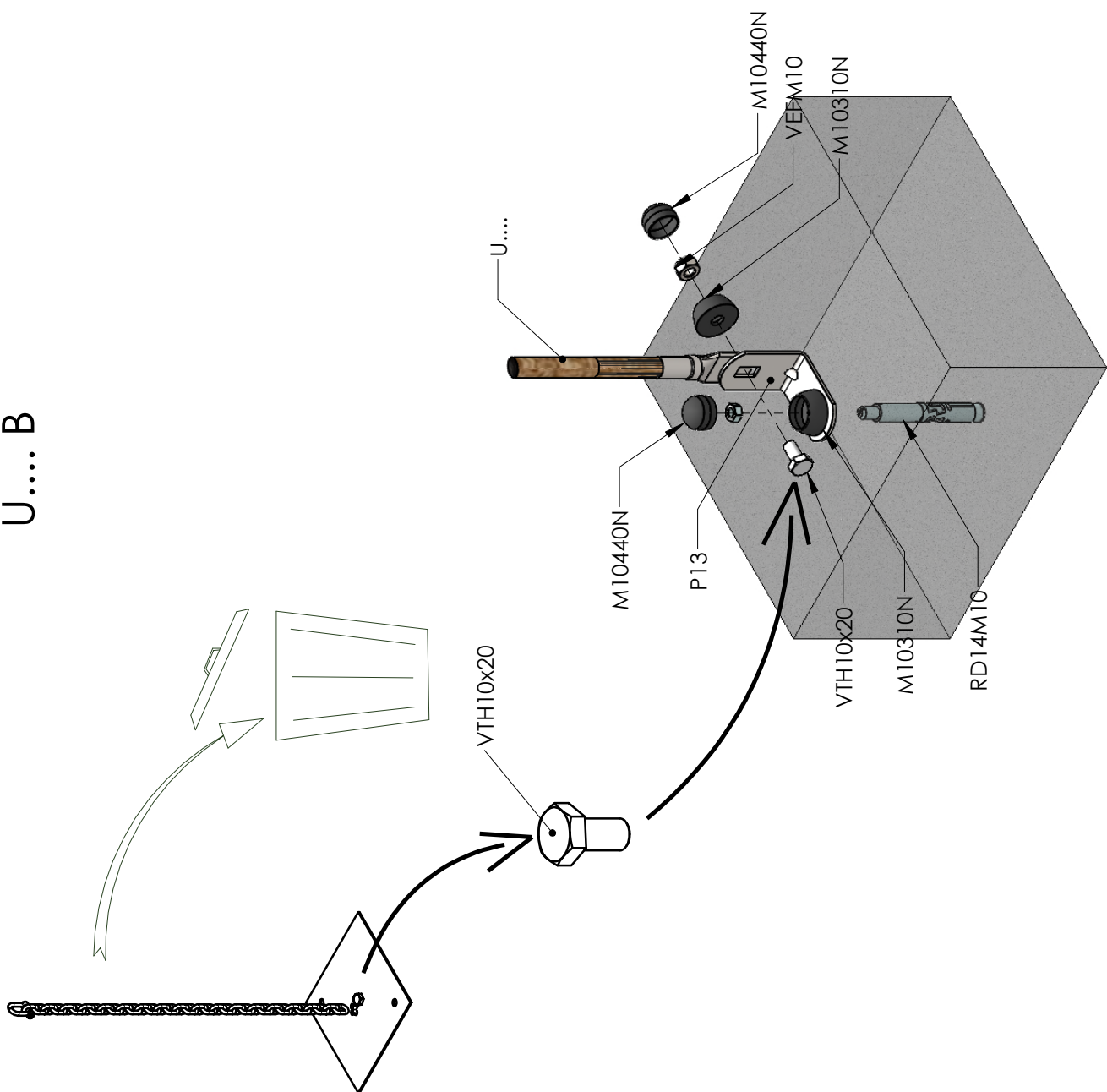

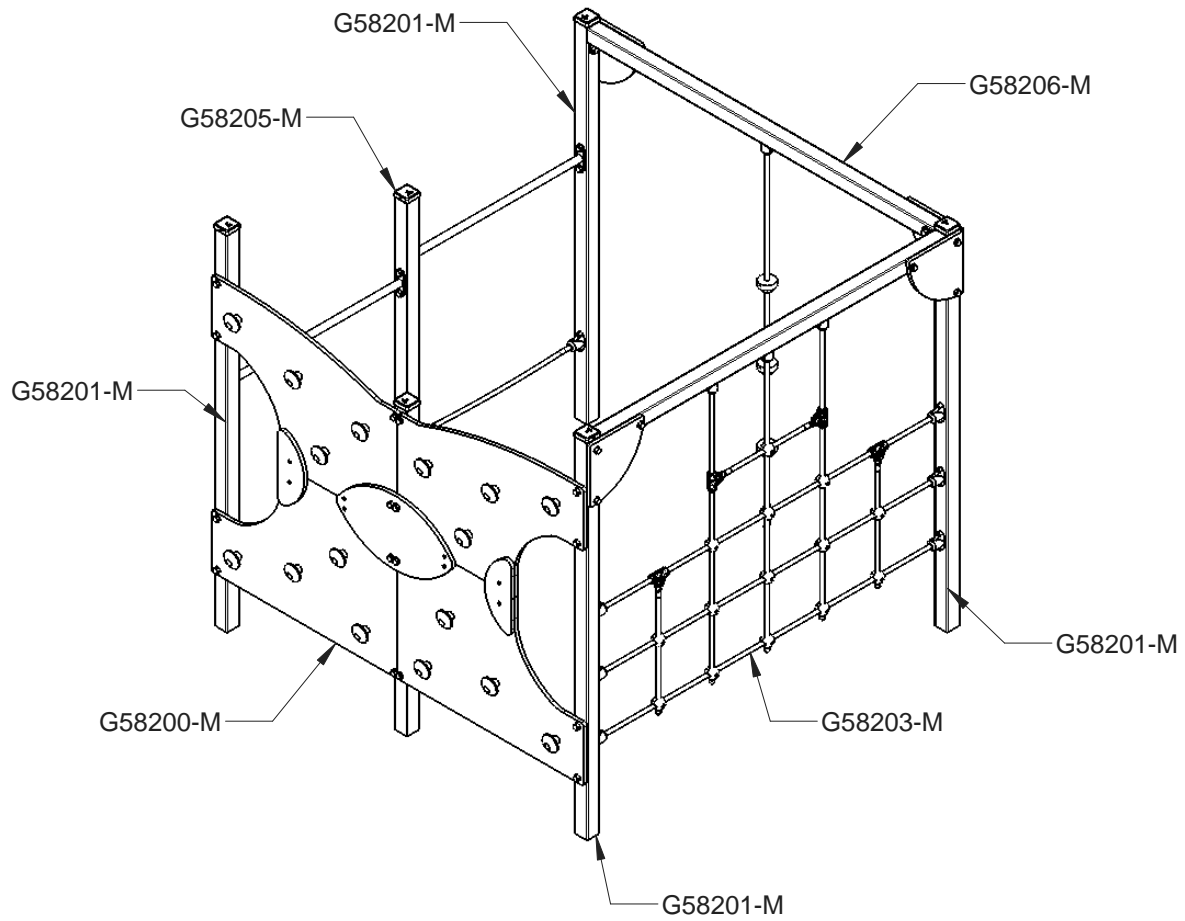

| Réf      | Qté |
|----------|-----|
| G58200-M | 1   |
| G58201-M | 4   |
| G58203-M | 1   |
| G58205-M | 1   |
| G58206-M | 1   |

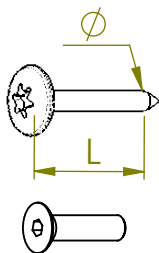

VBT 6 x 30  
 $\varnothing$   $\uparrow$  L (mm)

VFHC



VEC M10  
 $\varnothing$



VEF



VEB

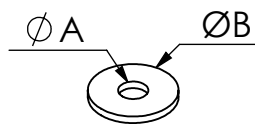

VR6x18  
 $\varnothing A$   $\varnothing B$

VTHA

**< 14 N.m**

Couple de rupture  
Breakage torque

**1000 - 1800 RPM**

Vitesse de rotation  
Rotation speed

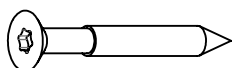

VWT

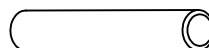

VGC

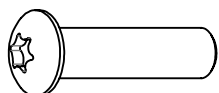

VCBHC

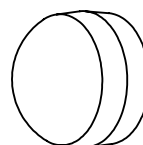

M10 440N

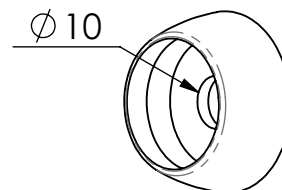

M10 310 N

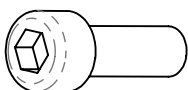

VBTR

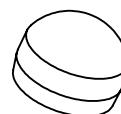

M8 440N

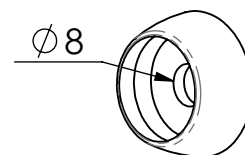

M8 310N

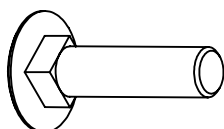

VTRCC

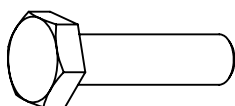

VTH

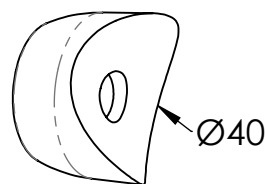

MI2503

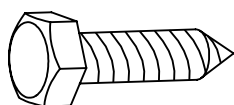

VTF

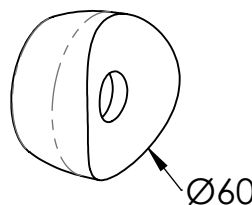

MI2701

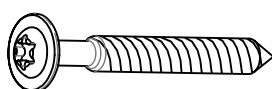

VBT



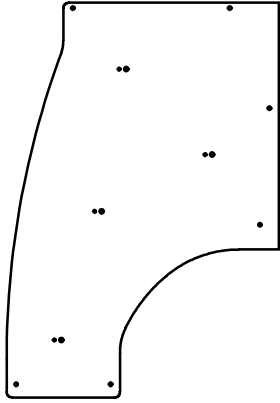
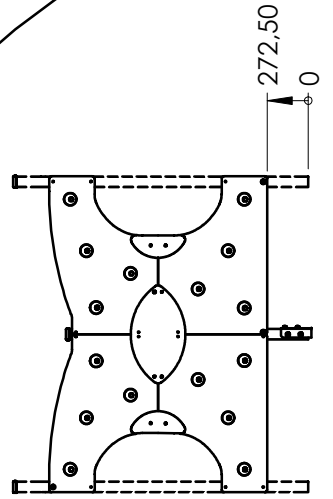
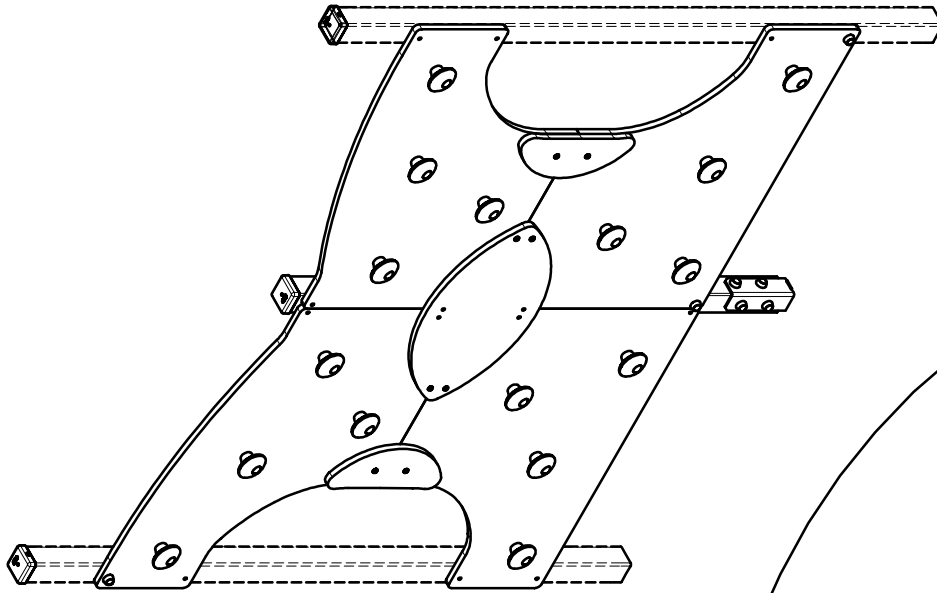

F5875

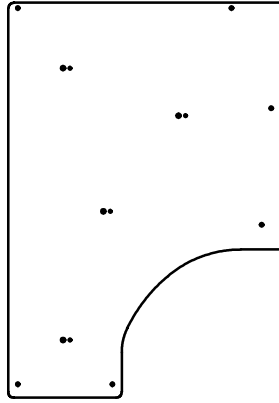

F5880



F5876



F5877

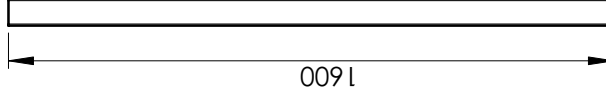

1600

LGP5850



LG5800

| Réf          | Qté |
|--------------|-----|
| F5875        | 2   |
| F5876        | 2   |
| F5877        | 1   |
| F5880        | 2   |
| LG5800       | 1   |
| LGP5850      | 1   |
| M68x68       | 1   |
| M8310N       | 28  |
| M8440N       | 28  |
| M10440N      | 32  |
| M13800J      | 32  |
| RRAV6        | 1   |
| VCBHC M8x50I | 8   |
| VEFM8        | 8   |
| VEFM10       | 15  |
| VTH6x30A     | 4   |
| VTH6x60 AUTO | 16  |
| VTRCC10x110  | 16  |

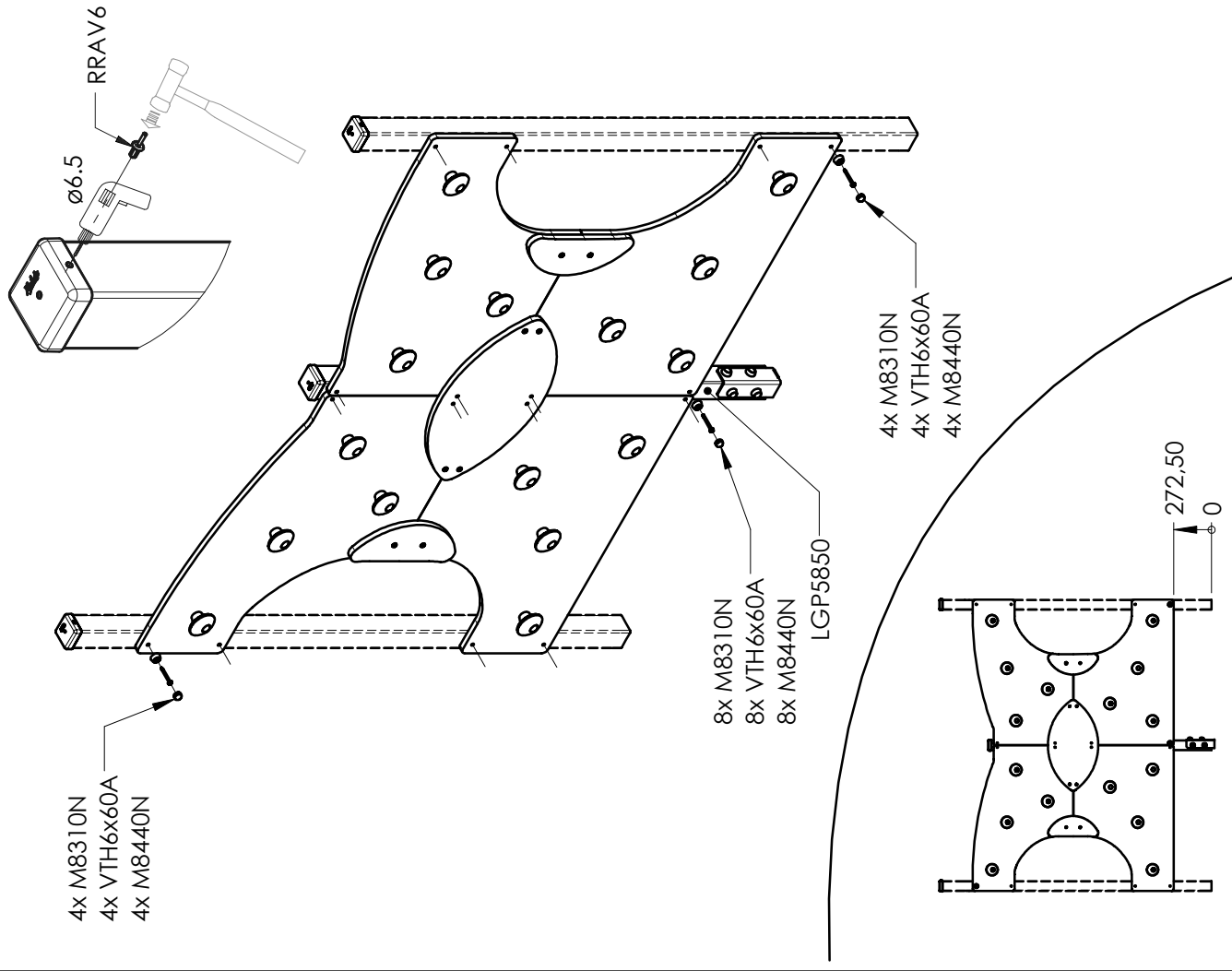
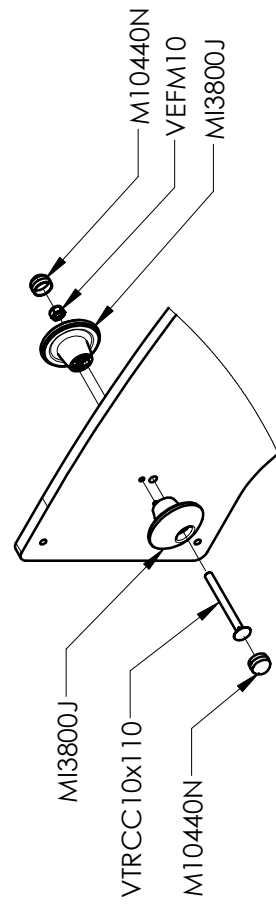
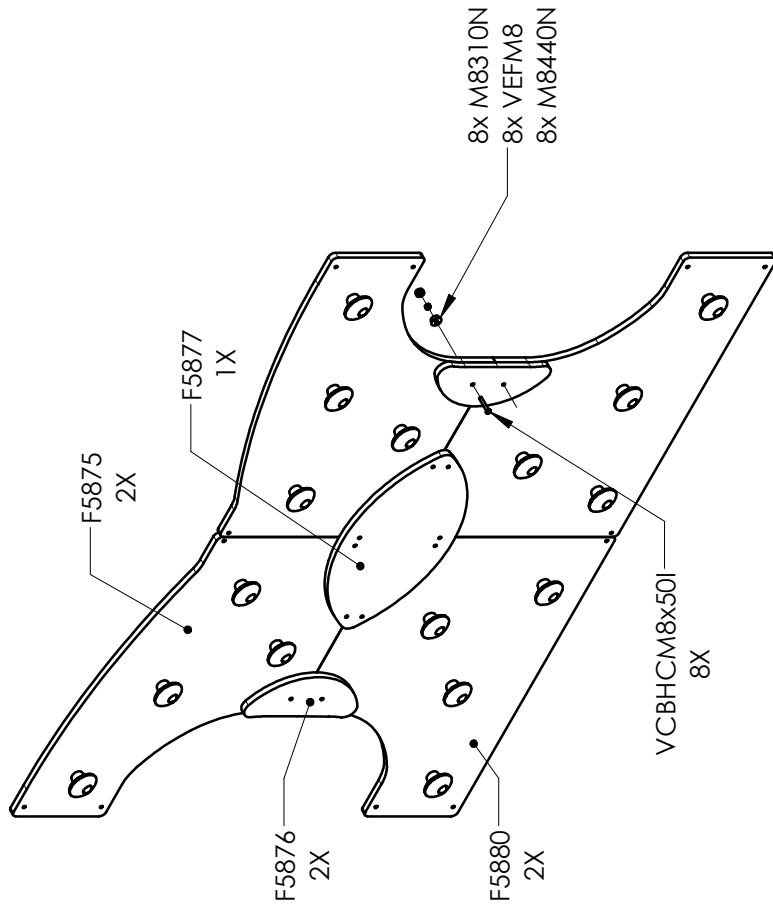

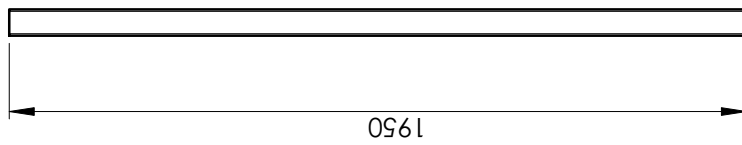

1950



LG-5800

LGP5801



M68x68

1

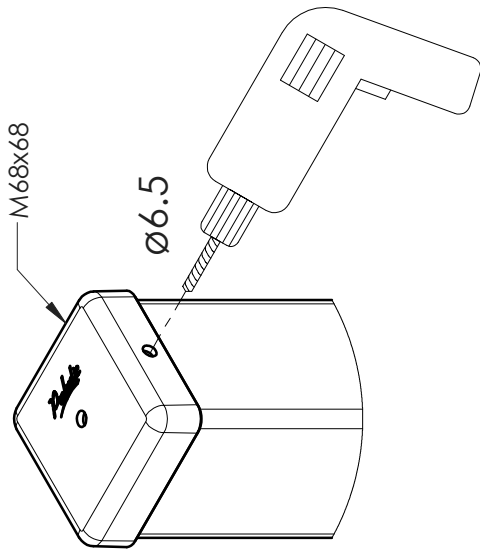

2

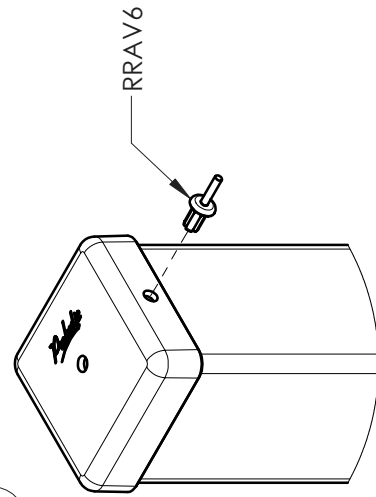

3

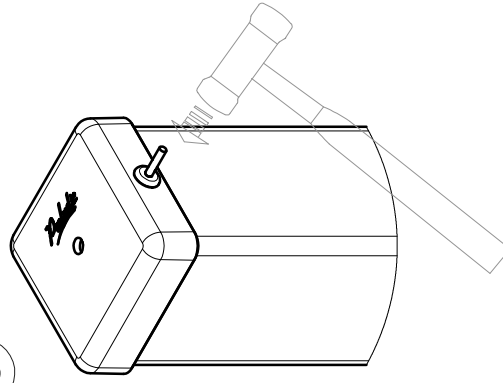

| Réf      | Qté |
|----------|-----|
| LG5800   | 1   |
| LGP5801  | 1   |
| M68x68   | 1   |
| M8310N   | 4   |
| M8440N   | 4   |
| RRAV6    | 1   |
| VTH6x30A | 4   |

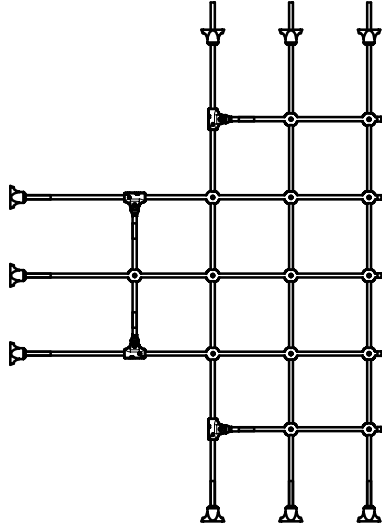
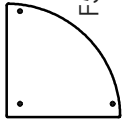
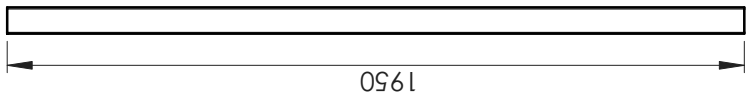
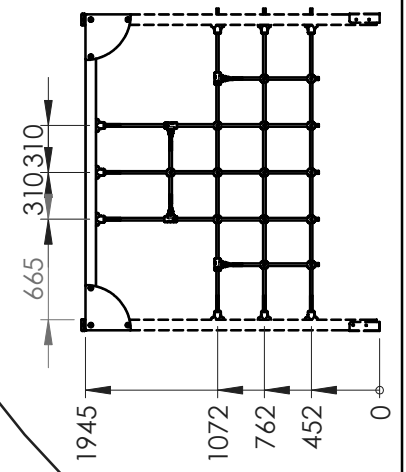
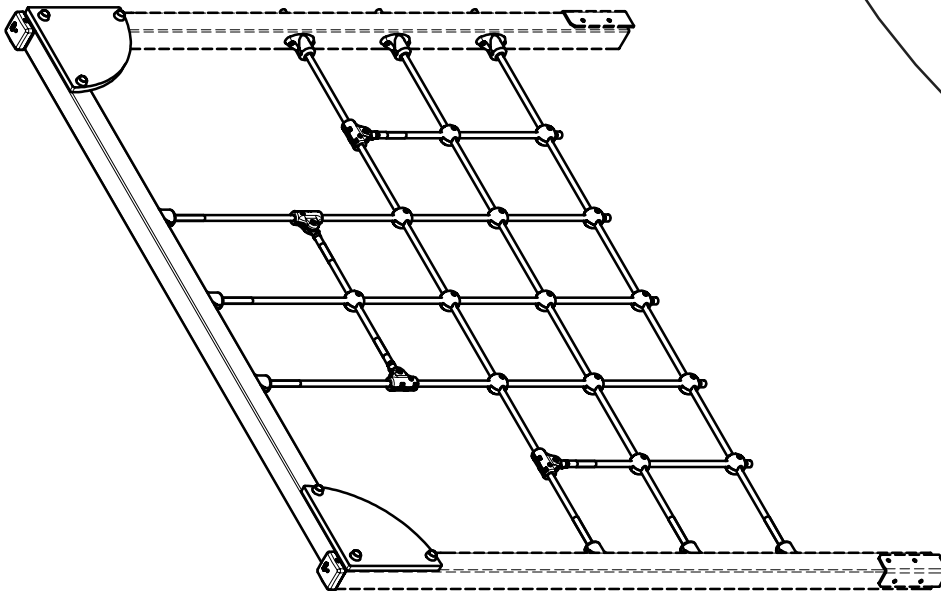

| Réf          | Qté |
|--------------|-----|
| F5878        | 2   |
| P30          | 2   |
| U58201       | 1   |
| VR8x18       | 2   |
| LGP5801      | 1   |
| M8440N       | 10  |
| M8310N       | 10  |
| VTH6x30A     | 22  |
| VTH6x60 AUTO | 6   |

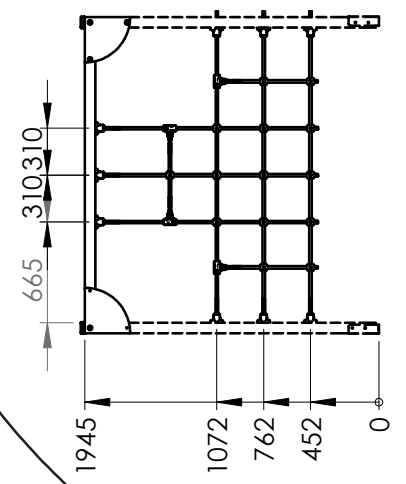
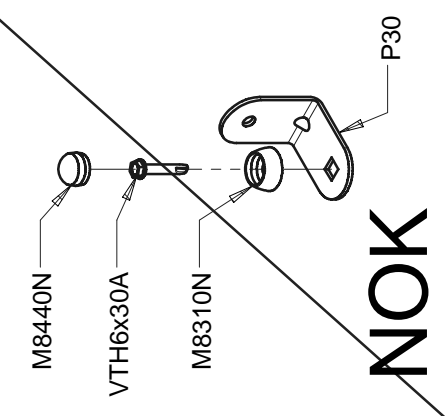
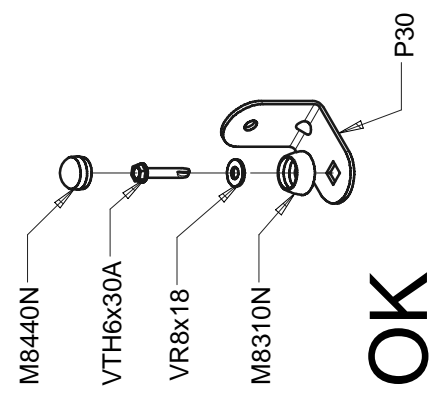
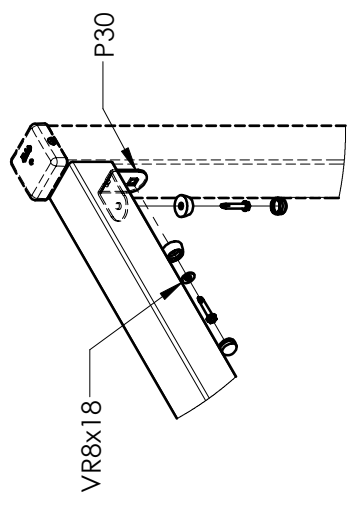
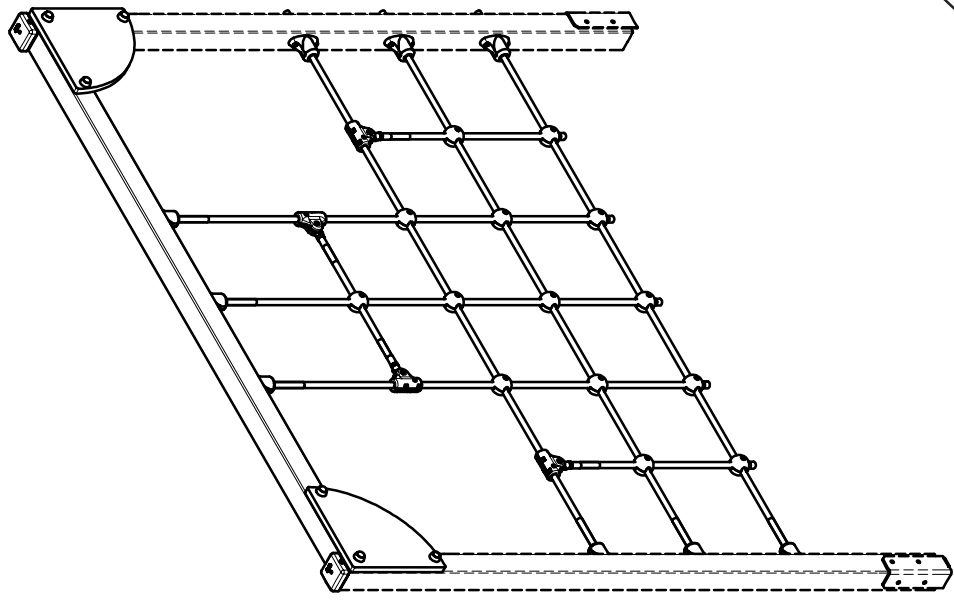
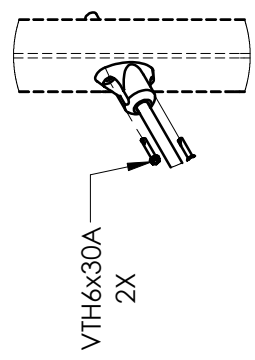
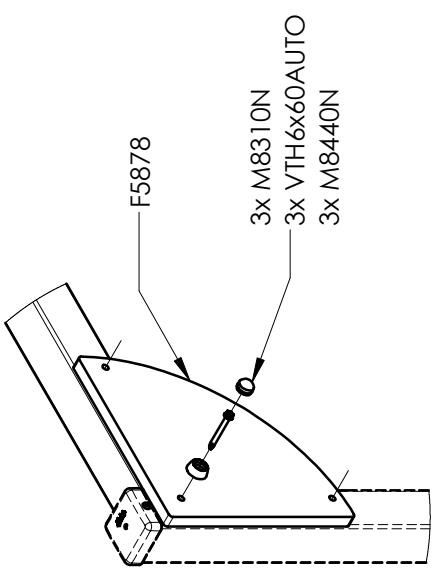

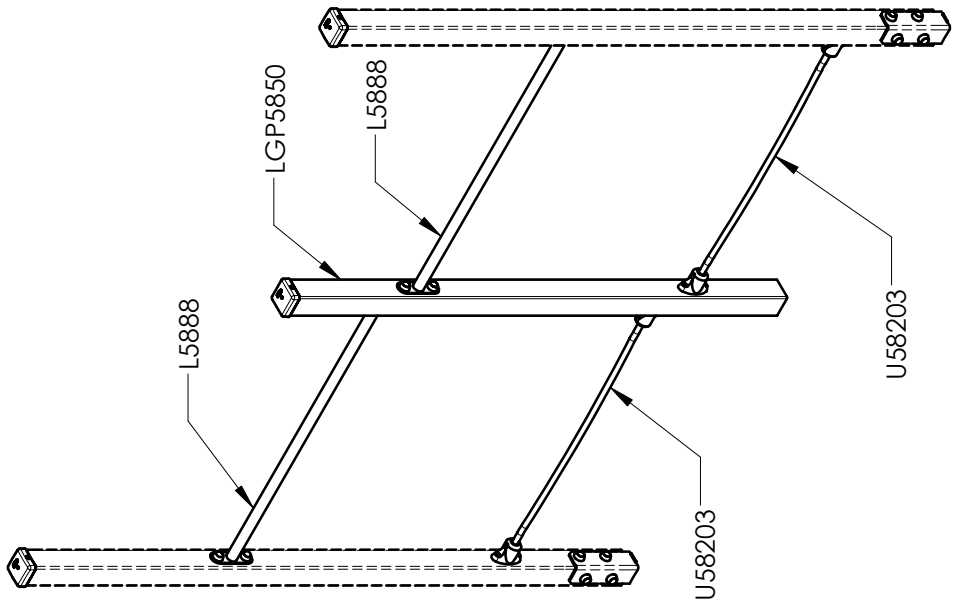
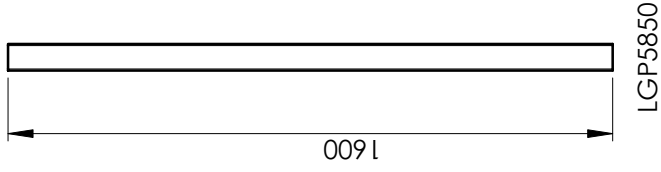
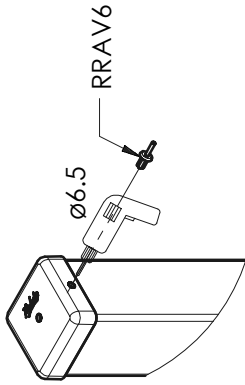
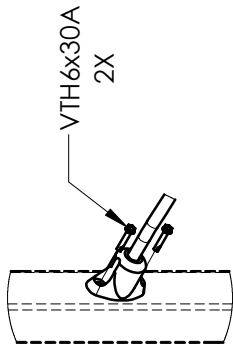
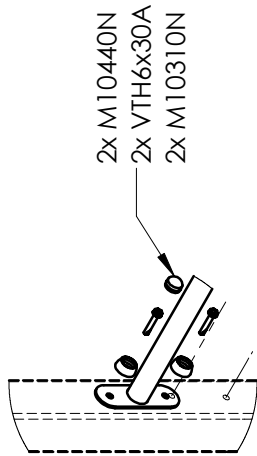

| Réf      | Qté |
|----------|-----|
| L5888    | 2   |
| LGP5850  | 1   |
| M68x68   | 1   |
| M8310N   | 8   |
| M8440N   | 8   |
| RRAV6    | 1   |
| U58203   | 2   |
| VTH6x30A | 16  |

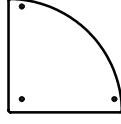
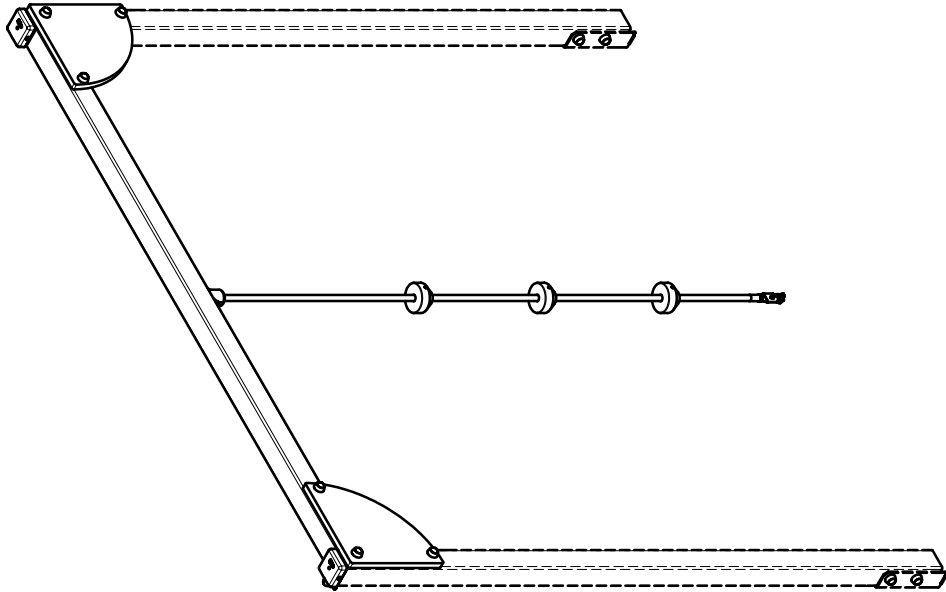

F5878

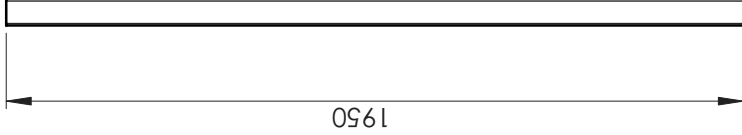

LGP5801

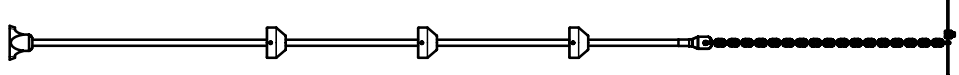

U58202A

| Réf          | Qté |
|--------------|-----|
| F5878        | 2   |
| LGP5801      | 1   |
| M8310N       | 12  |
| M8440N       | 12  |
| P30          | 3   |
| U58202A      | 1   |
| VR8x18       | 3   |
| VTH6x30A     | 8   |
| VTH6x60 AUTO | 6   |

G58206A-M

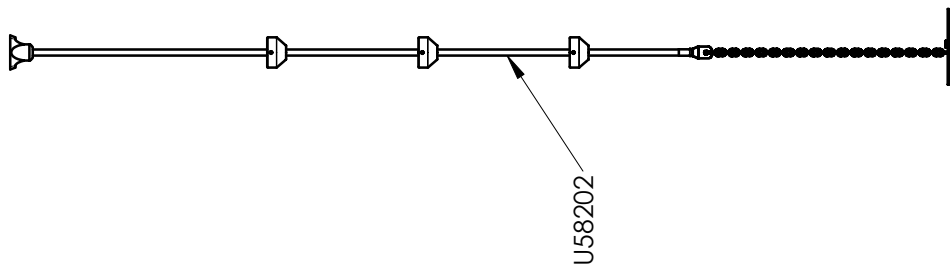

G58206B-M

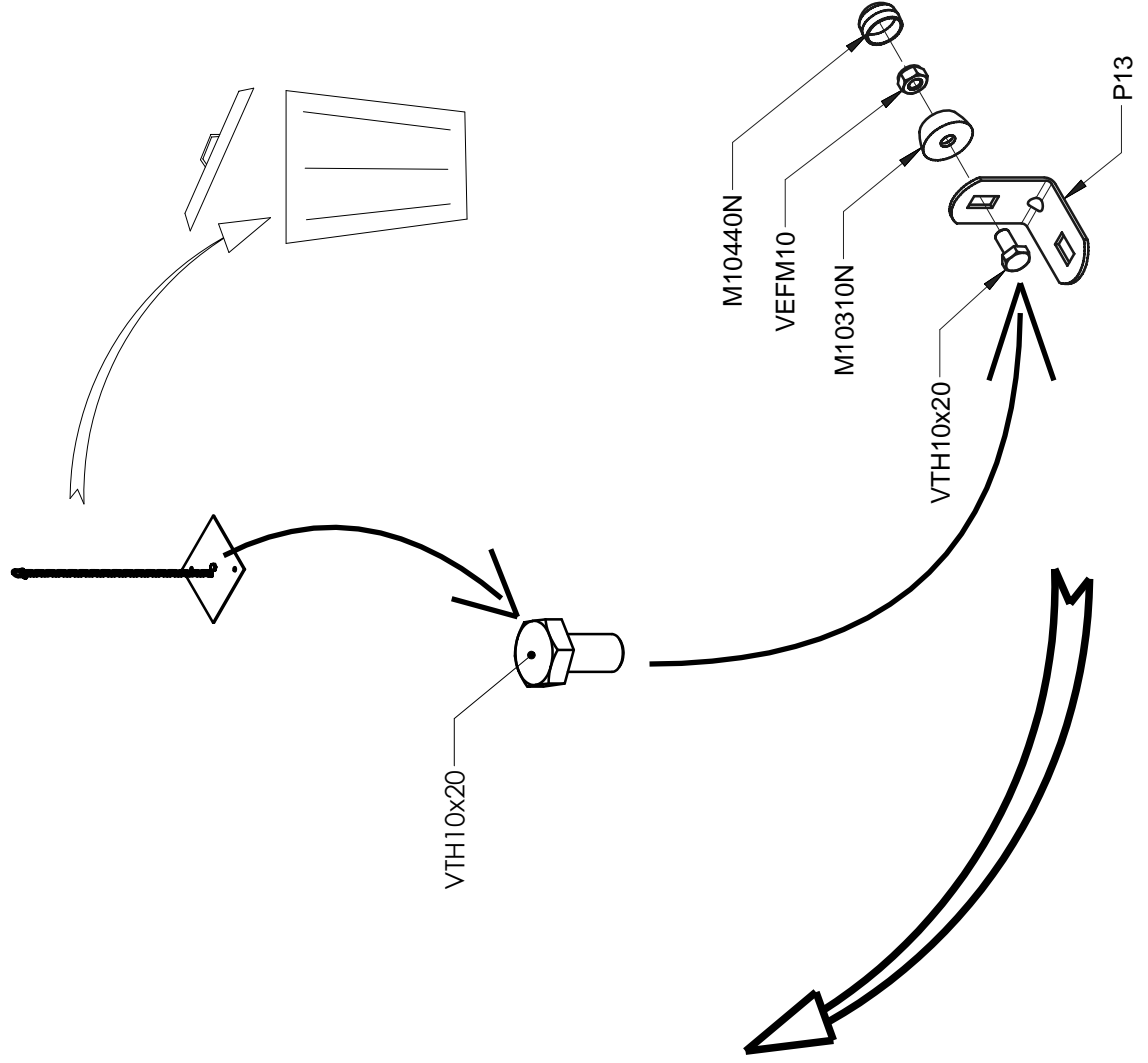
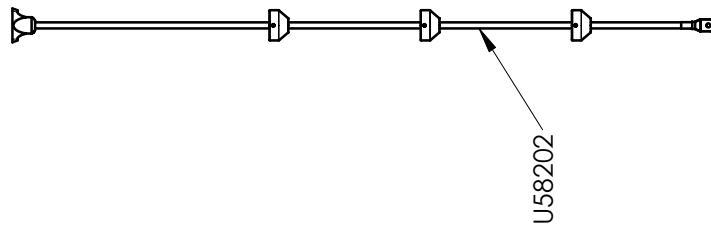



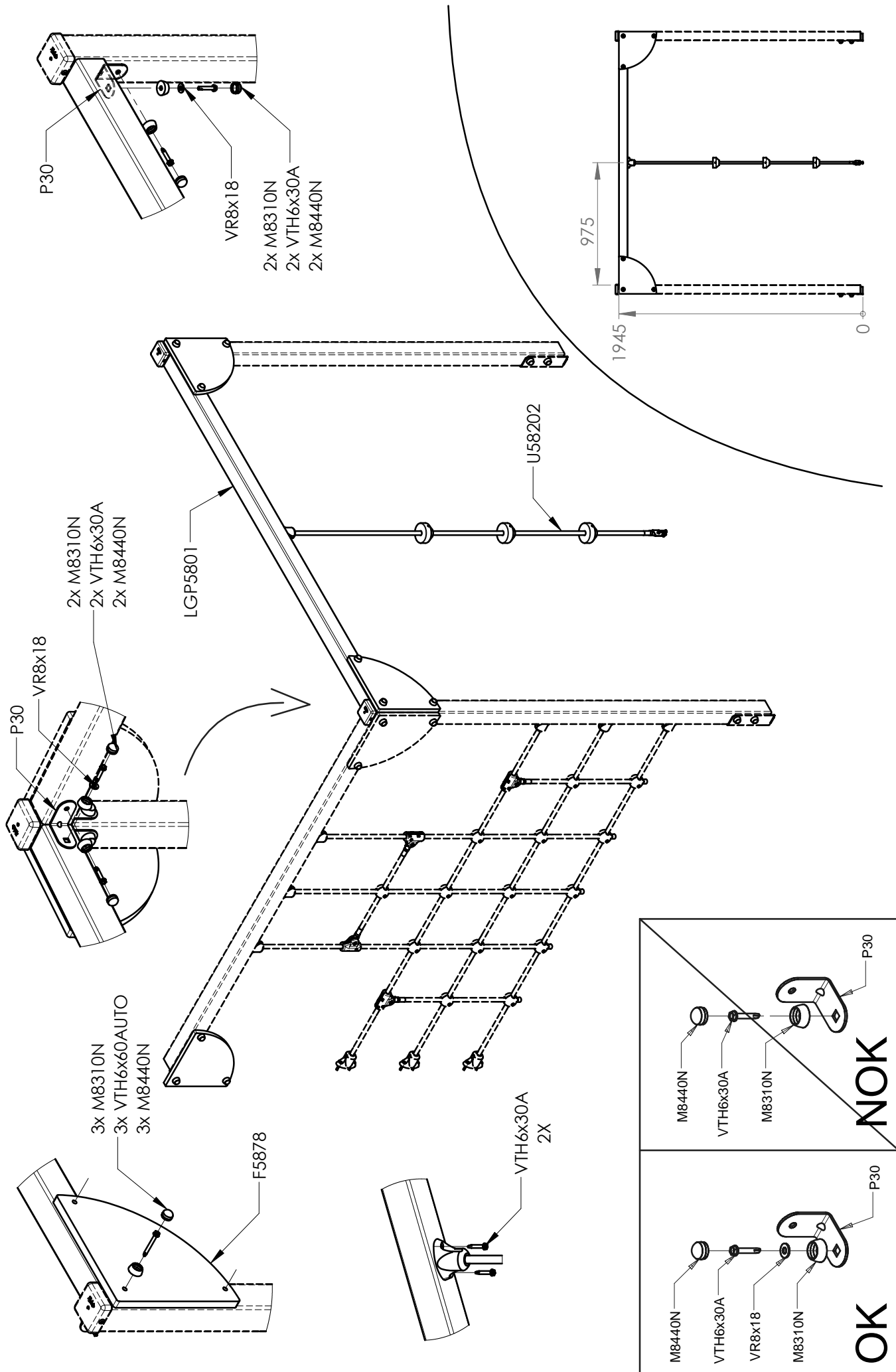

**OK**

**NOK**